

NORTH PIER (NATIONAL GRID)			NORTH PIER (LAT. / LONG.)		
NP1	255632.261E	665931.584N	NP1	55°51.8924'	-4°18.5084'
NP2	255621.354E	665922.807N	NP2	55°51.8875'	-4°18.5185'
NP3	255612.577E	665933.714N	NP3	55°51.8932'	-4°18.5273'
NP4	255623.484E	665942.491N	NP4	55°51.8981'	-4°18.5171'
NP5	255657.334E	665929.807N	NP5	55°51.8920'	-4°18.4843'
NP6	255648.514E	665929.261N	NP6	55°51.8915'	-4°18.4927'
NP7	255619.529E	665905.935N	NP7	55°51.8784'	-4°18.5197'
NP8	255595.705E	665935.539N	NP8	55°51.8939'	-4°18.5435'
NP9	255601.738E	665940.394N	NP9	55°51.8966'	-4°18.5379'
NP10	255604.979E	665960.973N	NP10	55°51.9078'	-4°18.5354'
NP11	255627.438E	665979.047N	NP11	55°51.9179'	-4°18.5145'
NP12	255632.922E	665972.233N	NP12	55°51.9143'	-4°18.5090'
NP13	255654.159E	665982.449N	NP13	55°51.9202'	-4°18.4890'
NP14	255661.128E	665967.757N	NP14	55°51.9124'	-4°18.4819'
NP15	255654.401E	665959.550N	NP15	55°51.9080'	-4°18.4880'
NP16	255657.153E	665953.637N	NP16	55°51.9047'	-4°18.4852'
NP17	255653.701E	665946.413N	NP17	55°51.9008'	-4°18.4883'
NP18	255655.402E	665944.300N	NP18	55°51.8997'	-4°18.4866'
NP19	255647.180E	665942.520N	NP19	55°51.8986'	-4°18.4944'
NP20	255646.630E	665935.980N	NP20	55°51.1895'	-4°18.4947'

AREA 1 (NATIONAL GRID)			AREA 1 (LAT. / LONG.)		
A1-1	255625.249E	665954.178N	A1-1	55°51.9045'	-4°18.5158'
A1-2	255643.914E	665963.123N	A1-2	55°51.9097'	-4°18.5298'
A1-3	255648.059E	665954.217N	A1-3	55°51.9050'	-4°18.4939'
A1-4	255643.884E	665937.038N	A1-4	55°51.8956'	-4°18.5340'
A1-5	255641.815E	665935.698N	A1-5	55°51.8948'	-4°18.4993'
A1-6	255625.102E	665944.332N	A1-6	55°51.8991'	-4°18.5156'

AREA 2 (NATIONAL GRID)			AREA 2 (LAT. / LONG.)		
A2-1	255620.392E	665963.985N	A2-1	55°51.9097'	-4°18.5208'
A2-2	255653.214E	665979.775N	A2-2	55°51.9188'	-4°18.4900'
A2-3	255658.778E	665968.045N	A2-3	55°51.9125'	-4°18.4841'
A2-4	255650.120E	665957.482N	A2-4	55°51.9067'	-4°18.4921'
A2-5	255645.676E	665966.832N	A2-5	55°51.9116'	-4°18.4967'
A2-6	255641.207E	665968.479N	A2-6	55°51.9125'	-4°18.5010'
A2-7	255622.703E	665959.594N	A2-7	55°51.9074'	-4°18.5184'

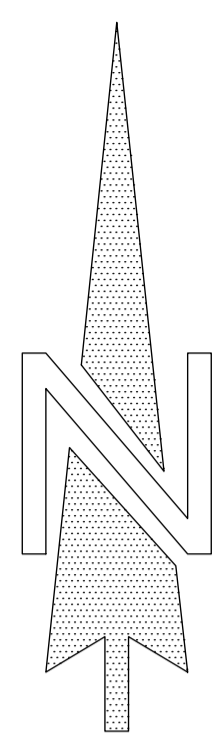

← RIVER CLYDE

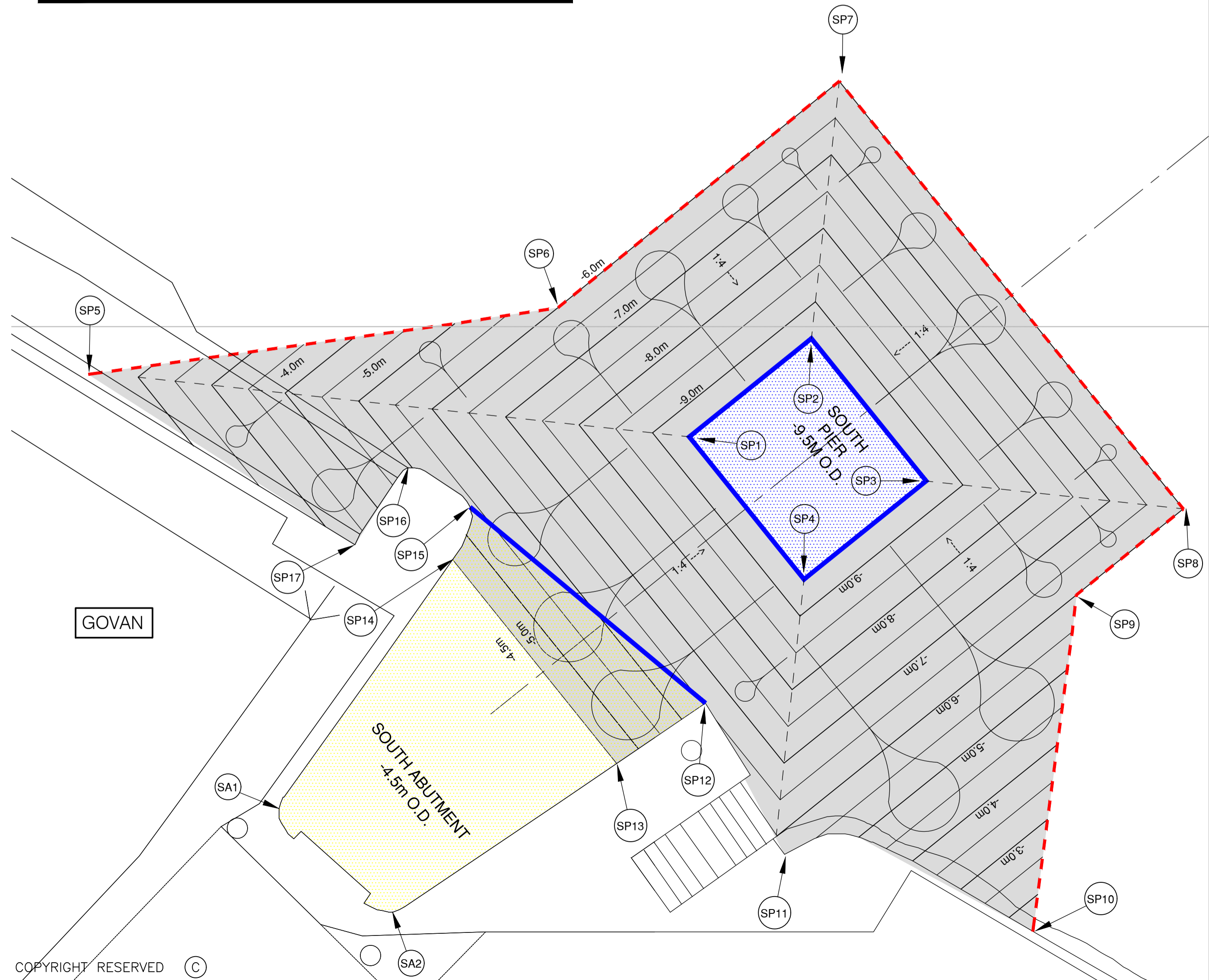
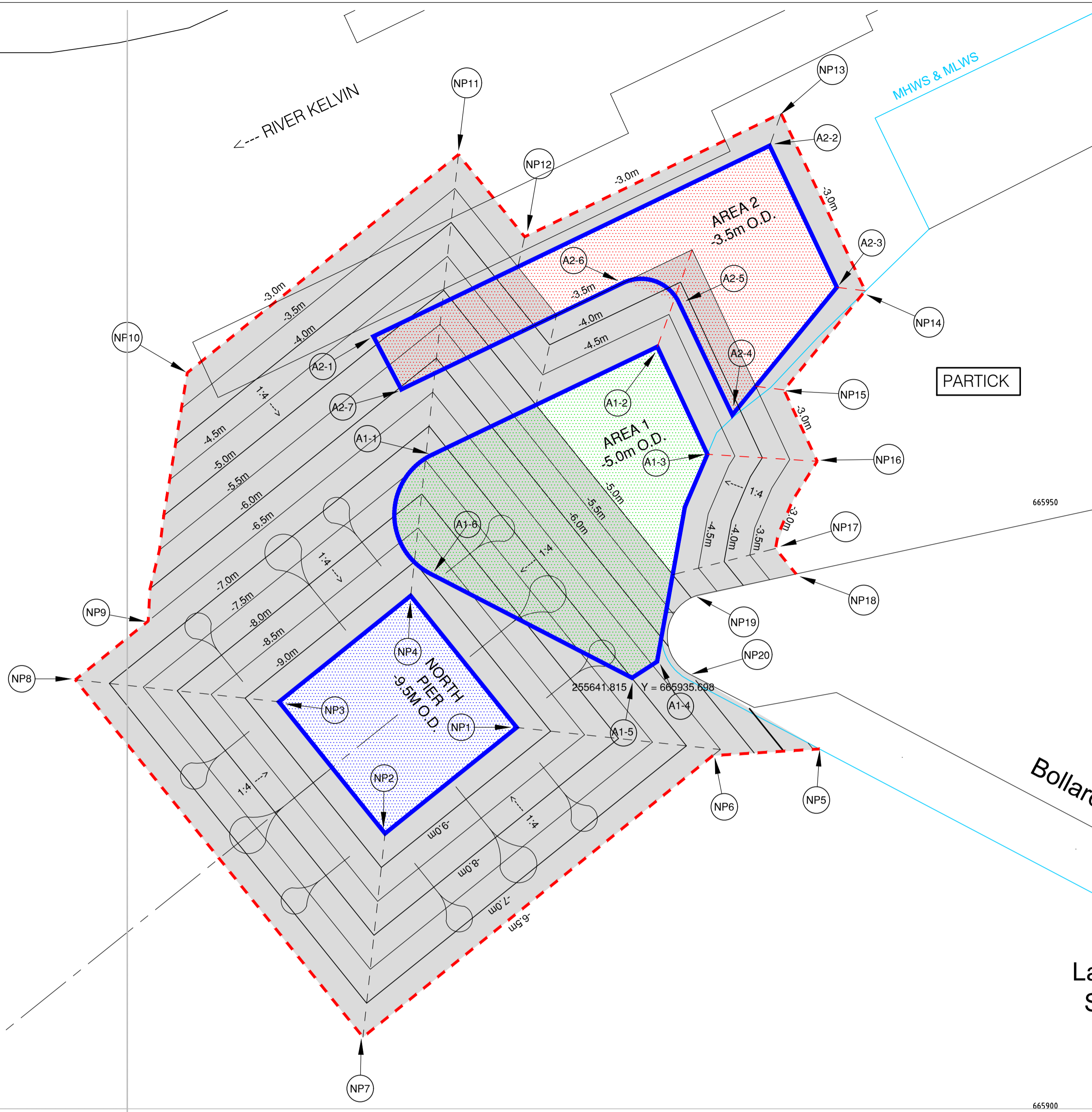

SOUTH PIER (NATIONAL GRID)			SOUTH PIER (LAT. / LONG.)			SOUTH ABUTMENT (NATIONAL GRID)		
SP1	255560.207E	665891.570N	SP1	55°51.8696'	-4°18.5761'	SA1	255528.810E	665863.120N
SP2	255569.556E	665899.093N	SP2	55°51.8738'	-4°18.5674'	SA2	255537.500E	665855.190N
SP3	255578.333E	665888.186N	SP3	55°51.8681'	-4°18.5586'	SP12	255561.440E	665871.190N
SP4	255568.984E	665880.663N	SP4	55°51.8639'	-4°18.5673'	SP15	255543.440E	665886.190N
SP5	255514.222E	665896.352N	SP5	55°51.8713'	-4°18.6203'			
SP6	255550.134E	665901.434N	SP6	55°51.8747'	-4°18.5861'			
SP7	255571.685E	665918.777N	SP7	55°51.8845'	-4°18.5660'			
SP8	255598.017E	665886.057N	SP8	55°51.8673'	-4°18.5397'			
SP9	255589.831E	665879.469N	SP9	55°51.8636'	-4°18.5473'			
SP10	255586.502E	665853.732N	SP10	55°51.8497'	-4°18.5497'			
SP11	255567.500E	665859.620N	SP11	55°51.8525'	-4°18.5681'			
SP12	255561.440E	665871.190N	SP12	55°51.8587'	-4°18.5743'			
SP13	255554.651E	665866.573N	SP13	55°51.8560'	-4°18.5806'			
SP14	255542.096E	665882.174N	SP14	55°51.8642'	-4°18.5931'			
SP15	255543.440E	665886.190N	SP15	55°51.8664'	-4°18.5920'			
SP16	255538.690E	665889.190N	SP16	55°51.8679'	-4°18.5966'			
SP17	255534.620E	665883.310N	SP17	55°51.8647'	-4°18.6003'			

SOUTH ABUTMENT (LAT. / LONG.)		
SA1	55°51.8537'	-4°18.6053'
SA2	55°51.8496'	-4°18.5967'
SP12	55°51.8587'	-4°18.5743'
SP15	55°51.8664'	-4°18.5920'

NOTES

- THIS DRAWING TO BE READ IN CONJUNCTION WITH ALL DRAWINGS IN THE 205030-200 SERIES.
- LEVELS AND CONTOURS SHOWN FOR THE BRIDGE CONSTRUCTION WORKS ARE IN METRES RELATIVE TO ORDNANCE DATUM.

LEGEND

- BRIDGE PIER DREDGED AREA - 9.50m O.D.
- SOUTH ABUTMENT DREDGED AREA - 4.50m O.D.
- AREA 1 DREDGED AREA - 5.0m O.D.
- AREA 2 DREDGED AREA - 3.50m O.D.
- FORMED DREDGED SLOPE 1:4
- DREDGING WORKS BOUNDARY

A	22.4.21	South Abutment setting out reference points (lat/long) revised.	G.B.	G.B.
REV	DATE	REVISION DESCRIPTION	DRN	VER

THIS DRAWING IS COPYRIGHT - DO NOT SCALE FROM THIS DRAWING

Arch Henderson 1919

Civil Engineers
Structural Engineers
Principal Designers
Architects
Geotechnical services
Environmental services

142 St. Vincent Street, Glasgow G2 5LA
Tel: 0141 227 9060 - Fax: 0141 249 9542
www.arch-henderson.co.uk - email: glasgow@arch-henderson.co.uk

Offices in: Aberdeen, Dundee, Falkland Islands, Glasgow, Inverness, Lewick, Southampton, Storness and Thurso

PROJECT :
Glasgow City Council
Govan Partick Bridge

TITLE :
Bridge Site Dredging Layout

DRAWN : G.B.	DATE : 17.4.21	VERIFIED : G.B.	APPROVED : G.B.
SCALE : (A1) 1:250		DRAWING STATUS : Licence Application	

Ordnance Survey Data reproduced under licence
Customer Number 100002501

DO NOT SCALE

DRAWING No: 205050-012

REV: A