

METHOD STATEMENT
FRONT SHEET

Site	Method Statement Ref No
Valleyfield C21252 Seawall Repair	MS-014

	Name	Position	Signature and Date
Prepared By	Lee Barton	Sub Agent	
Approved By	Larry Highton	Site Agent	
Comments:			

	Name	Position	Signature and Date
Amended By (if applicable)			
Approved By			
Reasons for Amendment:			

Background

METHOD STATEMENT

Site: Valleyfield	MS Ref No MS-014
Task: Sea wall repair	
Details of Activity	
Location - Lagoon 5 Section of Seawall	
<p>Potential Hazards</p> <p>Working near water Existing Services Movement of Construction Plant Collision with other plant and equipment Excavation/ slope stability Interaction with vehicles Burst Hydraulic/Oil Hoses Pedestrians Environment Covid 19 – The I & H Brown Covid 19 Management Plan must be read in conjunction with this method statement/risk assessment.</p>	
<p>Temporary Works required: <i>Stockpiles to be inspected daily during construction</i> <i>Excavations to be inspected daily during construction</i></p>	
<p>Procedure</p> <ol style="list-style-type: none"> 1. All persons working onsite shall undergo a full site induction prior to commencement of any operation. All relevant checks will be undertaken to ensure suitable competency cards for the task are in place. 2. Special attention must be brought to the Network rail crossing. Instructions must be followed at all times as per induction and Appendix B. 3. All personnel involved this task will be briefed on the content of this Method Statement and associated risk assessment prior to starting work. 4. They will also ensure the correct PPE is brought to site and worn as per the RA. 5. Operatives must endeavour to take due care and attention at all times. 6. The area for seawall repair will be set out by the I & H Brown site engineer. 7. These areas will then be scanned with a CAT4 and Genny to prove there are no existing services in the areas. If services are found, MS003 Trial Holes & Site Investigation must be followed. 8. A "Permit to break ground" shall be in operation throughout the works, all operatives involved in the task will be required to sign onto the Permit. 9. Pedestrian segregation in the form of walkways will be constructed, using pedestrian crowd barriers to form access from the plant compound area to the welfare cabins. 10. Pedestrian access to the working area will be way 4x4. 	

METHOD STATEMENT

11. Plant operatives must carry out daily plant pre-start checks, which are recorded, to include quick hitch. A copy of these must be kept within the plant or at the work front. Spill kits will be available at the works area.
12. The IHB Foreman will take charge of the task and ensure that the content of this Method Statement is adhered too, and all works will stop and IHB Site Manager will be contacted and consulted before changes to the approved method of working.

Seawall Repair

13. The section of seawall repair has been identified during a site walk around with SPGAL & IHB. The area of the seawall repair is East of the Lagoon 5/Scottish Water sewage works.
14. Marine Scotland and SPEA license must be in place before works can commence.
15. A 'Permit to Work System' will be in place prior to works commencing.
16. The IHB engineer will set out the works area prior to works commencing.
17. Works will only take place during low tide.
18. An excavator will be used to reduce the existing ground in order to reach the toe of the seawall which requires repair.
19. Once the existing ground is reduced the excavator with bucket attachment will place imported rock armour type material into position as set out by the engineer.
20. Care will be taken when placing rock armour.
21. By no means should anyone be standing within the 'safety zone' Appendix C.
22. Delivery of the rock armour type material will be via the main security gate and must abide rules outlined on the TM plan ~250tonnes.
23. By no means will any deliveries be allowed to wait on 'main street' off the B9037. If required, deliveries will wait within the site compound area.
24. All drivers will stop at the rail crossing and ensure it is safe to cross as instructed by the gate man and as per rules outlined in appendix B.
25. Deliveries will then drive over the weigh bridge ensuring tickets for the loads are produced.
26. Deliveries will then continue through the secondary manned gate taking caution when passing the pedestrian right of way footpath and proceed to the works area via the signposted route.
27. Deliveries will further pass a third gate where a gateman will be present. Caution will be taken when passing through the gated access due to the right of way footpath.
28. Imported material will then be deposited close to the works area as advised by the foreman.

METHOD STATEMENT

29. On exiting the delivery drivers will abide by rules 22,23,24,25,26 and return through the wheel wash located in the site compound area.
30. The engineer will check the works to ensure it is within specification.
31. Report all incidents (pollution, flood events) and any other potential hazards to your Supervisor/SPGAL.
32. Work to start when there are no flood warnings in place. flood.sepa.org.uk.
33. Report any incident (at the time it happens) and any actions to resolve the issue. Any incident should be followed up with a written report to SEPA in due course. The pollution hotline number is 0800 807060 24/7/365.

Control Measures

1. Awareness of issues during Site Induction
2. Close IHB Supervisor during work
3. Permit to break ground
4. CPCS/CSCS Cards
5. Spill Kits in plant
6. Correct PPE
7. Dust
8. Covid 19

Other Special Considerations

Covid-19 – All personnel on site will read, understand and work in accordance with the I & H Brown Covid 19 Management Plan.

Resources Involved

Foreman
 Engineer
 Ganger
 Excavator
 Dump truck
 CAT4 and Genny service locator







PPE Required

Safety helmet, safety footwear, high visibility jacket, for all work.

Additional PPE for this activity:

As per risk assessment

METHOD STATEMENT

Information
<p>H & S Instructions to be given</p> <p>All operatives to have received full site induction prior to being briefed on this method statement.</p>
<p>Person in Charge, plus Contact Details</p> <p>  Contracts Manager – David Barr (IHB)  Site Agent – Larry Higton (IHB) Tel:  Sub Agent – Lee Barton (IHB) Tel:  General Foreman – Mick Pretswell  Site Ganger– James Fox (IHB) Tel:  Site Ganger– Donald Williams (IHB)  SHEQ Manager – Andy Manson (IHB) </p>

CONTROL SHEET

<p>Distribution List</p> <p>Personnel involved in task, Site File</p>	
Author:	Date:

Comments received and considered:	
Signed:	Date:



METHOD STATEMENT

Appendix A: Plan of works

Works General Arrangement

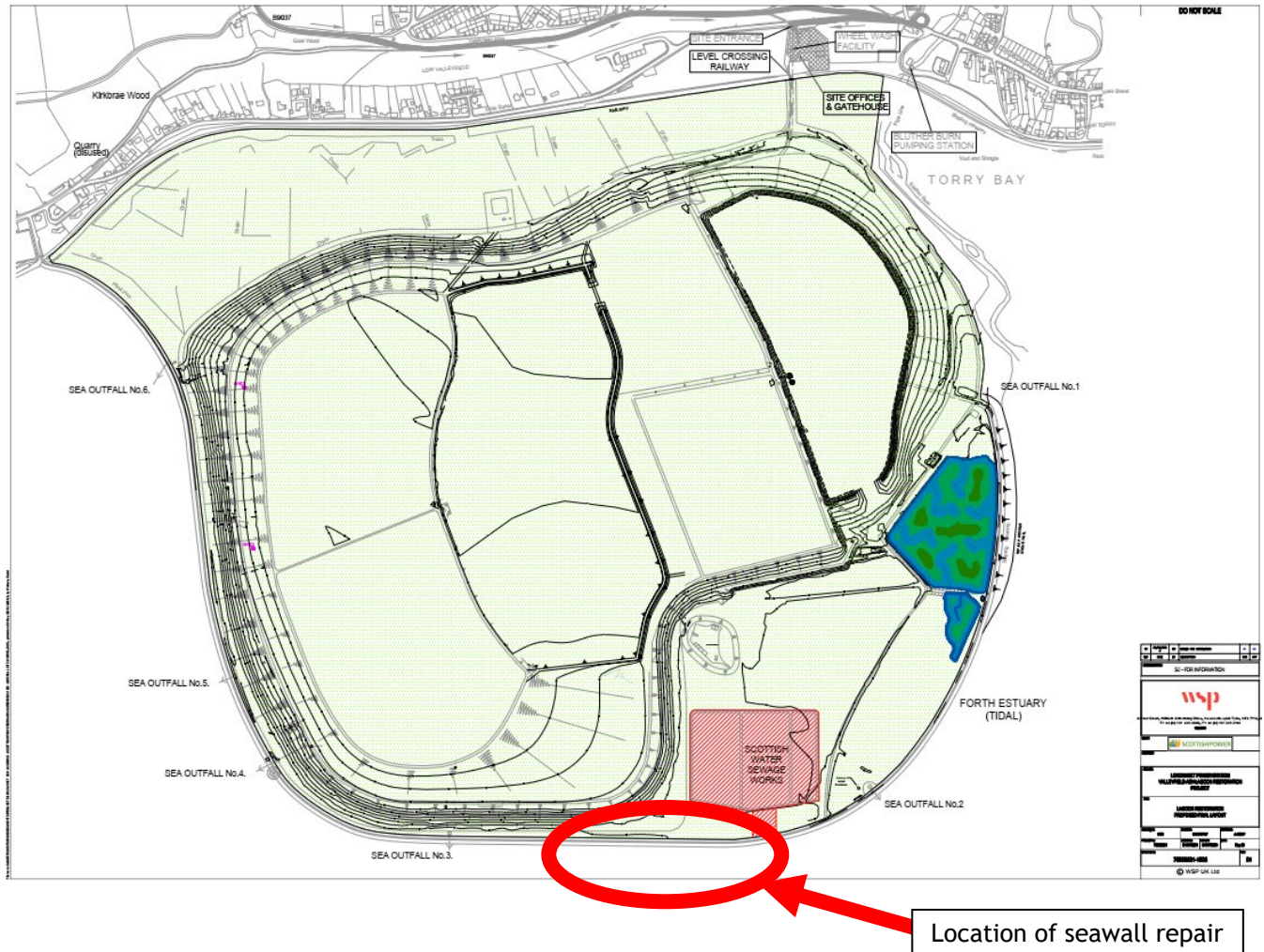

METHOD STATEMENT

Seawall location

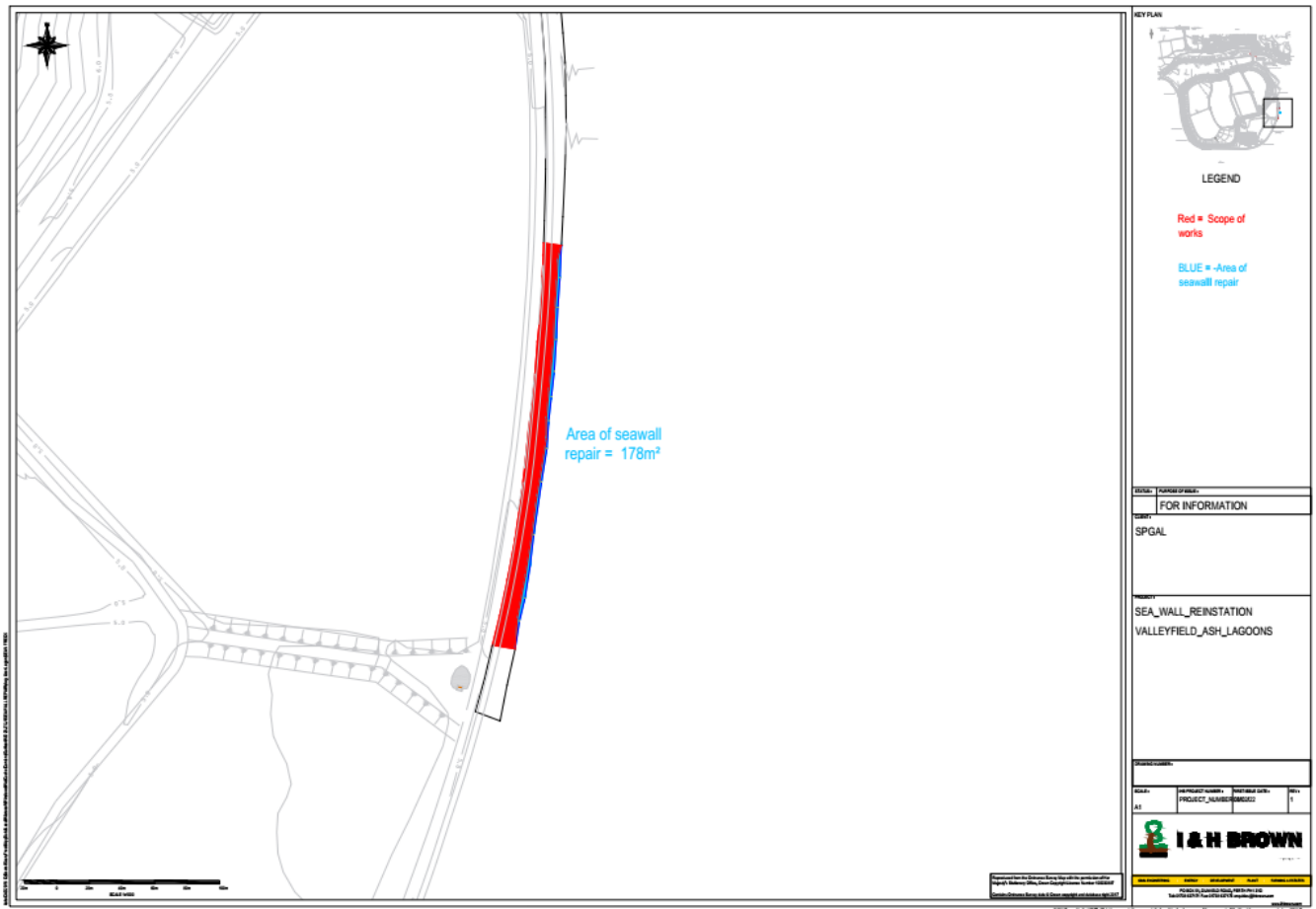



METHOD STATEMENT

Seawall Location





METHOD STATEMENT

Typical section through seawall

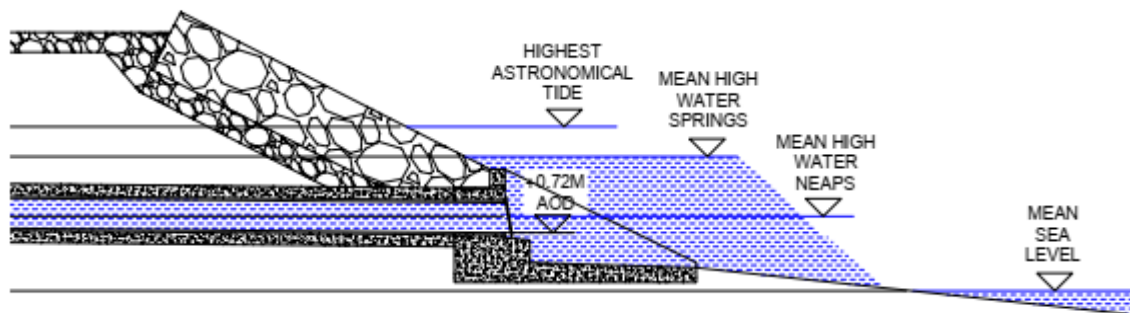

SECTION 1-1
SCALE 1:100

Appendix B: Network rail instructionsNETWORK RAIL**SCOTLAND**

Explanation as to the Temporary Signalbox instructions for
Valleyfield crossing UWC
9miles 60 chains (9M 1320yards)

Explanation

Scottish Power have a requirement to use their Valleyfield UWC from 13th September 2021 for a period of between 12- and 18-months Monday to Friday. This means that there shall be more than 40 lorries traversing the crossing, which would equate to 80 phone calls per day, 450 calls per week to allow access. We have had discussions to mitigate the Signallers workload and to come to a sensible / safe and robust approach to allow this to happen on a line that is rarely used but used none the less.

Along with the instructions to Workstation 6 and Longannet signalbox, there shall be a site induction / briefing for the Nominated Person in charge of the crossing and the method of working required, this shall be completed by the level crossing manager.

All Nominated persons and telephone numbers shall be available daily during days of Operation.

23/08/2021
Page 1 of 1

Authorised by:

Operations Manager Central.

NETWORK RAIL

SCOTLAND

SUPPLEMENTARY TEMPORARY INSTRUCTIONS TO THE SIGNALLERS
AT Longannet signalbox
Valleyfield crossing UWC

Longannet Signalbox

From the 13th September 2021 until further notice the following instructions must be adhered to:

On opening Longannet signalbox the signaller must be instructed by Edinburgh Workstation 6 if there is a "crossing attendant" on duty at Valleyfield UWC.

The following instructions must be adhered to:

Crossing attendant on duty

- There must be confirmation that all road crossings have been stopped / suspended and the gates closed before allowing any train to approach and cross Valleyfield crossing.
- Normal instructions in place for all required crossings.

No crossing attendant on duty

- Normal instructions apply.

METHOD STATEMENT**NETWORK RAIL****SCOTLAND**

SUPPLEMENTARY TEMPORARY INSTRUCTIONS TO THE SIGNALLERS
AT EDINBURGH WS6 IECC
Valleyfield crossing UWC

Edinburgh IECC WS6

From the 13th September 2021 until further notice the following instructions must be adhered to:

Booking on with the Signaller WS6.

- The Crossing attendant situated at Valleyfield crossing shall book on every day that Valleyfield UWC shall be used for vehicles to traverse the crossing- Name and Number must be documented and communications tested.

Longannet Signalbox closed:

- As normal, no trains can travel towards Longannet signalbox.

Longannet signalbox open:

- The signaller at Longannet signalbox MUST be advised on opening that there is a crossing attendant in place at Valleyfield UWC.

Crossing attendant on duty:

- There must be confirmation that all road crossings have been stopped / suspended and the gates closed before allowing any train to approach and cross Valleyfield crossing, Longannet signaller to be advised
- Normal instructions in place for all required crossings.

No crossing attendant on duty:

- Normal instructions apply.

23/08/2021
Page 1 of 1

Authorised by

Operations Manager Central.



METHOD STATEMENT

Appendix C: Excavator safety zone

