

LOCATION PLAN
NTS

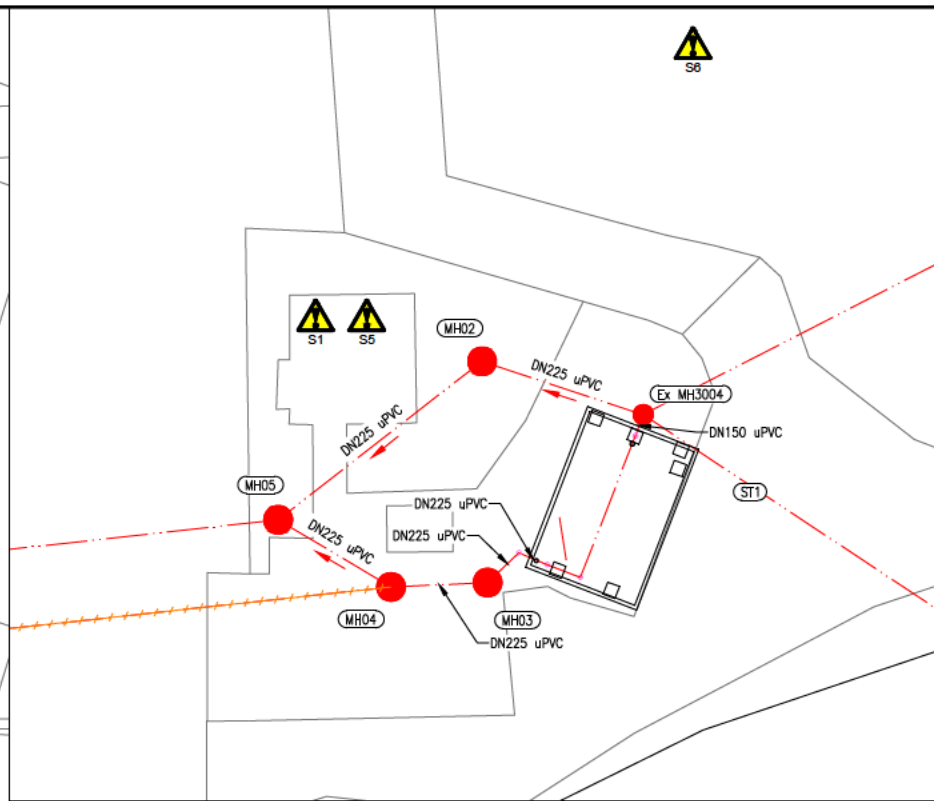

DETAIL 'A' DUNNET WWTW
SCALE 1:200

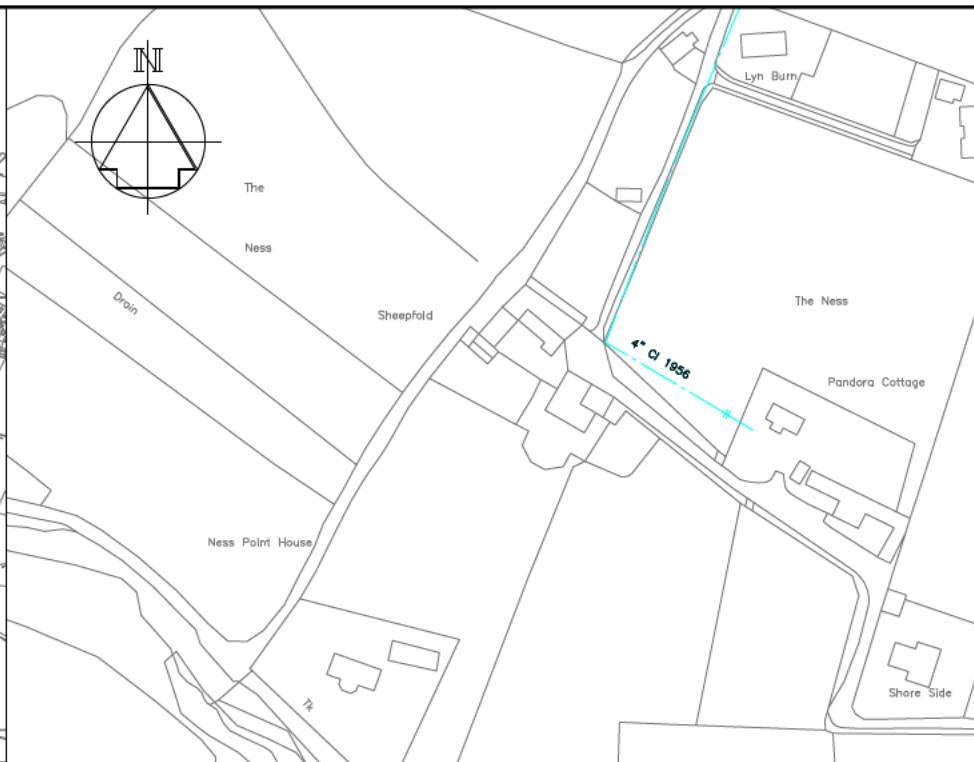
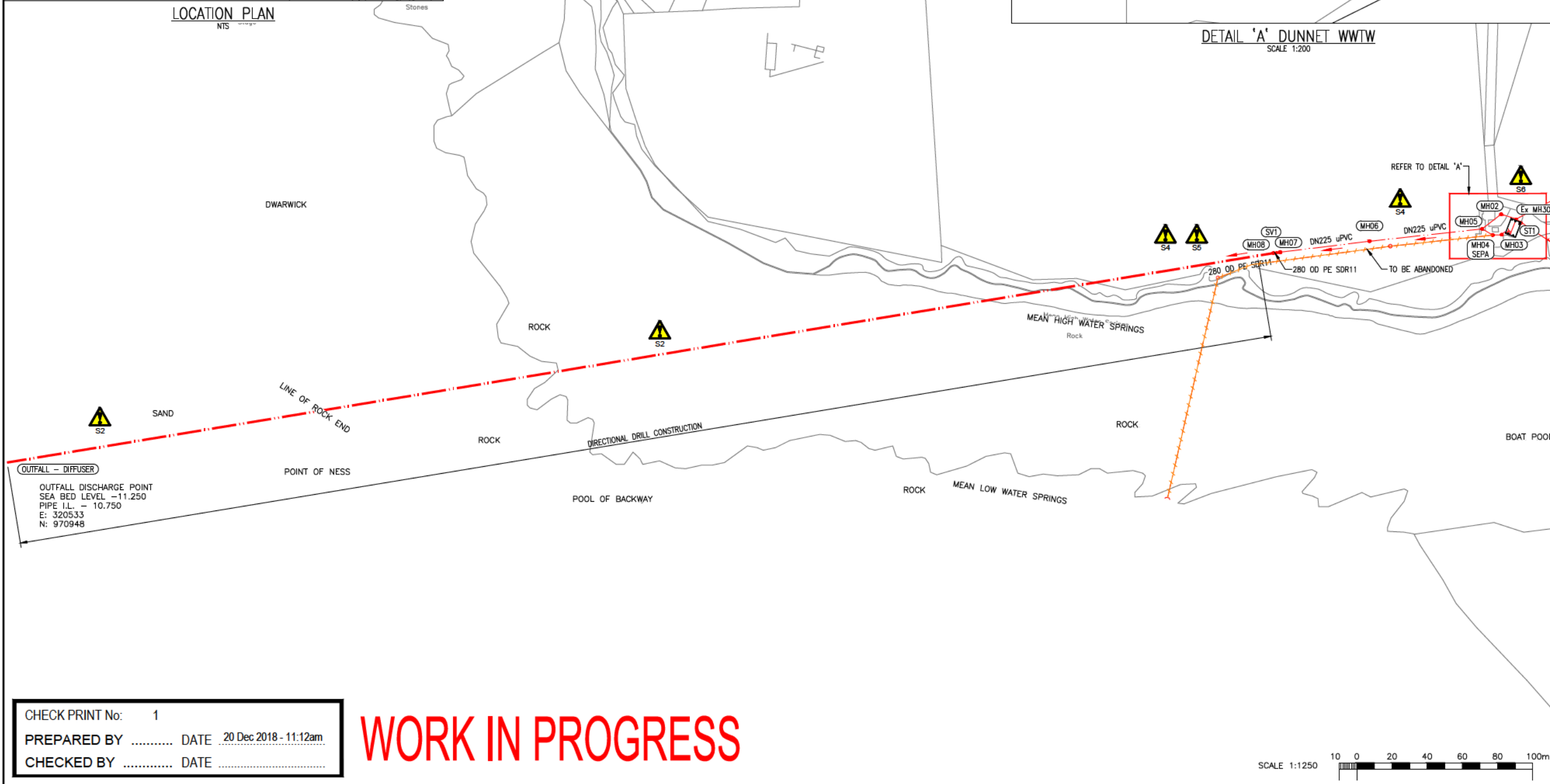

OUTFALL - DIFFUSER
OUTFALL DISCHARGE POINT
SEA BED LEVEL -11.250
PIPE I.L. - 10.750
E: 320533
N: 970948

- NOTES:
1. ALL DIMENSIONS IN METRES AND ALL LEVELS IN METRES AOD, UNLESS NOTED OTHERWISE.
 2. REFER TO STRUCTURAL DESIGN CRITERIA 40400W-REP-99145000 FOR CHAMBER AND DIFFUSER DETAILS.
 3. REFER TO ADDENDUM GEOTECHNICAL DESIGN REPORT 40400-SN-DOC-99141005 FOR GORUND INFORMATION.
 4. SURFACES TO BE REPLACED AS PER EXISTING. REFER TO SCOTTISH WATER FLEXIBLE ROAD DETAIL 5XXXXXXX-CO-DR-04007202 AND TYPICAL FOOTPATH DETAIL 5XXXXXXX-CO-DR-04007204.
 5. ALL CHAMBER COVERS TO BE CLASS D400. MAX WEIGHT FOR SINGLE MAN LIFT: 25kg

LEGEND:
TEXT HERE....

SCOTTISH WATER
HEALTH AND SAFETY INFORMATION

IN ADDITION TO THE HAZARDS NORMALLY ASSOCIATED WITH THE TYPES OF WORK DETAILED ON THIS DRAWING, PLEASE NOTE THE FOLLOWING:

CONSTRUCTION PHASE	RESIDUAL RISK THAT COULD NOT BE OBVIOUS TO A 'COMPETENT CONTRACTOR'	ACTION REQUIRED TO CONTROL THE RESIDUAL RISK
S1 WORKING CLOSE TO UNKNOWN EXISTING SERVICES.		CONTRACTOR TO CONFIRM LINE AND LEVEL OF EXISTING SERVICES PRIOR TO ANY EXCAVATION.
S2 WORKING WITHIN TIDAL AREA.		TIDE LEVELS PROVIDED ON DRAWINGS. CONTRACTOR TO ENSURE SAFE SYSTEM OF WORK IN PLACE PRIOR TO CONSTRUCTION.
S3 WORKING WITHIN PRIVATE LAND (FARMLAND).		CONTRACTOR TO ENSURE SITE SECURITY IN PLACE PRIOR TO CONSTRUCTION.
S4 WORKING CLOSE TO CLIFF EDGE (INJURY TO PERSONNEL).		CONTRACTOR TO ENSURE SUFFICIENT TEMPORARY WORKS AND TRAFFIC MANAGEMENT IN PLACE PRIOR TO CONSTRUCTION.
S5 WATER EGRESS WITHIN EXCAVATION (RISK OF DROWNING, DAMAGE TO EQUIPMENT)		CONTRACTOR TO ENSURE SUFFICIENT TEMPORARY WORKS AND DETERMINED METHOD IN PLACE PRIOR TO CONSTRUCTION.
S6 WORKING WITH HAZARDOUS SUBSTANCE - PERACETIC ACID (INJURY TO PERSONNEL, HARMFUL TO SKIN, EYES AND RESPIRATORY SYSTEM)		CONTRACTOR TO ENSURE SAFE SYSTEM OF WORK AND SPECIFIC METHOD STATEMENT IN PLACE FOR HANDLING PERACETIC ACID.
S7 BENTONITE FRACKOUT DURING DIRECTIONAL DRILL (POLLUTION TO ENVIRONMENT)		CONTRACTOR TO MONITOR BENTONITE RELEASE DURING DIRECTIONAL DRILL TO ENSURE AGREED DISCHARGE VOLUME IS NOT EXCEEDED.
SW OPs ACCESS - HORI, VERT, PEDESTRIAN, VEHICLE/PLANT	POINTS REQUIRING ACCESS:	METHOD OF ACCESS:
MANHOLE CHAMBERS SUB SEA DIFFUSER VALVE	SW OPs HANDLING/LIFTING STRATEGY	METHOD OF HANDLING:
ITEMS REQUIRING HANDLING:	MANHOLE COVERS VALVES BLANK FLANGES	SCOTTISH WATER SAFE SYSTEM OF WORK.

IT IS ASSUMED THAT ALL WORKS WILL BE CARRIED OUT BY A COMPETENT PERSON WORKING, WHERE APPROPRIATE, TO AN APPROVED SAFE SYSTEM OF WORK.

CURRENT ISSUE INFORMATION

DC	FOR INFORMATION	Redacted	20.12.18
DB	FOR INFORMATION		23/03/18
DA	FOR INFORMATION		10/12/15

Rev	Description	Drawn	Chkd	App'd	Date

This drawing is the property of Scottish Water and must not be copied or used for any purpose other than that for which it is supplied without the written consent of Scottish Water.

SCOTTISH WATER
CASTLE HOUSE
6 CASTLE DRIVE
CARNegie CAMPUS
DUNFERMLINE
FIFE KY11 5GG
TEL 0800 0778778

amey-BLACK & VEATCH
Pavilion 2, Buchanan Gate Business Park, Slepps, Glasgow, G33 6FB

Revision No	Drawn By	Checked By	Approved By
Redacted			

Date	18/11/15	18/11/15	10/12/2015	10/12/2015
Scale	1:1250			

Project Title
DUNNET WWTW
PROPOSED OUTFALL EXTENSION & DISCHARGE POINT

Drawing Title
SITE LAYOUT

ELLIPSE EQUIPMENT No. 5000061660
ELLIPSE PLANT No. STW000521/AUTOCODE No. 404000
Drawing No. 404000-WW-DRA-04141100-0C

CHECK PRINT No: 1
PREPARED BY DATE 20 Dec 2018 - 11:12am
CHECKED BY DATE

WORK IN PROGRESS

