



## Marine Licence Application for Construction Projects

Version 1.0

### Marine (Scotland) Act 2010

It is the responsibility of the applicant to obtain any other consents or authorisations that may be required.

Under Section 54 of the Marine (Scotland) Act 2010, all information contained within and provided in support of this application will be placed on a Public Register. There are no national security grounds for application information not going on the Register under the 2010 Act.

#### Public Register

Do you consider that any of the information contained within or provided in support of this application should not be disclosed:

(a) for reasons of national security;

YES  NO

(b) for reasons of confidentiality of commercial or industrial information where such confidentiality is provided by law to protect a legitimate commercial interest?

YES  NO

If YES, to either (a) or (b), please provide full justification as to why all or part of the information you have provided should be withheld.

## WARNING

It is an offence under the Act under which this application is made to fail to disclose information or to provide false or misleading information.

Target duration for determination is 14 weeks. Please note that missing or erroneous information in your application and complications resulting from consultation may result in the application being refused or delayed.

Marine licence applications will not be accepted unless accompanied by a cheque for the correct application fee, or if an invoice is requested, until that invoice is settled. Target timelines for determining applications do not begin until the application fee is paid.

### Declaration

I declare to the best of my knowledge and belief that the information given in this form and related papers is true.

Signature

[Redacted]

Date

31/10/2019

Name in BLOCK LETTERS

PHIN MANASSEH

### Application Check List

Please check that you provide all relevant information in support of your application, including but not limited to the following:

- Completed and signed application form
- Project Drawings
- Maps/Charts
- Co-ordinates of the boundary points of the area of harbour jurisdiction (if you are a statutory harbour authority)  N/A
- Method Statement
- Photographs of the location of the project
- Additional information e.g. consultation correspondence (if applicable)
- Noise Registry – Initial Registration Form (if applicable)  N/A
- Pre-application Report (if applicable)  N/A
- Environmental Statement (if applicable)  N/A
- Payment (if paying by cheque)  N/A

1. Applicant Details

Title: MR      Initials: P.S.      Surname: MANASSEH

Trading Title (if appropriate):

Address: CABIN AT KINMARA  
SALEN  
ACHARACLE, ARGYLL, PH36 4JN

Name of contact (if different):

Telephone No. (inc. dialing code): +44 (0) 7976 738959

Email: phin @ phinmanasseh . com

Statutory Harbour Authority?      YES  NO

If YES, please provide a list of the latitude and longitude co-ordinates (WGS84) of the boundary points of the area of harbour jurisdiction using Appendix 01 Additional Co-ordinates form if necessary.

2. Agent Details (if any)

Title:                      Initials:                      Surname:

Trading Title (if appropriate):

Address:

Name of contact (if different):

Telephone No. (inc. dialing code):

Email:

3. Payment

Enclosed Cheque

Invoice

Contact and address to send invoice to:

Applicant

Agent

Other

If OTHER, please provide contact details:

Title:                      Initials:                      Surname:

Address:

Email:

4. Application Type

Is this application for a new construction site or an existing construction site:

New Site  Existing Site

If an EXISTING SITE, please provide the consent/licence number and expiry date:

Consent/Licence Number	Expiry Date

5. Project Details

(a) Brief description of the project (e.g. construction of a new sea outfall):

CONSTRUCTION OF A NEW SEA OUTFALL FROM NEW SEPTIC TANK.

(b) Total area of the proposed works (in square metres):

25 m<sup>2</sup>

(c) Proposed start date (Target duration for determination of a marine licence application is 14 weeks):

10/02/2020

(d) Proposed completion date:

17/02/2020

(e) Cost of the works seawards of the tidal limit of MHWS:

£ 3251.24

(f) Location:

Outfall pipe from septic tank. High tide to lower than low tide, or agreed with SEPA: NM 68650 63608 to NM 68673 63526 Loch Sunart.



Latitude and Longitude co-ordinates (WGS84) defining the extent of the project (continue on Appendix 01 Additional Co-ordinates form if necessary):

Latitude								Longitude											
		°		.			'N			°		.			'W				
		°		.			'N			°		.			'W				
5	6	°	7	0	.	6	7	6	'N	-	5	°	7	8	.	0	0	6	'W
5	6	°	7	0	.	6	0	6	'N	-	5	°	7	7	.	9	6	1	'W
		°		.					'N			°		.					'W
		°		.					'N			°		.					'W
		°		.					'N			°		.					'W
		°		.					'N			°		.					'W
		°		.					'N			°		.					'W
		°		.					'N			°		.					'W

(g) Is the project located within the jurisdiction of a statutory harbour authority? YES  NO

If YES, please specify statutory harbour authority:

(h) Method statement including schedule of work (continue on separate sheet if necessary):

Outfall pipe 110 mm diameter PVC laid to fall approx: 1 in 50  
 Trench cut into beach approx. 300 mm x 300 mm where necessary  
 with digger, laying pipe in sea gravel as required and  
 at extreme low tide for final portion. Fill from beach  
 used where possible from any dug trench (ie. excavated  
 material re-used.).

(i) Potential impacts the works may have (including details of areas of concern e.g designated conservation and shellfish harvesting areas) and proposed mitigation in response to potential impacts (continue on separate sheet if necessary):

**6. Deposits and/or Removals**

(a) **Permanent** substance(s) or object(s) to be deposited and/or removed from below MHWS (continue on a separate sheet if necessary):

Type of Deposit/Removal	Deposits		Removals	
	Description	Quantity & Dimensions (metric)	Description	Quantity & Dimensions (metric)
Steel/Iron		No.		No.
		Dimensions		Dimensions
		Weight (kg/tonnes)		Weight (kg/tonnes)
Timber		No.		No.
		Dimensions		Dimensions
		Weight (kg/tonnes)		Weight (kg/tonnes)
Concrete		No.		No.
		Dimensions		Dimensions
		Weight (kg/tonnes)		Weight (kg/tonnes)
Plastic/Synthetic		m <sup>2</sup>		m <sup>2</sup>
Clay (< 0.004 mm)		Volume (m <sup>3</sup> )		Volume (m <sup>3</sup> )
		Weight (kg/tonnes)		Weight (kg/tonnes)
Silt (0.004 ≤ Silt < 0.063 mm)		Volume (m <sup>3</sup> )		Volume (m <sup>3</sup> )
		Weight (kg/tonnes)		Weight (kg/tonnes)
Sand (0.063 ≤ Sand < 2.0 mm)		Volume (m <sup>3</sup> )		Volume (m <sup>3</sup> )
		Weight (kg/tonnes)		Weight (kg/tonnes)
Gravel (2.00 ≤ Gravel < 64.0 mm)		Volume (m <sup>3</sup> )		Volume (m <sup>3</sup> )
		Weight (kg/tonnes)		Weight (kg/tonnes)
Cobbles (64.0 ≤ Cobbles < 256.0 mm)		Volume (m <sup>3</sup> )		Volume (m <sup>3</sup> )
		Weight (kg/tonnes)		Weight (kg/tonnes)
Boulders (≥ 256.0 mm)		Volume (m <sup>3</sup> )		Volume (m <sup>3</sup> )
		Weight (kg/tonnes)		Weight (kg/tonnes)

Pipe	83 M	Length (m)		Length (m)
	110 mm $\phi$	External Diameter (cm/m)		External Diameter (cm/m)
Other (please describe below):				

(b) Method of delivery of substance(s) or object(s):

Dumper + digger for 110 mm  $\phi$  PVC pipe laying

(c) For work involving salt marsh feeding, beach replenishment or land reclamation please provide the following information relating to the substance(s) or object(s) to be deposited:

Quantity (tonnes):

tonnes

Nature of substance(s) or object(s) (e.g. sand, silt, gravel etc.):

Source (if sea dredged state location of origin)

Particle size:

Have the substance(s) or object(s) been chemically analysed?  
If YES, please include the analysis data with your application

YES  NO

(d) Temporary substance(s) or object(s) to be deposited below MHWS (continue on a separate sheet if necessary):

Type of Deposit	Description	Quantity & Dimensions (metric)
Steel/Iron		No.
		Dimensions
		Weight (kg/tonnes)
Timber		No.
		Dimensions
		Weight (kg/tonnes)



Concrete		No.
		Dimensions
		Weight (kg/tonnes)
Plastic/Synthetic		m <sup>2</sup>
		Volume (m <sup>3</sup> )
Clay ( $< 0.004$ mm)		Weight (kg/tonnes)
		Volume (m <sup>3</sup> )
Silt ( $0.004 \leq \text{Silt} < 0.063$ mm)		Weight (kg/tonnes)
		Volume (m <sup>3</sup> )
Sand ( $0.063 \leq \text{Sand} < 2.0$ mm)		Weight (kg/tonnes)
		Volume (m <sup>3</sup> )
Gravel ( $2.00 \leq \text{Gravel} < 64.0$ mm)		Weight (kg/tonnes)
		Volume (m <sup>3</sup> )
Cobbles ( $64.0 \leq \text{Cobbles} < 256.0$ mm)		Weight (kg/tonnes)
		Volume (m <sup>3</sup> )
Boulders ( $\geq 256.0$ mm)		Weight (kg/tonnes)
		Volume (m <sup>3</sup> )
Pipe		Length (m)
		External Diameter (cm/m)
Other (please describe below):		

**7. Disposal of Dredged Substance(s) or Object(s) at Sea**

(a) Do you intend to apply for a marine licence for sea disposal of dredged substance(s) or object(s) as part of the project?

YES  NO

If YES, please specify nature of substance(s) or object(s) (e.g sand, gravel, silt, clay, rock etc.):

(b) Quantity of substance(s) or object(s) (wet tonnes):

wet tonnes

**A separate marine licence application will be required to be submitted for sea disposal.**



**8. Noise Monitoring**

Will loud, low to mid frequency (10Hz to 10kHz) impulsive noise be produced by the project?

YES  NO

If YES, which please indicate the noise generating activities and sound frequencies:

Noise Generating Activity	Sound Frequency (Hertz)
Use of Explosives	
Use of Accoustic Deterrent Devices	
Piling	
Other (please describe below):	

If you have ticked YES, please complete the Noise Registry – Initial Registration form located at: <http://www.scotland.gov.uk/Topics/marine/science/MSInteractive/Themes/noise-reduction>

**Marine licence applications will not be accepted until this form has been completed and submitted.**

**9. Statutory Consenting Powers**

Do you, or (if appropriate) your client, have statutory powers to consent any aspect of this project?

**10. Scotland's National Marine Plan**

Have you considered the application with reference to Scotland's National Marine Plan?

YES  NO

If YES, provide details of considerations made with reference to the policies, including but not limited to General Policies 7 and 13 (GEN 7 and GEN 13), that have been considered:

GEN 7 To ensure the outflow pipe does not detract from people's enjoyment of the coastal and marine environment, it will be below sea bed/beach for most of its length.

GEN 8/ GEN 12 Outflow pipe has a one way valve to ensure correct operation of the septic tank by protecting it from flooding. This in turn aids water quality.

GEN 13 The septic tank has no electrical mechanical parts and therefore makes no noise

GEN 16 The proposal is aligned with Highland Council as it has full planning permission. It is also approved in principle subject to approval of the current application with SEPA where pre-application advice has been received.

If NO, please provide an explanation of why you haven't considered the National Marine Plan?

**11. Pre-Application Consultation**

Is the application subject to pre-application consultation, under The Marine Licensing (Pre-application Consultation) (Scotland) Regulations 2013?

YES  NO

If YES, please indicate the date of the public notice for the pre-application consultation event and the type of consultation event held (a copy of the public notice must be supplied with this application):

Event Type	Date

**12. Consultation**

List all bodies you have consulted and provide copies of correspondence:

① Highland Council Planning Permission 14/01061/FUL  
② SEPA : application submitted 18 October 2019 after pre-application advice (see email attached.)  
③ Marine Scotland : spoke with Hamish Wright, Marine Licensing support officer for assistance filling out form.

**13. Environmental Assessment**

(a) Does the project fall under Annex I or II of the EIA Directive?

Annex I

Annex II

Neither

If ANNEX I or ANNEX II, please provide the screening opinion issued to you in relation to the project.

(b) Has an EIA been undertaken:

for the marine licence application to which this application relates  
for any other EIA regulator (e.g local authority)

YES  NO   
YES  NO

**14. Associated Works**

Provide details of other related marine projects, including reference/licence numbers (if applicable):

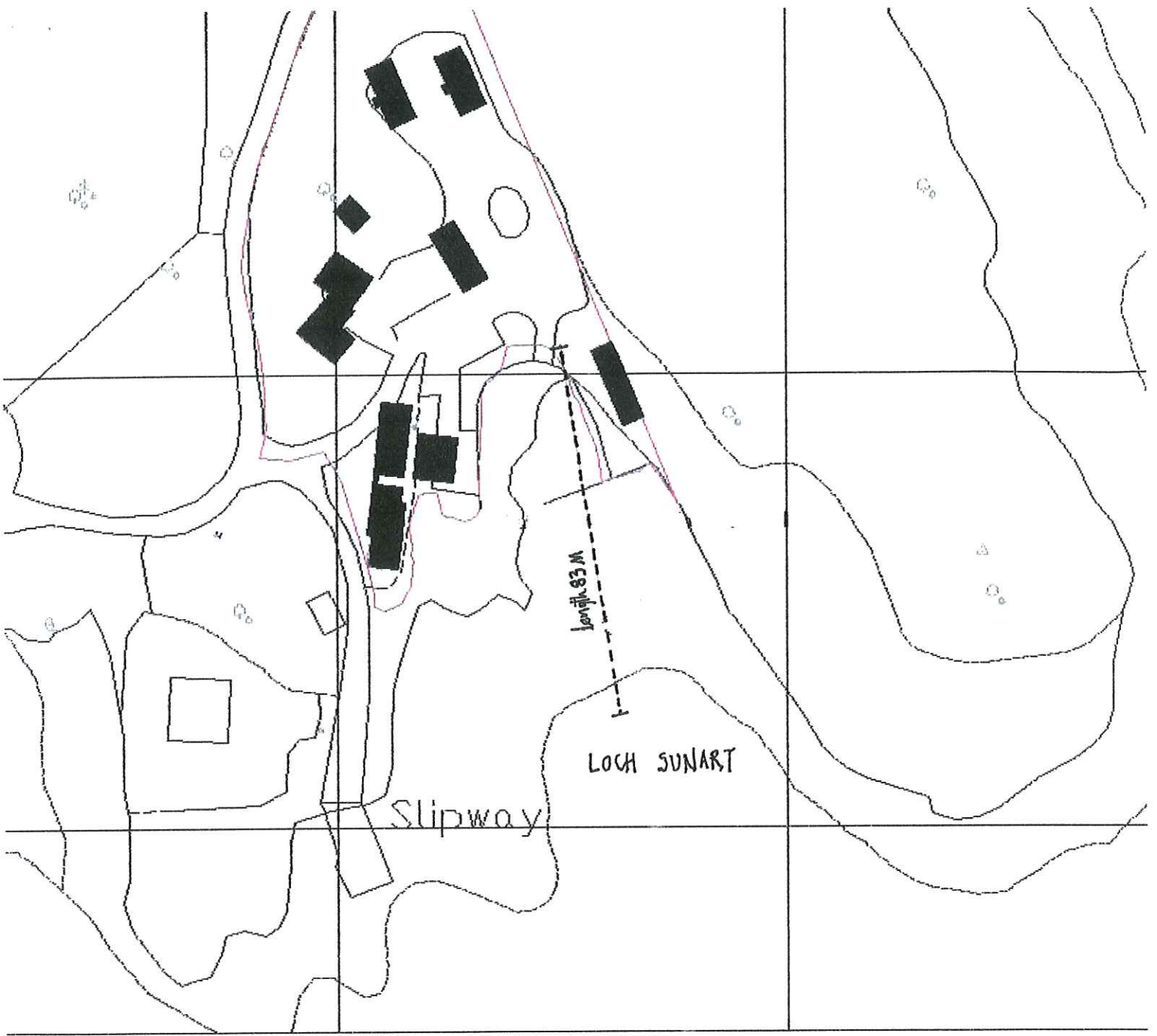

886

887

CABIN AT KINMARA  
 SALEN  
 ACHARACLE  
 PH36 4JN

Extract from  
 Planning Permission  
 OS location plan

PROPOSED position + length of  
 110mm Ø outflow pipe  
 for septic tank.

PHIN MANASSEH m 07976 738959

31 October 2019 1:1250 proposed location plan

email: phin@phinmanasseh.com





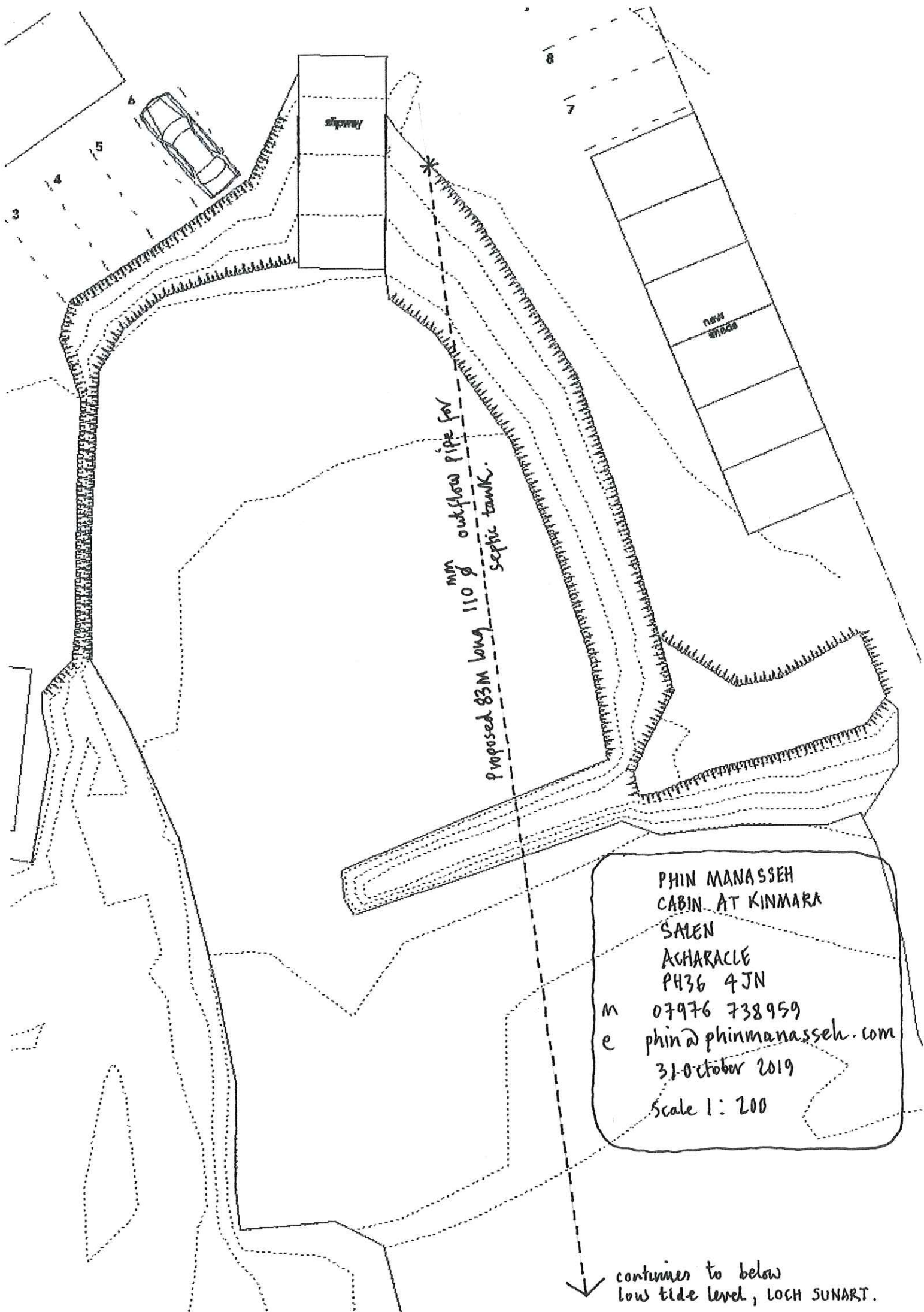

proposed 83M long 110mm outflow pipe to septic tank

PHIN MANASSEH  
 CABIN AT KINMARA  
 SALEN  
 ACHARACLE  
 PH36 4JN  
 M 07976 738959  
 e phin@phinmanasseh.com  
 31 October 2019  
 Scale 1:200

continues to below  
 low tide level, LOCH SUNART.

31 October 2019

Site photos  
for PROPOSED outfall  
110mm  $\phi$  pipe from  
new septic tank.

CABIN AT KINMARA  
SALEN  
ACHARACLE  
PH36 4JN

PHIN MANASSEH M 07976 738959  
e phin@phinmanasseh.com



SITE PHOTO showing shingle beach.



SITE PHOTO from bottom of existing slipway  
looking south to Loch Sunart.



**Subject:** RE: [FWD: Re your SEPA enquiry for foul drainage requirements at Sunart Sea Farm]  
**From:** "Tyas, Jamie" <jamie.tyas@sepa.org.uk>  
**Date:** Thu, Oct 17, 2019 4:04 pm  
**To:** "phin@phinmanasseh.com" <phin@phinmanasseh.com>

Good afternoon Phin,

Thank you for popping into the office today, it was a pleasure to meet you.

I have just tweaked the NGR for the discharge location into Loch Sunart to NM 68673 63526. As we discussed earlier, this will just make sure the outfall is submerged at all times to aid dispersion. I forgot to mention earlier but engineering works below the Mean High Water Spring such as the construction of the outfall itself may require a licence from Marine Scotland. It is worth having a quick chat with them to see if this is necessary. They can be contacted on **0300 244 5046**.

I have had a quick check of septic tank distances for you. The tank should be situated at least 10m away from a watercourse/coastal water. The document in the link below provides details of all the necessary distances: [https://www.highland.gov.uk/downloads/file/1365/septic\\_tank\\_and\\_soakaway\\_systems\\_guidance\\_notes\\_-\\_october\\_2003](https://www.highland.gov.uk/downloads/file/1365/septic_tank_and_soakaway_systems_guidance_notes_-_october_2003)

We will need a NGR for the sampling chamber, this is usually just after the septic tank. The NGR can just be put into section 1.3.3

If you require any further assistance with the application, do not hesitate to get in contact. Otherwise I look forward to meeting you again when you bring the application in.

Kind regards,

**Jamie Tyas**  
Environment Protection Officer

**Scottish Environment Protection Agency**

Fort William Office  
Carr's Corner Industrial Estate  
Lochybridge  
Fort William  
PH33 6TL  
T: 01397 704426 Ext:2381 E: [jamie.tyas@sepa.org.uk](mailto:jamie.tyas@sepa.org.uk)

SAVE PAPER - Please do not print this e-mail unless absolutely necessary

The information contained in this email and any attachments may be confidential and is intended solely for the use of the intended recipients. Access, copying or re-use of the information in it by any other is not authorised. If you are not the intended recipient please notify us immediately by return email to <mailto:postmaster@sepa.org.uk>

Registered office: Strathallan House, Castle Business Park, Stirling FK9 4TZ. Under the Regulation of Investigatory Powers Act 2000, the email system at SEPA may be subject to monitoring from time to time.

Dh'fhaodadh gum bi am fiosrachadh sa phost-d seo agus ceanglachan sam bith a tha na chois dìomhair, agus cha bu chòir am fiosrachadh a bhith air a chleachdadh le neach sam bith ach an luchd-faighinn a bha còir am fiosrachadh fhaighinn. Chan fhaod neach sam bith eile cothrom fhaighinn air an fhiosrachadh a tha sa phost-d no a tha an cois a' phuist-d, chan fhaod iad lethbhreac a dhèanamh dheth no a chleachdadh a-rithist. Mura h-ann dhuibhse a tha am post-d seo, feuch gun inns sibh dhuinn sa bhad le bhith cur post-d gu [postmaster@sepa.org.uk](mailto:postmaster@sepa.org.uk)  
Oifis chlàraichte: Taigh Srath Alain, Pàirc Gnothachais a' Chaisteil, Sruighlea FK9 4TZ. Fo Achd Riaghladh nan Cumhachdan Rannsachaidh 2000, dh'fhaodadh gun tèid an siostam puist-d aig SEPA a sgrùdadh bho àm gu àm.

**From:** phin@phinmanasseh.com <phin@phinmanasseh.com>  
**Sent:** 11 October 2019 17:11  
**To:** Tyas, Jamie <jamie.tyas@sepa.org.uk>  
**Subject:** [FWD: Re your SEPA enquiry for foul drainage requirements at Sunart Sea Farm]