

Scale 1:50

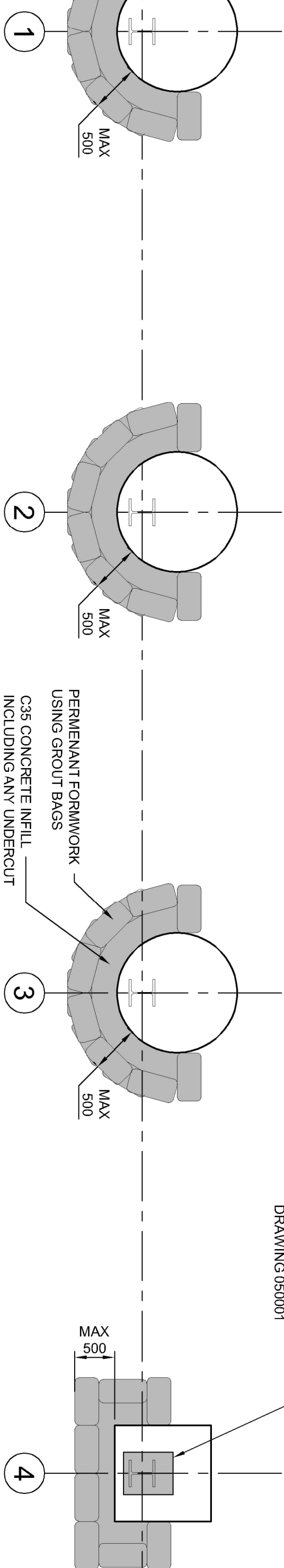

Scale 1:50

- REFER TO SPECIFICATION BUHO-ACM-XX.XX-SP-MT-010007

- REFER TO SPECIFICATION BUJO-AQM-XX-XX-SP-MIT-01 0001
- ALL CONCRETE TO BE MINIMUM GRADE C30
- AGGREGATE SIZE TO BE 10-20mm
- ALL REINFORCEMENT BARS TO BE TO BS 4449
- CONCRETE WILL BE LAID UNDERWATER AND REQUIRE USE OF AN ANTI-WASHOUT ADMIXTURE.

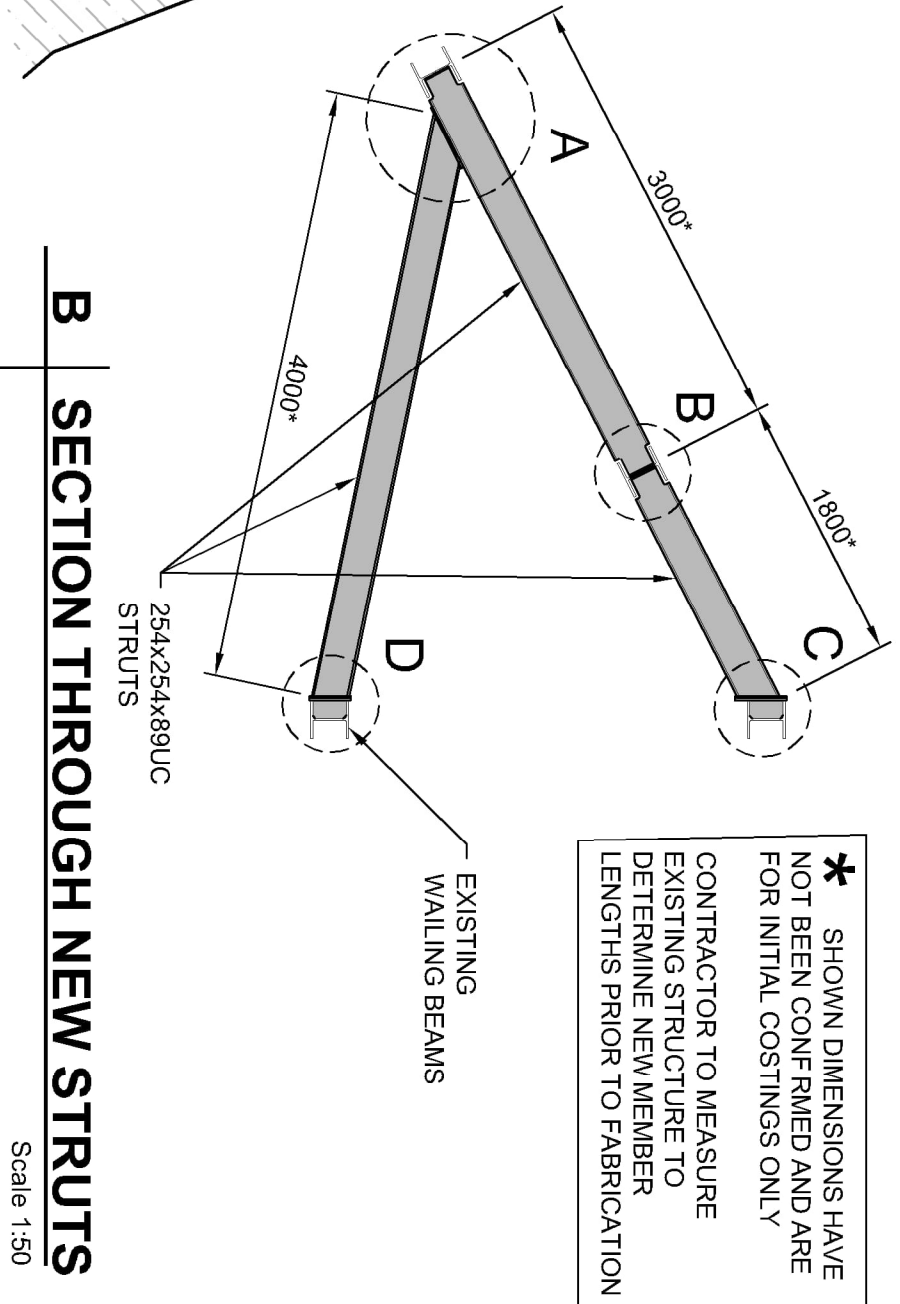

Scale 1:50

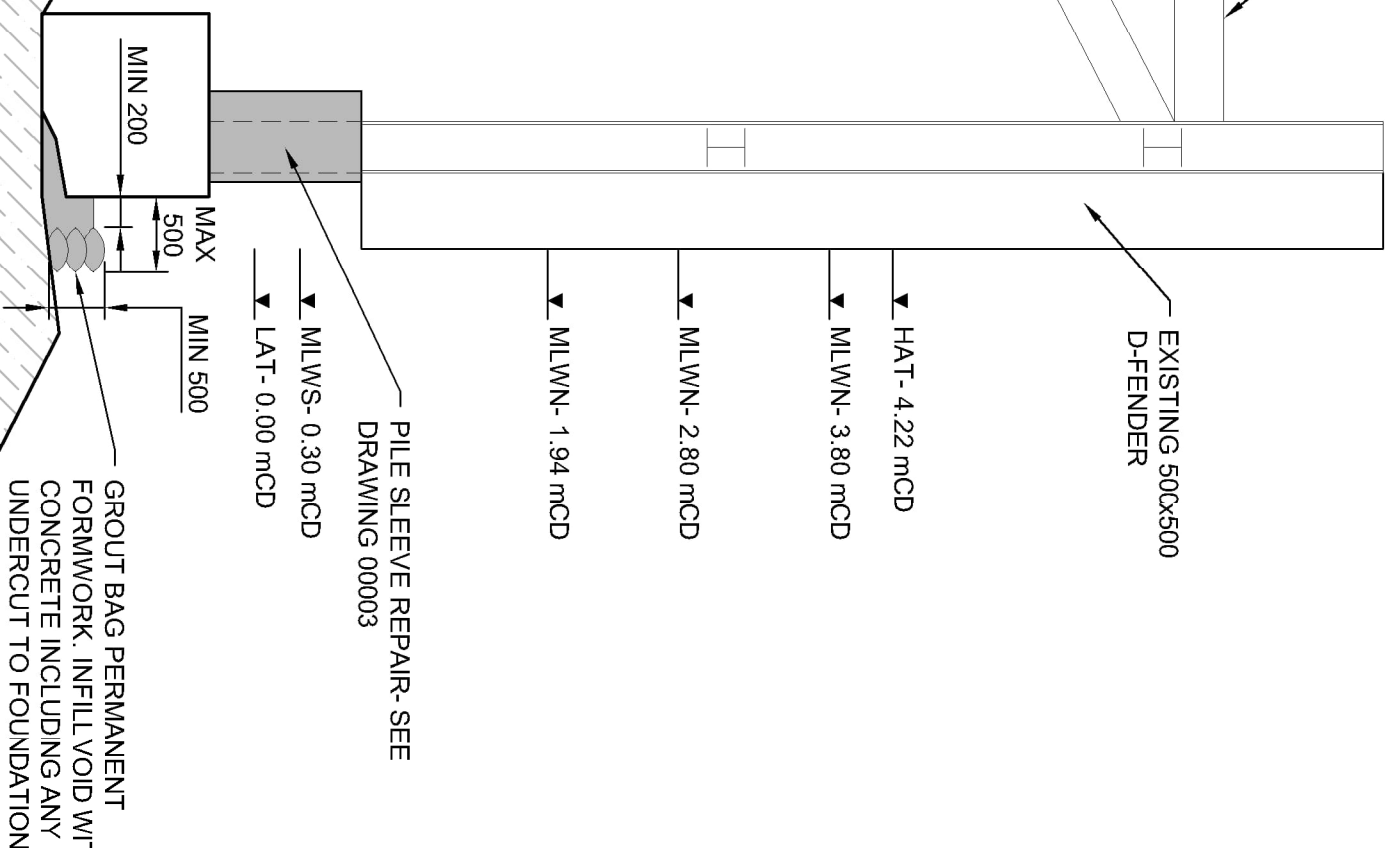

1. DO NOT SCALE FROM THIS DRAWING. WORK TO FIGURED DIMENSIONS ONLY. IF IN DOUBT ASK.
2. THIS DRG TO BE READ IN CONJUNCTION WITH:

AECOM
7th Floor, Aurora
120 Bothwell Street
Glasgow, G2 7JS
T:0141 248 0300
www.aecom.com

PROJECT

**BULLHOLE BERTH
IMPROVEMENTS**

CALEDONIAN
MARITIME ASSETS
LTD

CONSULTANT

AECOM
7th Floor, Aurora
120 Bothwell Street
Glasgow, G2 7JS
T:0141 248 0300
www.aecom.com

NOTES

1. DO NOT SCALE FROM THIS DRAWING. WORK TO FIGURED DIMENSIONS ONLY. IF IN DOUBT ASK THIS DRG. TO BE READ IN CONJUNCTION WITH: THE SPECIFICATION
2. SURVEY AND INTERPRETATIVE REPORTS
3. HEALTH AND SAFETY HAZARD REGISTER
4. RECORD DRAWINGS
5. ALL DIMENSIONS ARE IN MILLIMETRES UNLESS OTHERWISE NOTED.
6. ALL LEVELS ARE IN METRES TO CHART DATUM.
7. CHART DATUM AT HAMMORPHY IS 1.82m BELOW ORDINANCE DATUM (NEWLYN).
8. ANY DISCREPANCIES TO BE REFERRED TO THE SUPERVISOR BEFORE WORK COMMENCES.
9. INFORMATION TO CONFIRM ALL SURVEY INFORMATION ON SITE BEFORE STARTING ANY WORK.
10. CONTRACTOR MAY PROPOSE EQUIVALENT ALTERNATIVES FOR THE ACCEPTANCE OF THE SUPERVISOR.

ISSUE/REVISION

P02	25/10/22	Fender works removed
P01	17/08/22	For Client Comment
IR	DATE	DESCRIPTION

ISSUE PURPOSE / SUITABILITY	SUITABLE FOR INFORMATION	KEY PLAN
-----------------------------	--------------------------	----------

PROJECT NUMBER

049/040

GENERAL ARRANGEMENT PLAN AND SECTION

SHEET NUMBER