

- ALL DIMENSIONS IN METRES UNLESS OTHERWISE NOTED. DO NOT SCALE.
- ALL LEVELS IN METRES AND REDUCED TO CHART DATUM UNLESS OTHERWISE NOTED.
- THIS DRAWING TO BE READ IN CONJUNCTION WITH LISTED REFERENCE DRAWINGS:  
 UHRD-ACM-ZZ-GE-MT-10112,  
 UHRD-ACM-ZZ-GE-MT-10113,  
 UHRD-ACM-ZZ-GE-MT-10114,  
 UHRD-ACM-ZZ-GE-MT-10116.
- CONTOURS HAVE BEEN GENERATED FROM ASPECT BATHYMETRIC SURVEY CARRIED OUT 14/12/2017 AND TOPOGRAPHIC SURVEY CARRIED OUT BY PROPERTY & LAND SURVEYS (HLS) LTD ON 09/02/2017.
- GROUND INVESTIGATION INFORMATION HAS BEEN GENERATED FROM INVESTIGATION CARRIED OUT BY HOLEQUEST BETWEEN 04/07/2017 - 01/08/2017.
- DS03, DS04 AND DS05 IS GENERATED FROM GROUND INVESTIGATION INFORMATION CARRIED OUT BY ASPECT SURVEYS 2nd & 3rd APRIL 2018.
- ALL COORDINATES ARE IN WGS 1984 GEOGRAPHICAL SYSTEM. DEGREES DECIMAL MINUTES.
- THIS DRAWING SHALL BE READ IN CONJUNCTION WITH MARINE SCOTLAND'S PRE DISPOSAL RESULTS FORM.

**FOR INFORMATION ONLY**

**ISSUE/REVISION**

NO	DATE	DESCRIPTION
P01	22/02/19	First Issue
I/R	DATE	DESCRIPTION

**PROJECT NUMBER**  
 60536743

**SHEET TITLE**  
 MARINE LICENCE  
 DREDGE SAMPLE LOCATIONS  
 SETTING OUT  
 PLAN

**SHEET NUMBER**  
 UHRD-ACM-ZZ-GE-DR-MT-10115

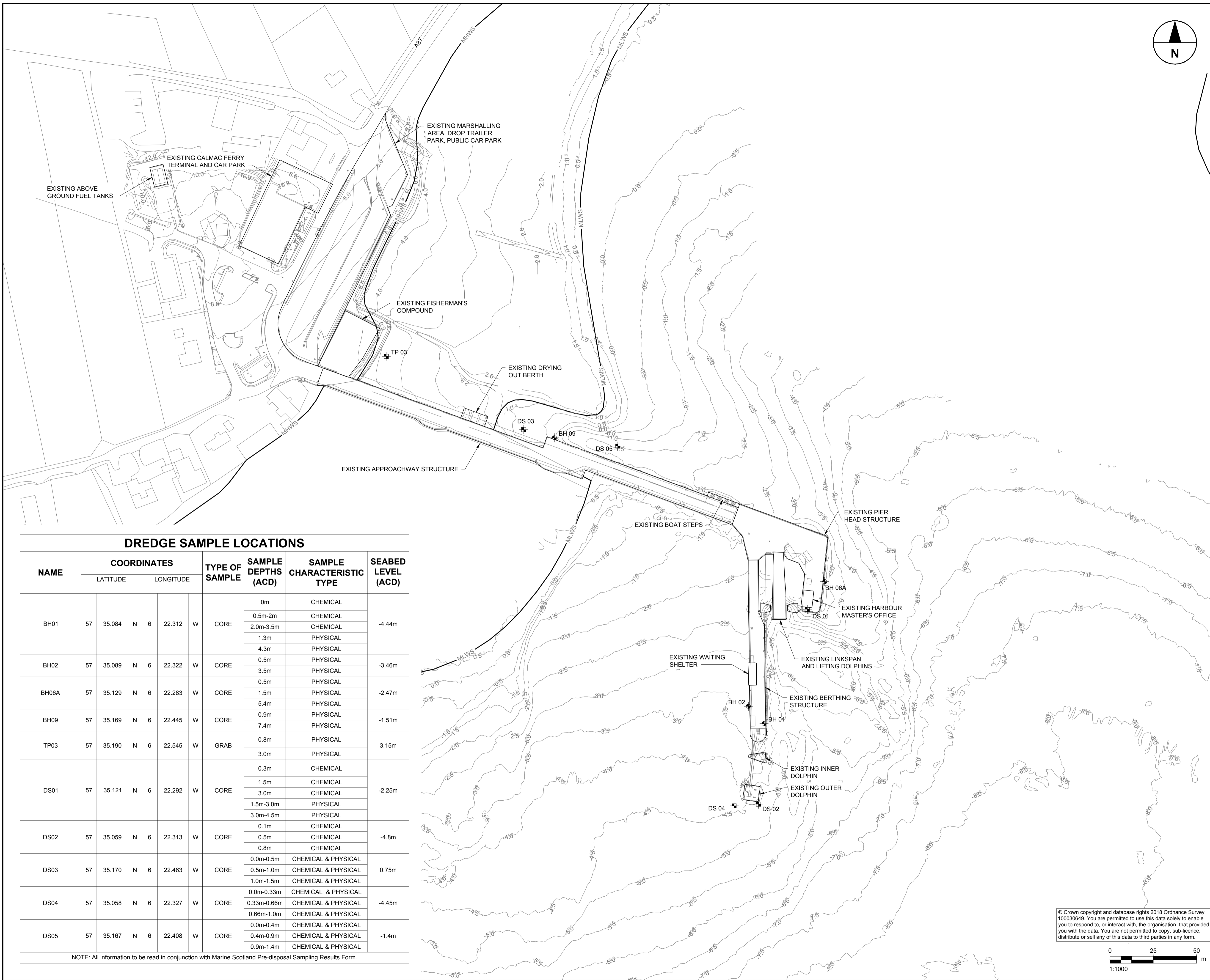

**DREDGE SAMPLE LOCATIONS**

NAME	COORDINATES		TYPE OF SAMPLE	SAMPLE DEPTHS (ACD)	SAMPLE CHARACTERISTIC TYPE	SEABED LEVEL (ACD)		
	LATITUDE	LONGITUDE						
BH01	57	35.084 N	6	22.312 W	CORE	0m	CHEMICAL	-4.44m
						0.5m-2m	CHEMICAL	
						2.0m-3.5m	CHEMICAL	
						1.3m	PHYSICAL	
BH02	57	35.089 N	6	22.322 W	CORE	0.5m	PHYSICAL	-3.46m
						3.5m	PHYSICAL	
						4.3m	PHYSICAL	
						0.5m	PHYSICAL	
BH06A	57	35.129 N	6	22.283 W	CORE	1.5m	PHYSICAL	-2.47m
						5.4m	PHYSICAL	
						0.9m	PHYSICAL	
BH09	57	35.169 N	6	22.445 W	CORE	7.4m	PHYSICAL	-1.51m
						0.8m	PHYSICAL	
TP03	57	35.190 N	6	22.545 W	GRAB	3.0m	PHYSICAL	3.15m
						0.3m	CHEMICAL	
DS01	57	35.121 N	6	22.292 W	CORE	1.5m	CHEMICAL	-2.25m
						3.0m	CHEMICAL	
						1.5m-3.0m	PHYSICAL	
						3.0m-4.5m	PHYSICAL	
DS02	57	35.059 N	6	22.313 W	CORE	0.1m	CHEMICAL	-4.8m
						0.5m	CHEMICAL	
						0.8m	CHEMICAL	
DS03	57	35.170 N	6	22.463 W	CORE	0.0m-0.5m	CHEMICAL & PHYSICAL	0.75m
						0.5m-1.0m	CHEMICAL & PHYSICAL	
						1.0m-1.5m	CHEMICAL & PHYSICAL	
DS04	57	35.058 N	6	22.327 W	CORE	0.0m-0.33m	CHEMICAL & PHYSICAL	-4.45m
						0.33m-0.66m	CHEMICAL & PHYSICAL	
						0.66m-1.0m	CHEMICAL & PHYSICAL	
						0.0m-0.4m	CHEMICAL & PHYSICAL	
DS05	57	35.167 N	6	22.408 W	CORE	0.4m-0.9m	CHEMICAL & PHYSICAL	-1.4m
						0.9m-1.4m	CHEMICAL & PHYSICAL	
						0.4m-0.9m	CHEMICAL & PHYSICAL	

NOTE: All information to be read in conjunction with Marine Scotland Pre-disposal Sampling Results Form.

© Crown copyright and database rights 2018 Ordnance Survey 100030649. You are permitted to use this data solely to enable you to respond to, or interact with, the organisation that provided you with the data. You are not permitted to copy, sub-licence, distribute or sell any of this data to third parties in any form.

