

Chainage 140.00m

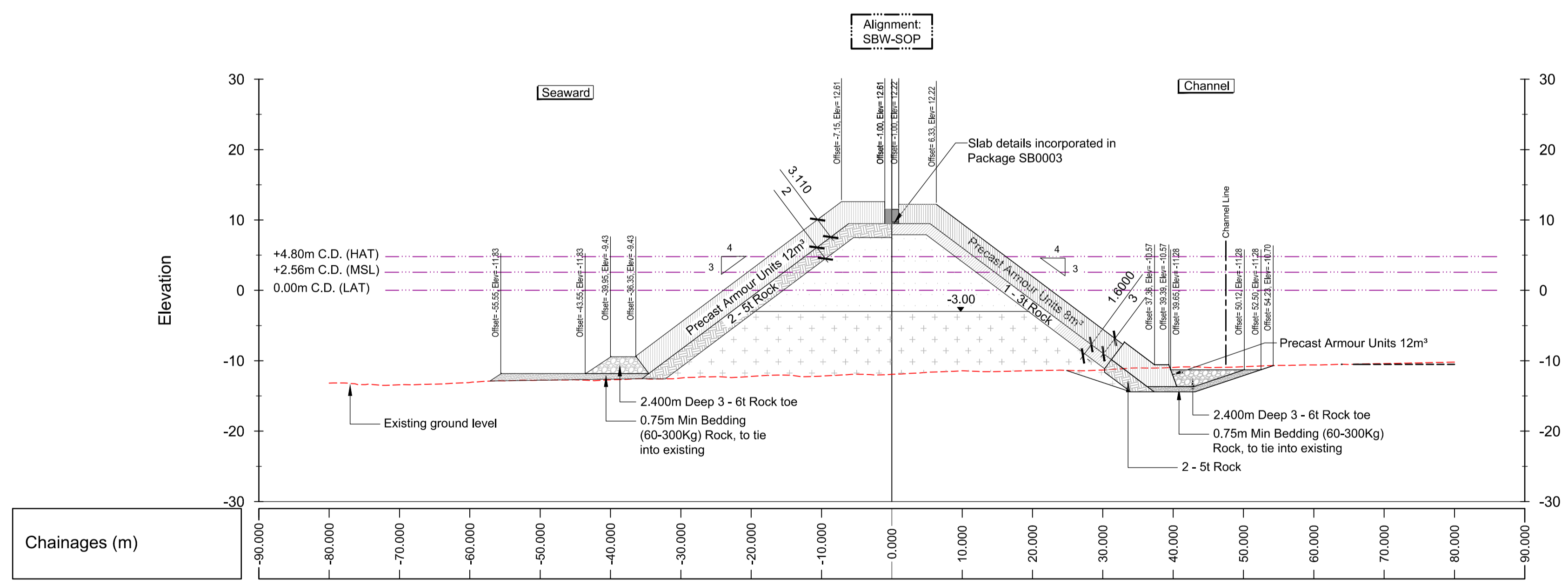

Chainage 130.00m

HEALTH AND SAFETY INFORMATION

SIGNIFICANT OR EXCEPTIONAL RISKS ARE IDENTIFIED BELOW

- Allowable surcharge for temporary construction of 20Kpa has been used. This should be reviewed once construction risks are known.
- Risk of adverse weather during construction.
- Maintenance operations should be limited during severe weather. Overtopping along access slab may mean hazardous high waves will occur.

- Notes:
- All dimensions are m unless noted otherwise.
 - All levels are given in meters above admiralty chart datum (m.C.D) unless noted otherwise.
 - Seabed, soil and rock levels have been interpreted from ground investigation and will vary on site.
 - Refer to drawings series DRA-P-SBW-SB0003-DWG-250001-000 for south breakwater access slab.
 - For dredging setting out refer to Drawing No.: DRA-P-SBW-SB0002-DWG-250001-037 and 038.
 - Depending on the site conditions and the presence of rock encountered during construction, the scour apron width may be reduced to a minimum width to suit the edge of the 3-6t rock toe. Where rock isn't present minimum scour width = 7m.
 - For Typical Toe Details refer to Drawing No.: DRA-P-SBW-SB0002-DWG-250001-039.

Core Grading Limits By Mass

Cumulative Percentage	Lower Limit	Upper Limit
M5%	1 kg	
M15%	1 kg	16 kg
M50%	11 kg	900 kg
M85%	38 kg	1000 kg

- Legend:
- Marine placed core material (0.1 - 500Kg)
 - Land placed core material (0.1 - 500Kg)
 - Existing ground level profile to be removed

Issue	Date	By	Chkd	Appd
C3	24/07/18	PC	LG	NL
Issued For Construction				
C2	15/01/18	PC	LG	NL
Issued For Construction				
C1	19/12/17	PC	LG	NL
Issued For Construction				

ARUP

Scotstoun House, South Queensferry
West Lothian, EH30 9SE
Tel +44 (0)13 1331 1999 Fax +44 (0)13 1331 3730
www.arup.com

Client

DRAGADOS

Job Title
Aberdeen Harbour Expansion Project

Drawing Title
Southern Breakwater

Cross Sections

Arup Job No **253300-00** Scale at A1 1:500

Discipline **25 - STRUCTURES**

Drawing Status **Issued For Construction** Rev **C3**

Drawing No **DRA-P-SBW-SB0002-DWG-250001-011**