

RESIDUAL DESIGN HAZARDS

- (The following information has been collected from Preconstruction Information and the Amey CDM Hazard Management Process.)
1. Refer to Designer's Risk Register.
 2. Working at height - Contractor to install scaffold/webdeck as manufacturer's instruction.
 3. Compact Site - Contractor to plan works accordingly.
 4. Interface with Public & other Contractors - Other works on bridge to be allowed access at footpaths at all times.
 5. Staging capacity. 0.7kN/m² = 1.66kN per board = 169kg per board. It is recommended that, 6 men and light materials (as a distributed load) is the maximum per 10 board platform.
 6. Public - Fence off worksite on footpath.

NOTES

1. Please type your text here. Please type your text here. Please type your text here. Please type your text here. Please type your text here. Please type your text here. Please type your text here. Please type your text here.
2. Please type your text here. Please type your text here. Please type your text here. Please type your text here. Please type your text here. Please type your text here. Please type your text here. Please type your text here.
3. Please type your text here. Please type your text here. Please type your text here. Please type your text here. Please type your text here. Please type your text here. Please type your text here. Please type your text here.

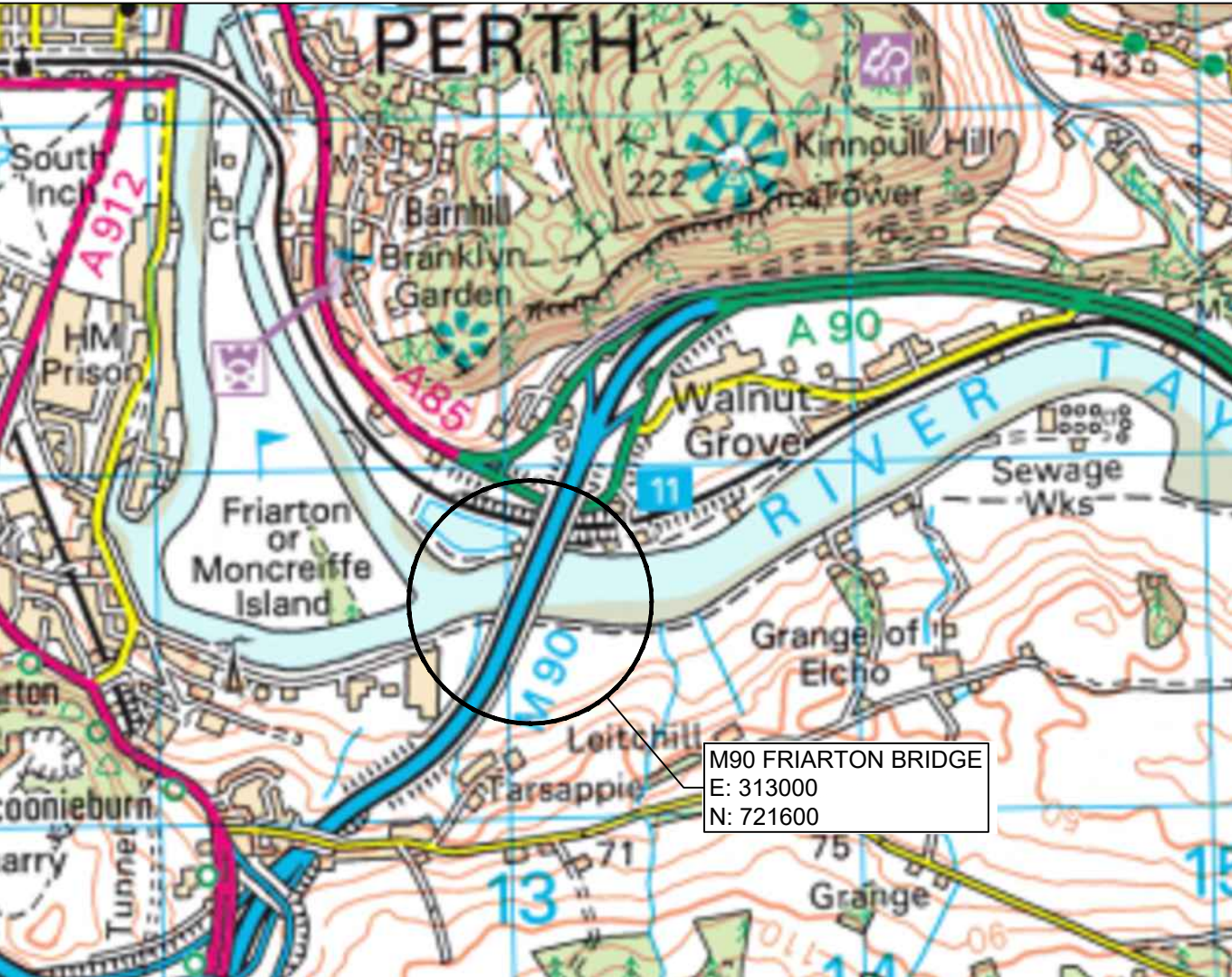

SITE LOCATION
NTS

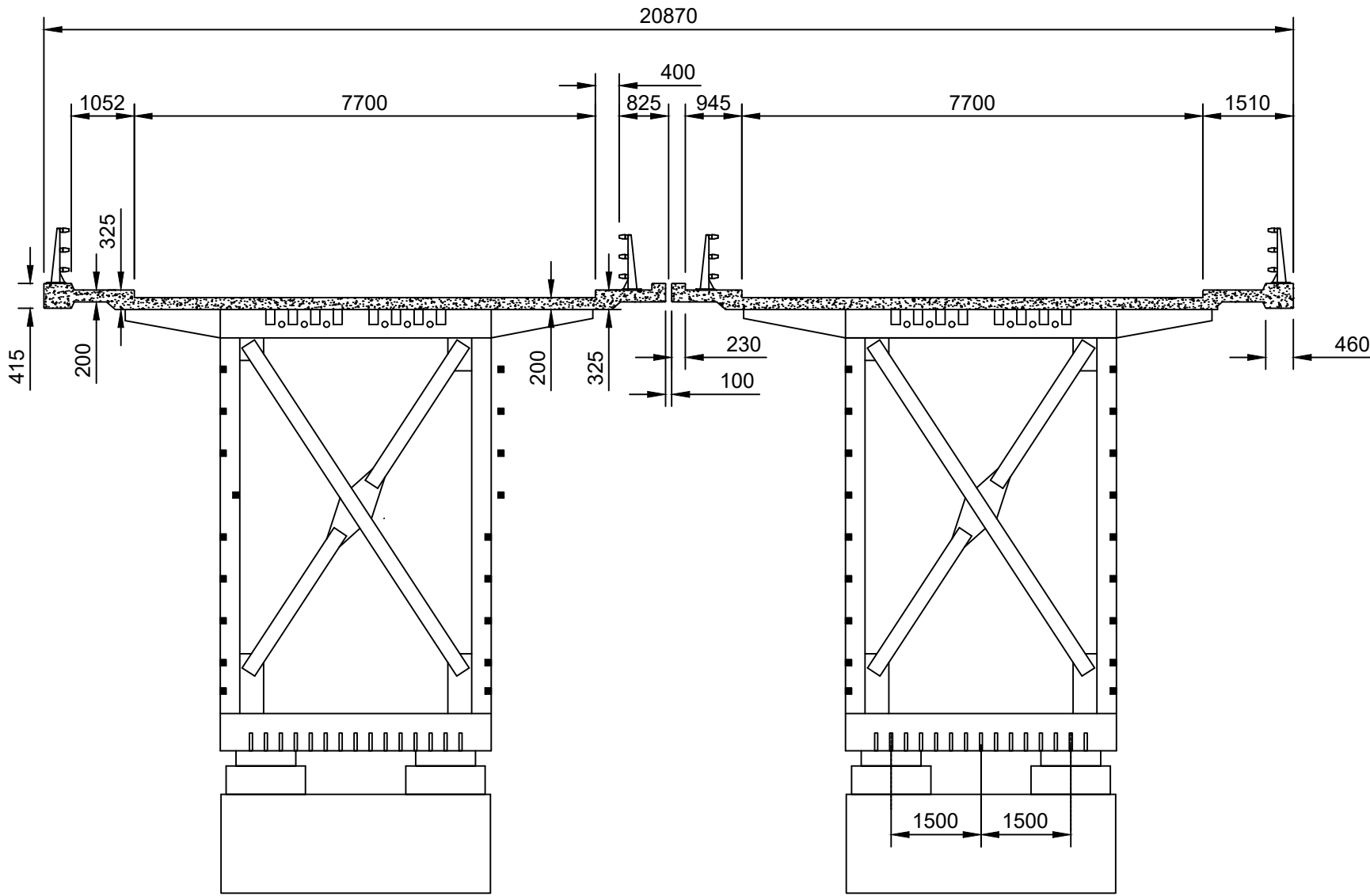

CROSS SECTION NEAR TO MAIN
PIERS 6 AND 7
1:100

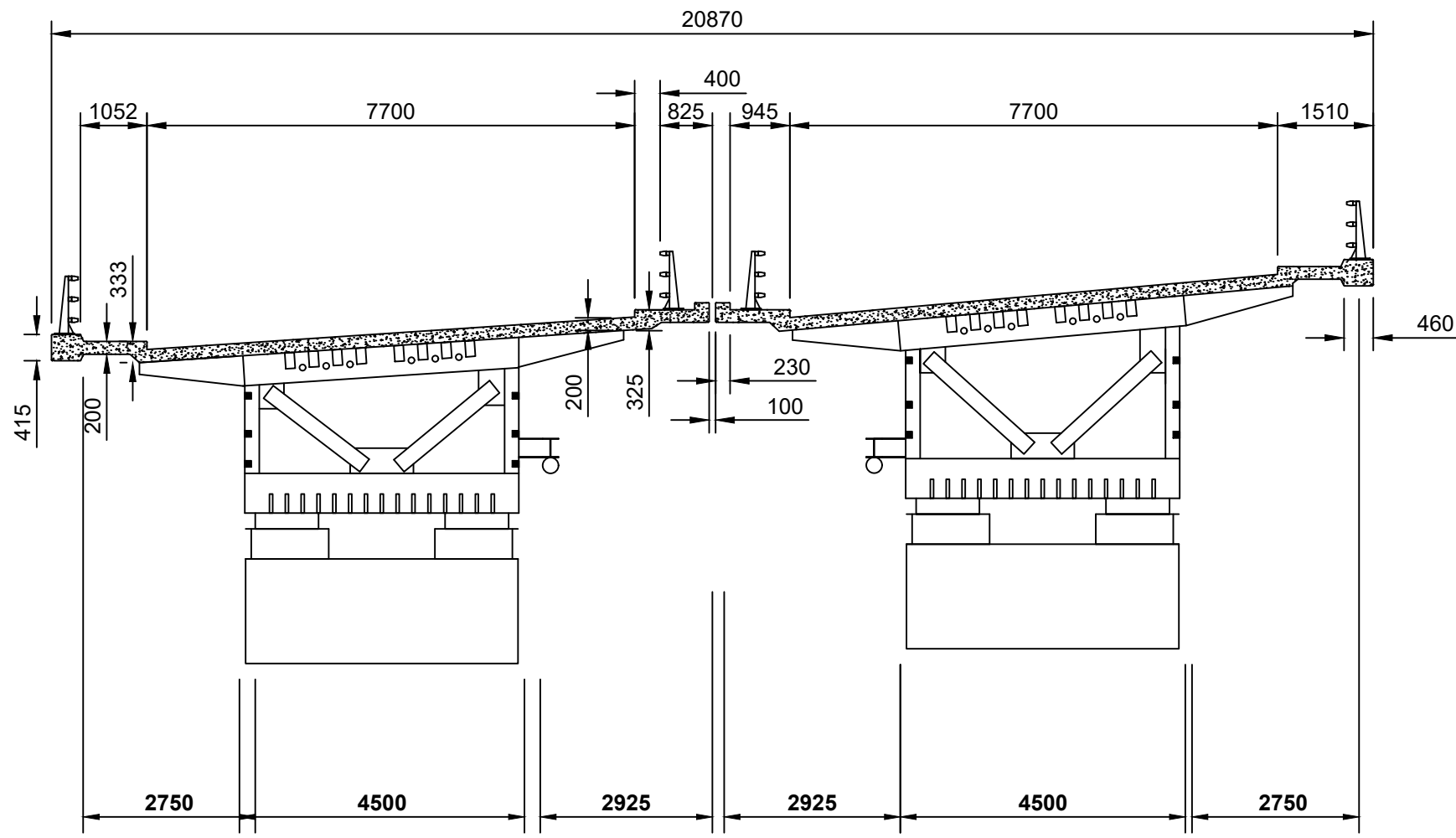

CROSS-SECTION NEAR TO
APPROACH SPAN PIER 5
1:100

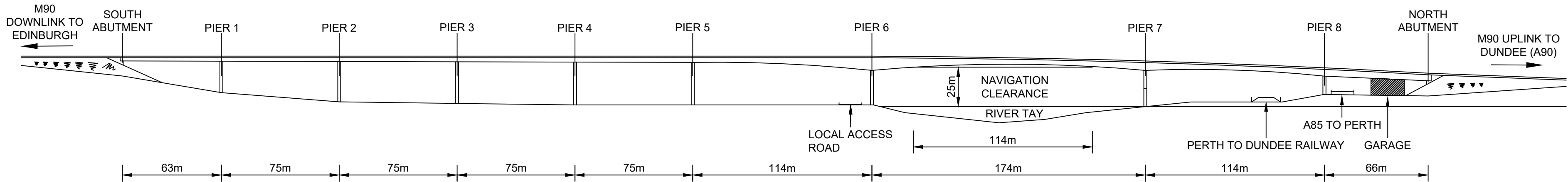

ELEVATION
1:2000

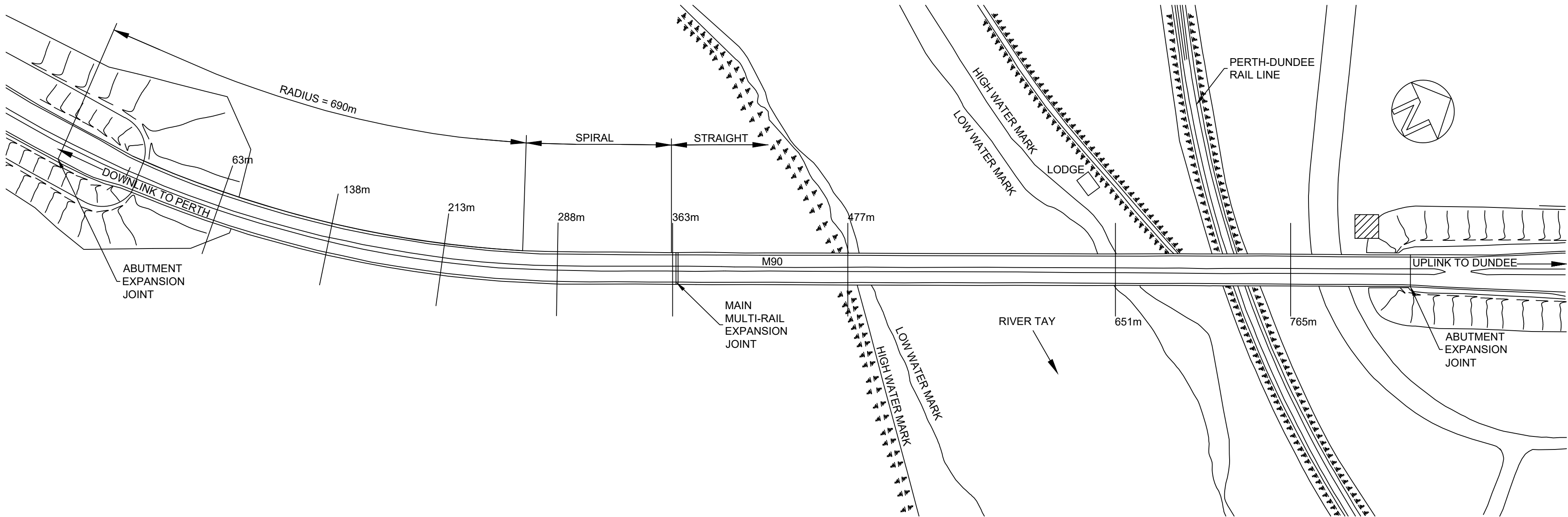

PLAN
1:2000

Rev	Revision details	Chkd	Appd	Date
Drawn:			Preliminary	✓
Design:			For comment	
Chkd:			For tender	
Appd:			For construction	
Date:			As constructed	
			Other	

Amey

www.amey.co.uk

Client



Project Name
FRIARTON BRIDGE

Drawing Title
GENERAL ARRANGEMENT

Original Drawing Size : A1
Scale : As Shown

Dimensions : -
Copyright © Amey

Drawing No
TEXT

Rev
P0