

Ordnance Survey (c) Crown Copyright 2014. All rights reserved. Licence number 100022432

**LOCATION PLAN**  
Scale 1:10,000

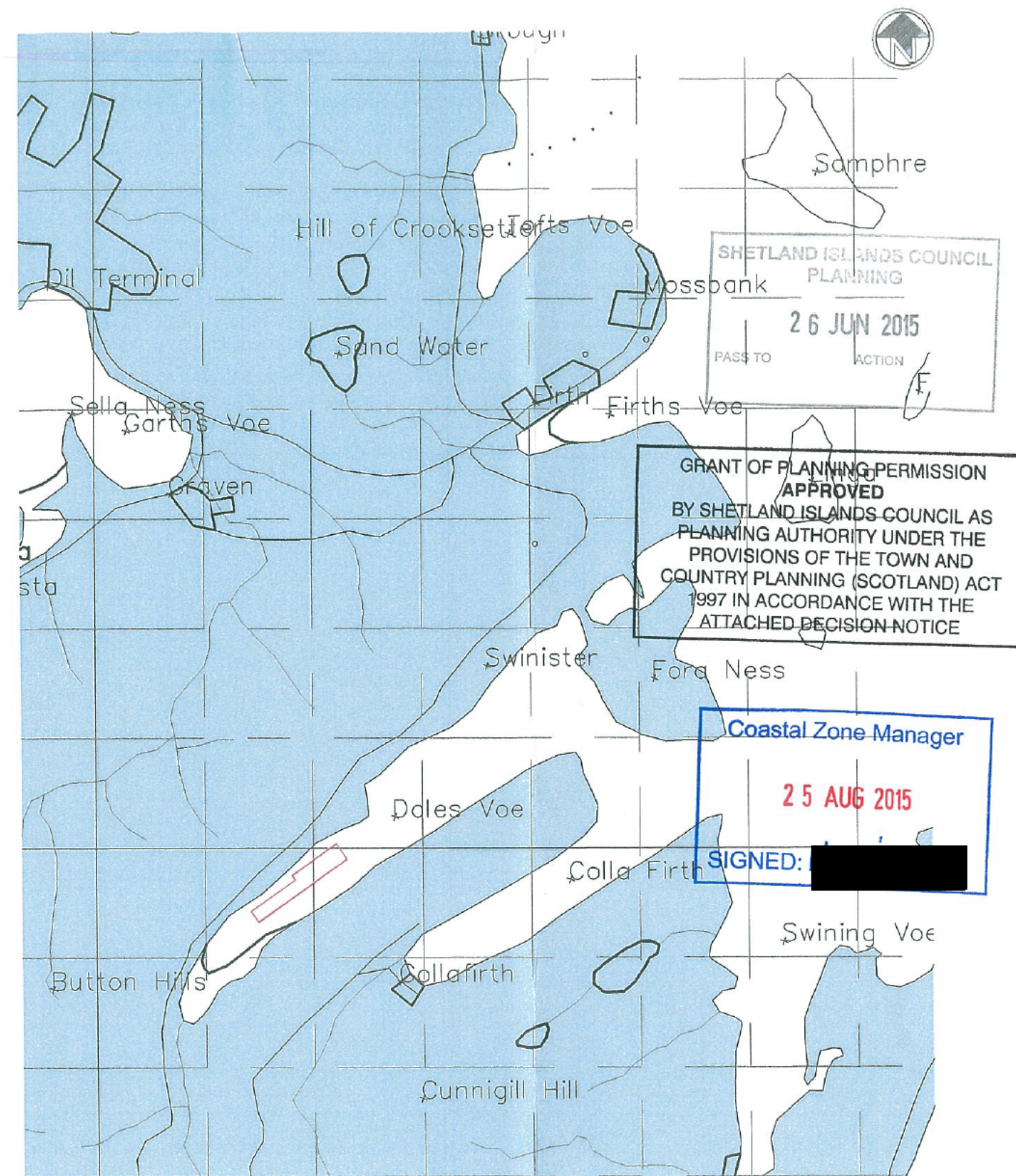

**LOCATION PLAN**  
Scale 1:50,000

© Copyright Vega Technical Services (VTS)  
No part of this document may be reproduced or transmitted in any form without the written permission of VTS. This document should not be relied on or used in circumstances other than those for which it was originally prepared and for which VTS was commissioned. VTS accepts no responsibility for this document to any other party other than the person by whom it was commissioned.

**VEGA TECHNICAL SERVICES (shetland) LTD.**  
Architectural, Land Surveying and Civil Engineering CAD drafting



HOSWICK VISITOR CENTRE SANDWICK SHETLAND ZE2 9HL

Tel: (01950) 431 502/278  
Mob: 07770 854 578  
E-mail: michael@vegatech.plus.com

Project <b>HUNTER SHELFISH</b> MUSSELL FARM MARINE PLANNING APPLICATION - SCARVAR AYRE 1		Date Drawn 3.12.14
Drawing Title Location plan		Scale(s) @ A3 1:10,000 1:50,000
Drawing Status <b>PLANNING</b>	Drawing Number <b>1037/C/02</b>	Revision <b>A</b>

A3 Original

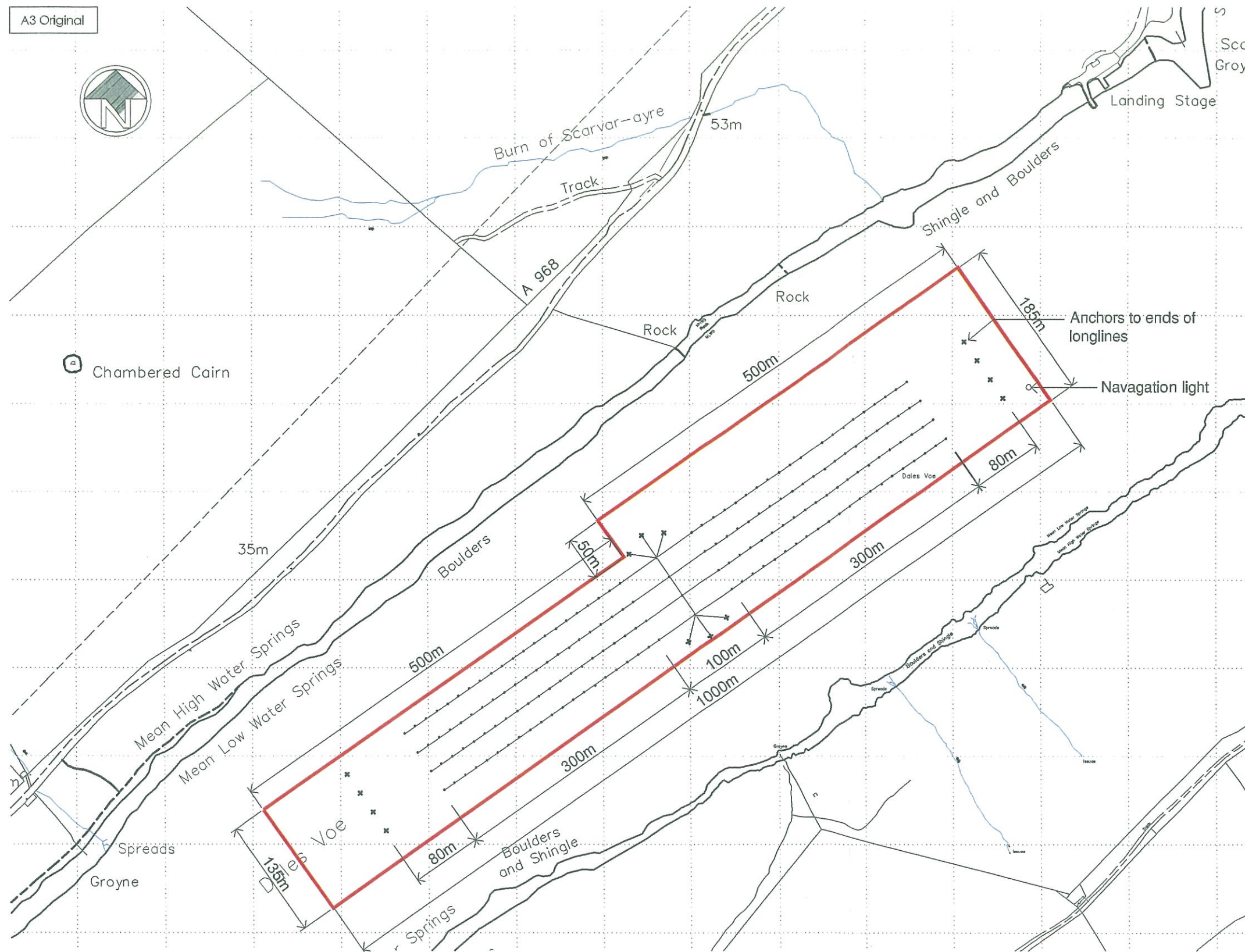

Project <b>HUNTER SHELFISH</b> MUSSELL FARM MARINE PLANNING APPLICATION - SCARVAR AYRE 1		Date Drawn 8.12.14
Drawing Title Site plan		Scale(s) @ A3 1:5000
Drawing Status <b>PLANNING</b>	Drawing Number <b>1037/C/01</b>	Revision <b>A</b>

**VEGA TECHNICAL SERVICES (shetland) LTD.**  
Architectural, Land Surveying and Civil Engineering CAD drafting



HOSWICK VISITOR CENTRE • SANDWICK • SHETLAND • ZE2 9HL

Tel: (01950) 431 502/279  
Mob: 07770 854 578  
E-mail: michael@vegatech.plus.com

**GRANT OF PLANNING PERMISSION  
APPROVED**  
BY SHETLAND ISLANDS COUNCIL AS  
PLANNING AUTHORITY UNDER THE  
PROVISIONS OF THE TOWN AND  
COUNTRY PLANNING (SCOTLAND) ACT  
1997 IN ACCORDANCE WITH THE  
ATTACHED DECISION NOTICE

Easting (m)	Northing (m)
441 511.50 60° 24' 24.208452"	1169 439.18 -1° 14' 34.045096"
441 923.71 60° 24' 33.318072"	1169 725.73 -1° 14' 26.896344"
441 894.31 60° 24' 34.668396"	1169 767.17 -1° 14' 28.786002"
442 306.47 60° 24' 43.777512"	1170 053.78 -1° 14' 1.639656"
442 411.61 60° 24' 38.89"	1169 903.81 -1° 13' 54.880"
441 5901.57 60° 24' 20.594"	1169 328.21 -1° 14' 48.961"

**Coastal Zone Manager**

**29 AUG 2015**

**SIGNED** *Michael Holmes*

**DEVELOPMENT AREA**  
(delineated in red)

# **SITE PLAN**

Scale 1:5000

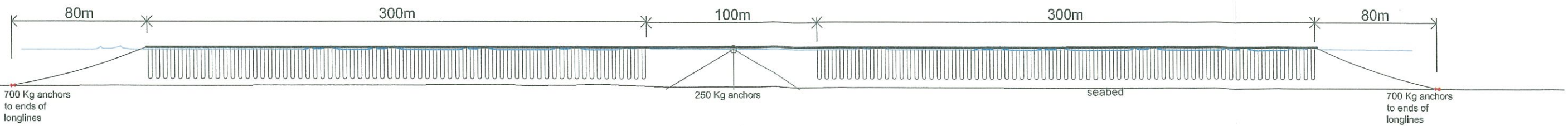

## **INDICATIVE LONGLINE SECTION**

Scale 1:2500

© Copyright Vega Technical Services (VTS)  
No part of this document may be reproduced or transmitted in any form without  
the written permission of VTS. This document should not be relied on or used in  
circumstances other than those for which it was originally prepared and for  
which VTS was commissioned. VTS accepts no responsibility for this document to  
any other party other than the person by whom it was commissioned.

**SHETLAND ISLANDS COUNCIL  
PLANNING**  
**26 JUN 2015**  
PASS TO ACTION