

PB9049-RHD-ZZ-RW-DR-CM-0016

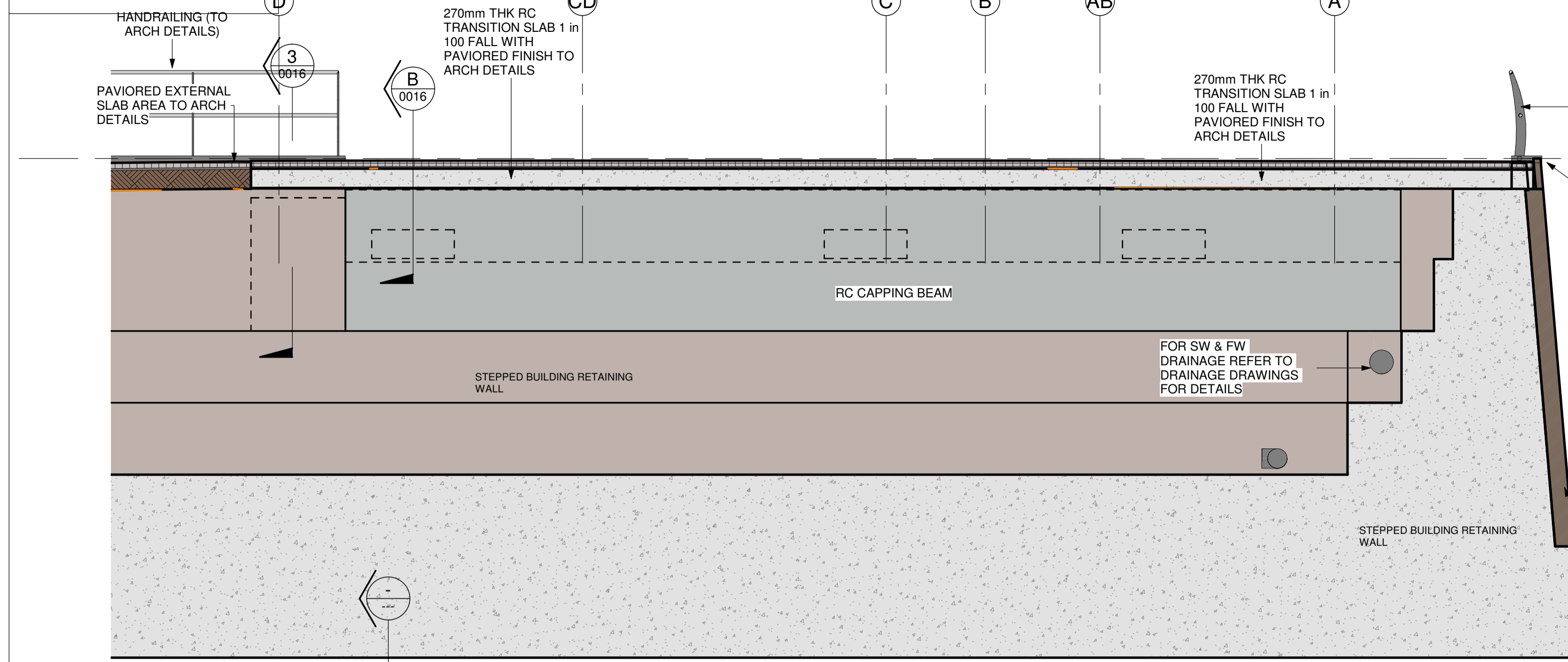

**RETAINING WALL ELEVATION A ON GRID 7**  
1 : 50(A1)

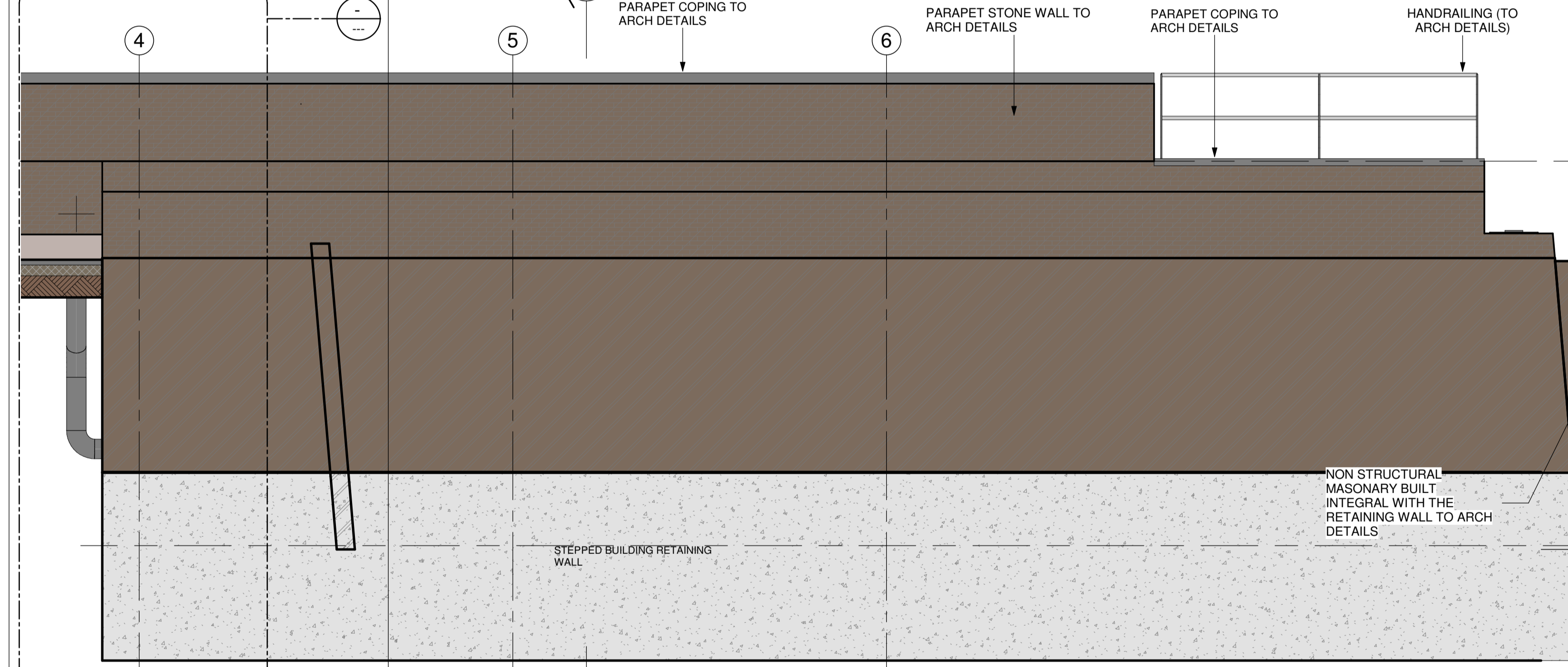

**RETAINING WALL ELEVATION B ON GRID A**  
1 : 50(A1)

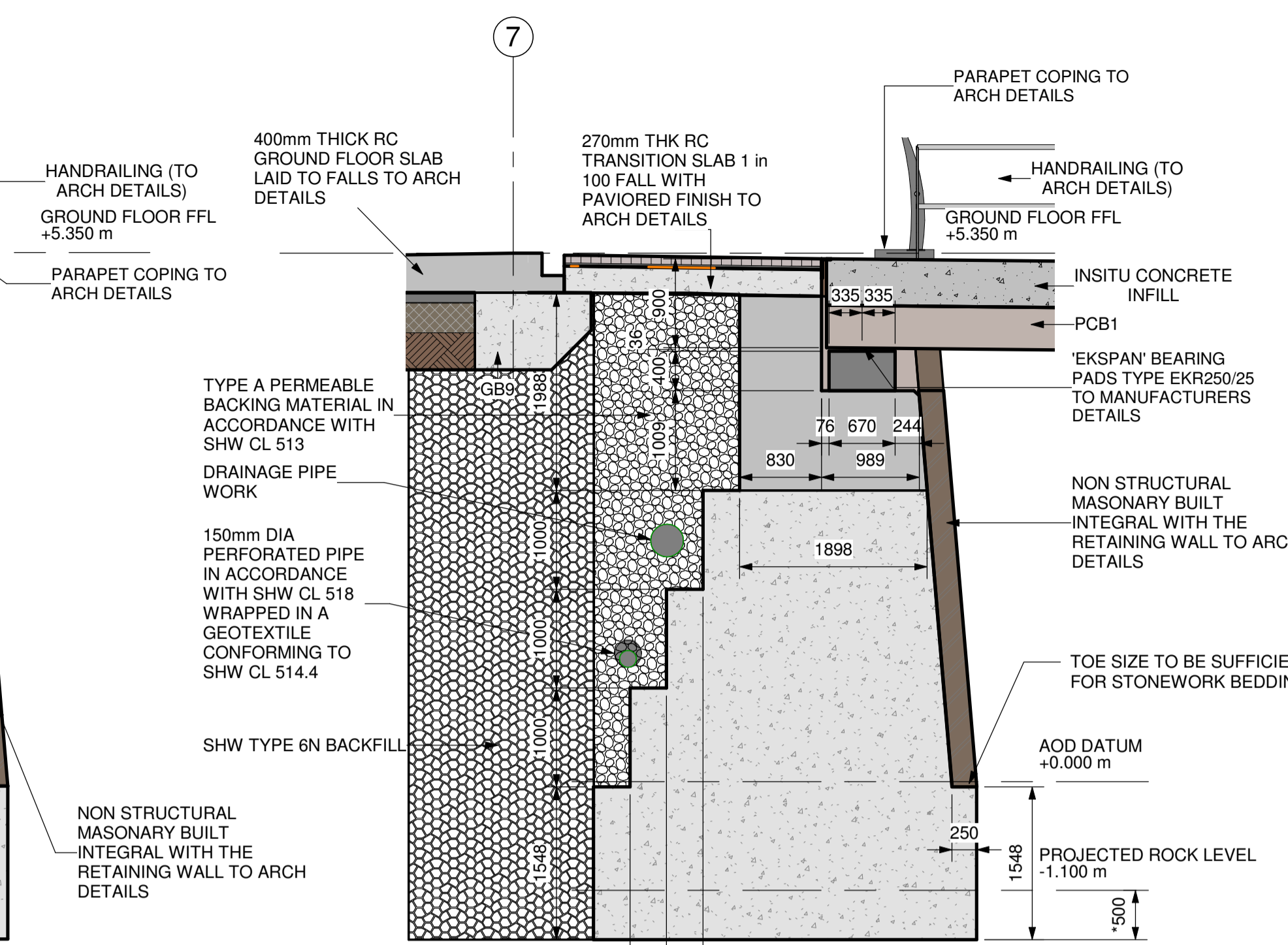

**SECTION 1 - 1**  
1 : 50(A1)

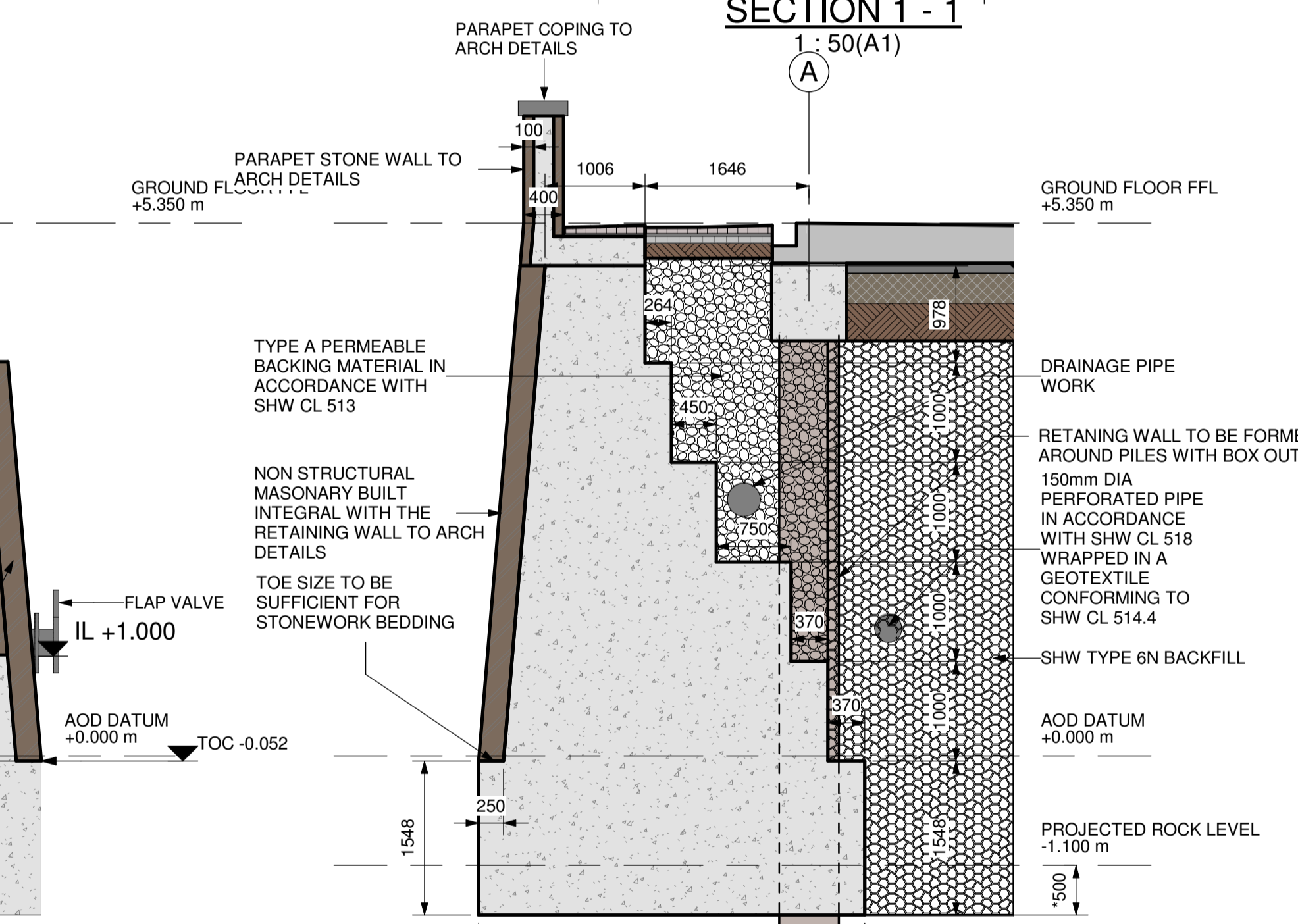

**SECTION 2 - 2**  
1 : 50(A1)

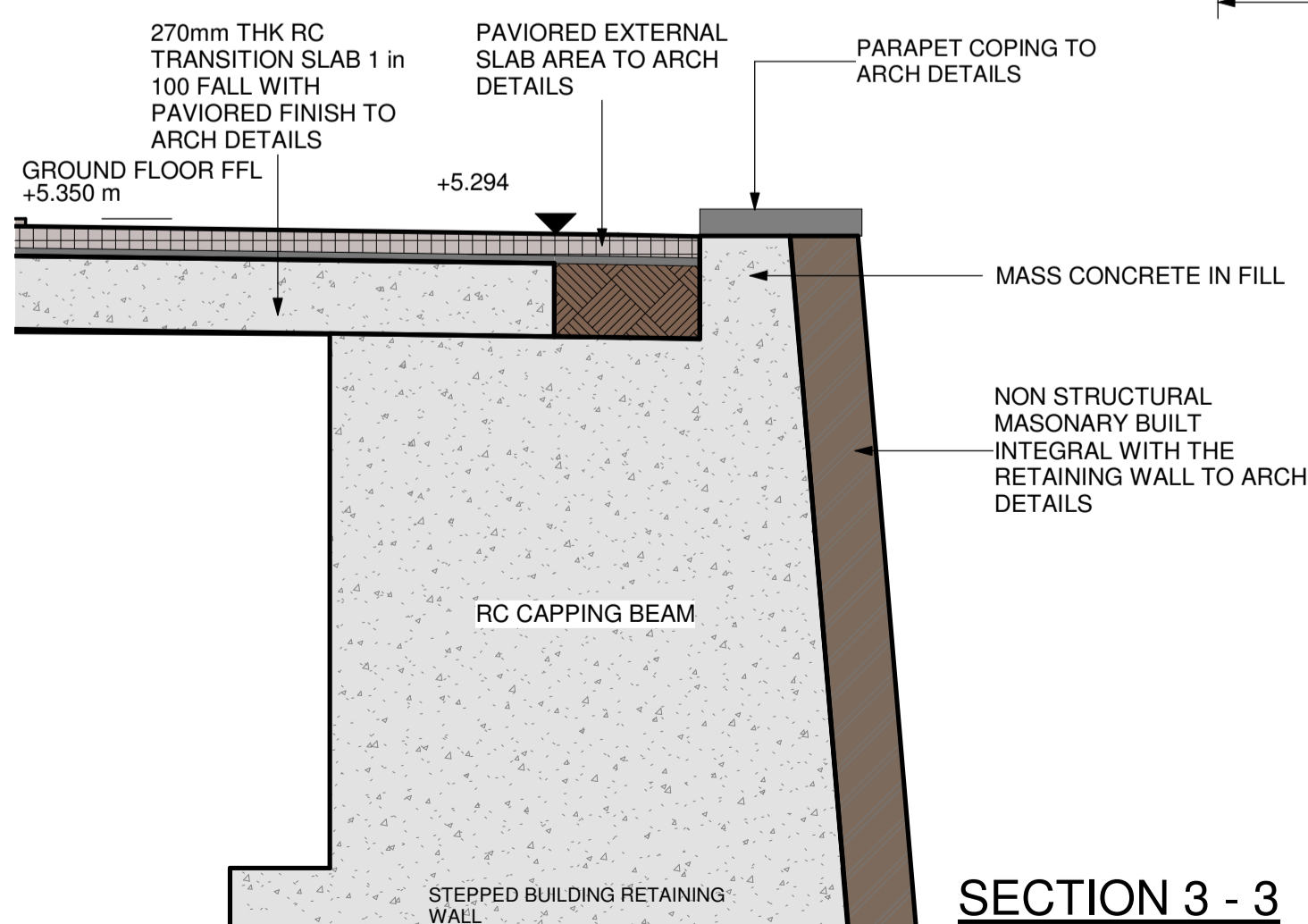

**SECTION 3 - 3**  
1 : 25(A1)

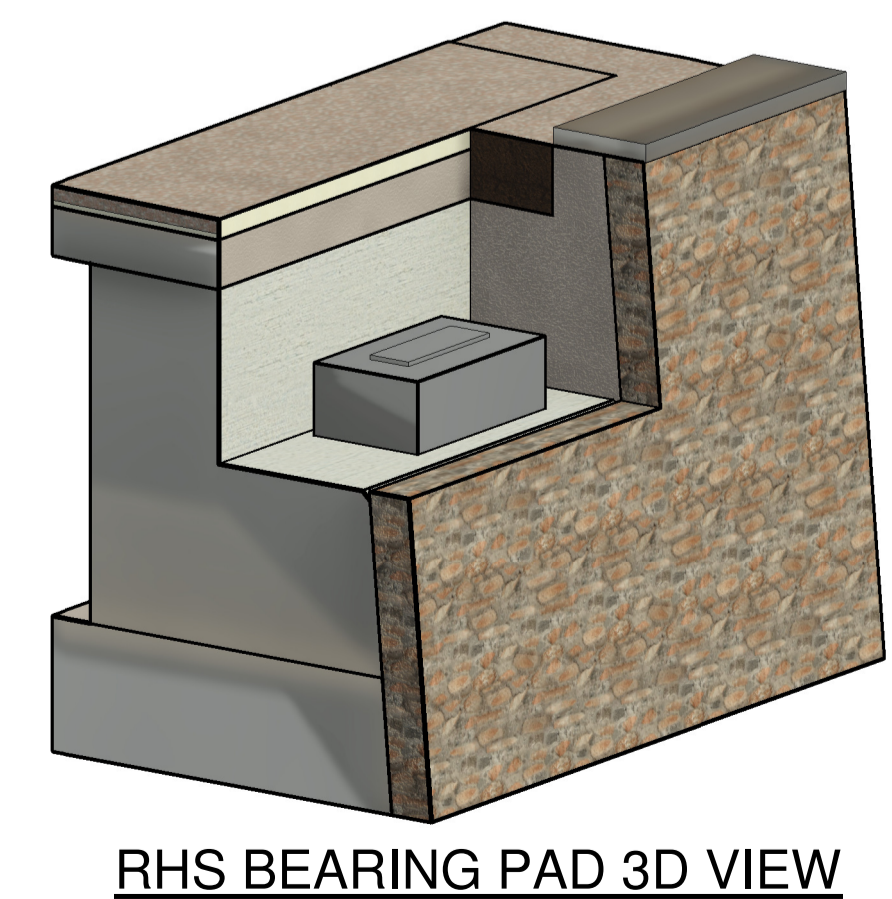

**RHS BEARING PAD 3D VIEW**  
(A1)

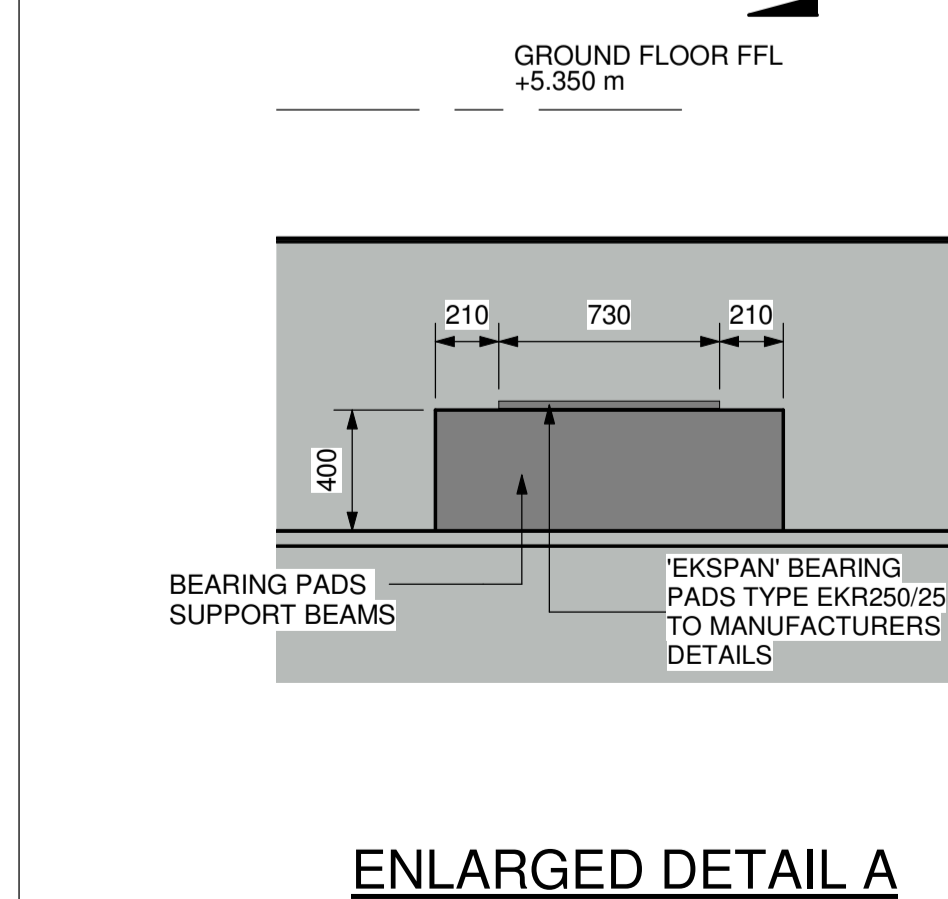

**ENLARGED DETAIL A**  
1 : 25(A1)

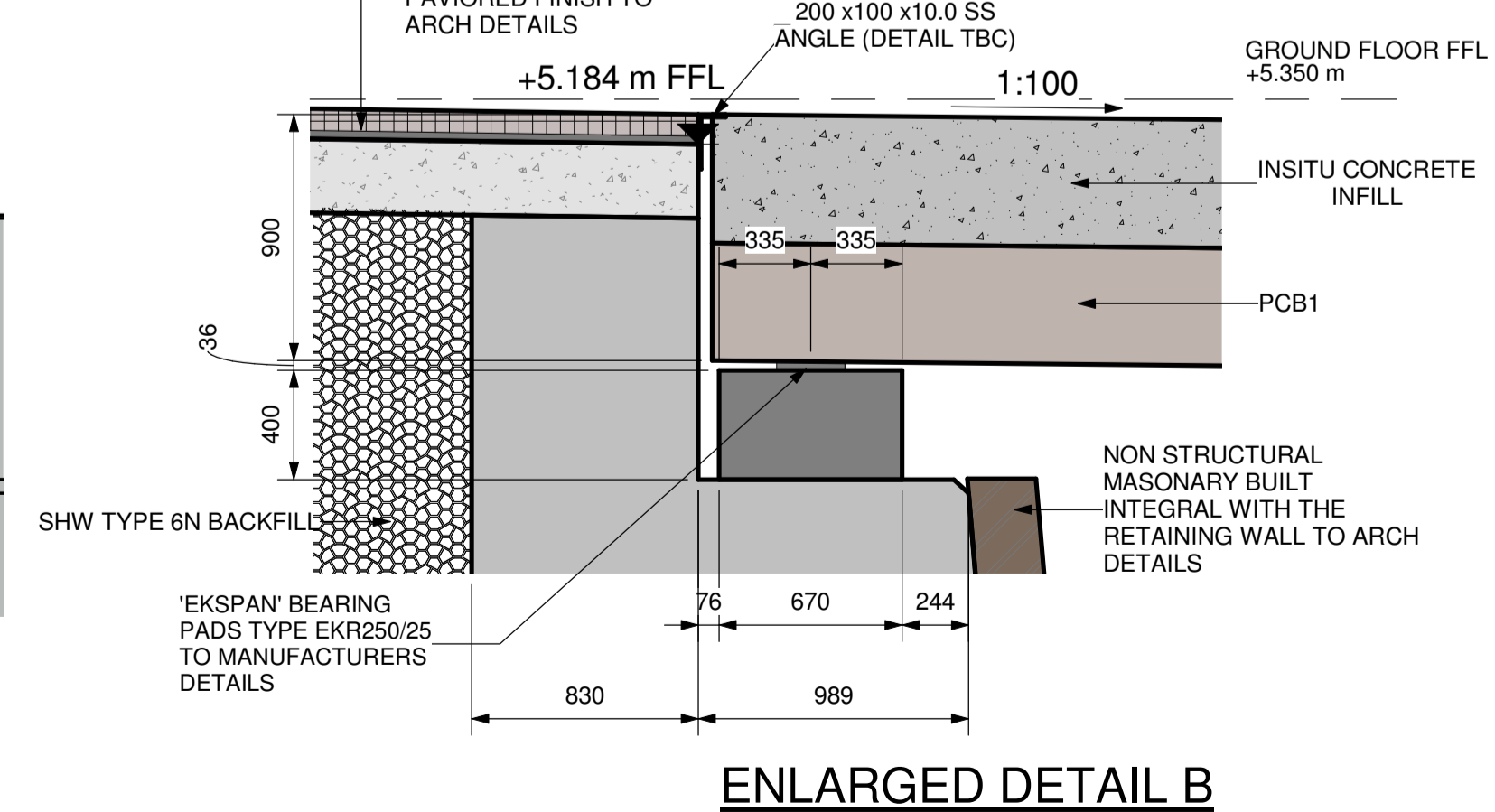

**ENLARGED DETAIL B**  
1 : 25(A1)

- NOTES:**
1. ALL DIMENSIONS ARE IN MILLIMETRES UNLESS NOTED OTHERWISE.
  2. ALL MATERIALS AND WORKMANSHIP WILL BE AS DEFINED IN THE SPECIFICATION UNLESS NOTED OTHERWISE.
  3. CONCRETE TO BE GRADE C40/50 TO EN 1992-1-1 UNLESS NOTED OTHERWISE.
  4. NOMINAL COVER TO REINFORCEMENT IS TO BE 50mm UNLESS NOTED OTHERWISE.
  5. REINFORCEMENT SHALL BE GRADE B500B OR C TO EN 10080

**D2 FOR TENDER**

REV	DATE	DESCRIPTION	MT	MY	MY
P01	28.07.23	FOR TENDER ISSUE			
			BY	CHK	APP



PROJECT  
**RNLI LIFE BOAT STATION ANSTRUTHER**

TITLE  
**GA RETAINING WALL SECTIONS AND ELEVATIONS**

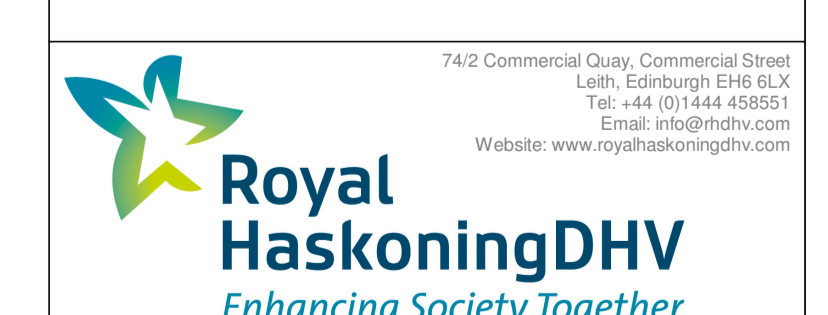

DRAWN	MT	CHECKED	TH	APPROVED	AR
DATE	25.06.21	SCALE	As indicated	SCHEDULE REF.	
DRAWING No.	PB9049-RHD-ZZ-RW-DR-CM-0016	SUITABILITY	S5	REVISION	P01