

Reproduced by permission of Ordnance Survey® on behalf of The Controller of Her Majesty's Stationery Office. © Crown copyright 2018. All rights reserved. Licence number : 100021621

Chart Datum (Kirkwall)	Ordnance Datum (Newlyn)	Quay Heights and Tide Data Hatston Pier, Kirkwall
+6.40m	+5.00m	Quay Edge Level
+3.00m	+1.60m	Mean High Water Spring Tides
+1.40m	0.00m	Ordnance Datum (Newlyn)
+0.60m	-0.80m	Mean Low Water Spring Tides
0.00m	-1.40m	Chart Datum (Kirkwall)
-5.00m	-6.40m	
-7.50m	-8.90m	
-10.00m	-11.40m	

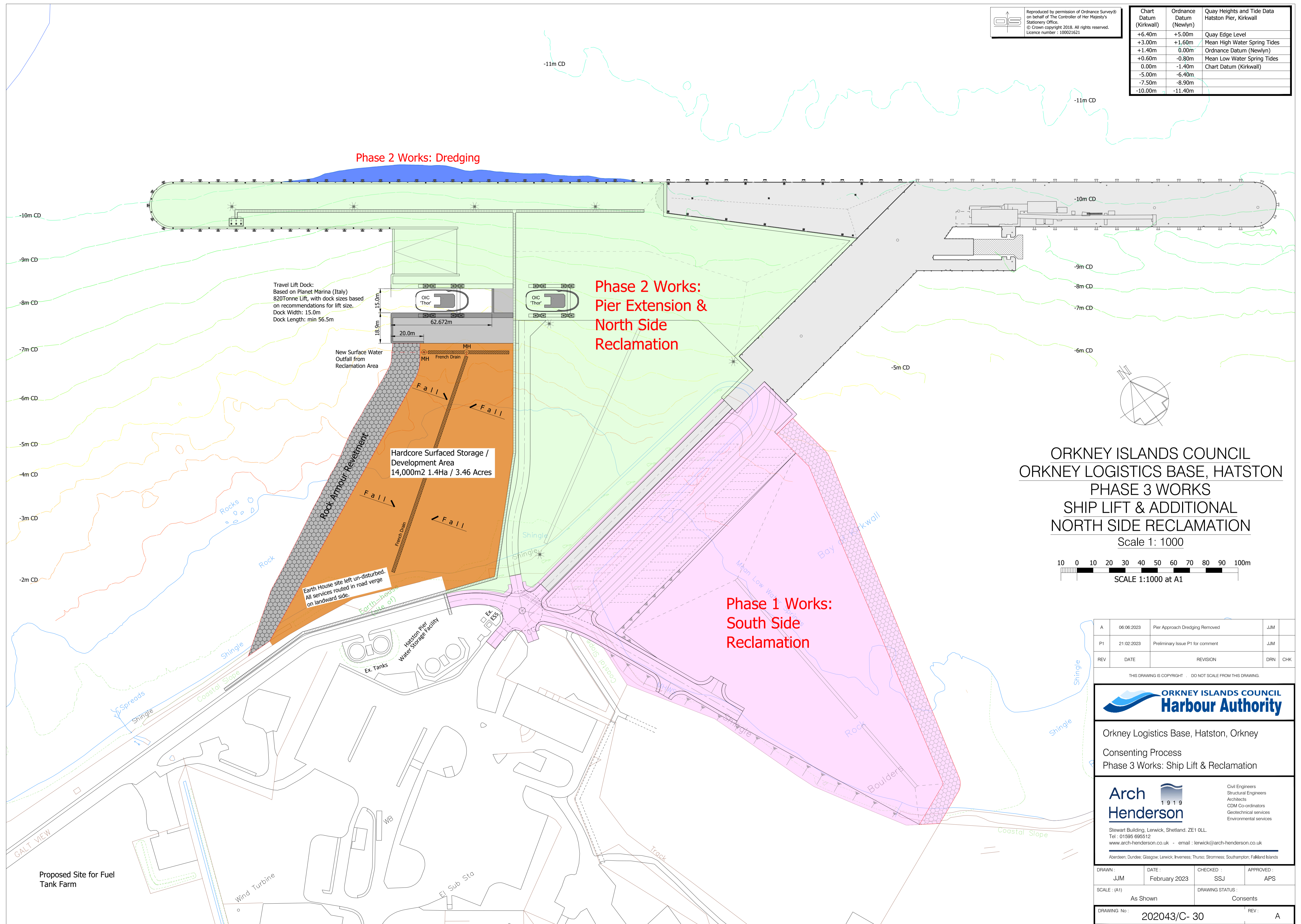

Travel Lift Dock:
Based on Planet Marina (Italy)
820Tonne Lift, with dock sizes based
on recommendations for lift size.
Dock Width: 15.0m
Dock Length: min 56.5m

Hardcore Surfaced Storage /
Development Area
14,000m² 1.4Ha / 3.46 Acres

Earth House site left un-disturbed.
All services routed in road verge
on landward side.

Phase 2 Works:
Pier Extension &
North Side
Reclamation

Phase 1 Works:
South Side
Reclamation

ORKNEY ISLANDS COUNCIL
ORKNEY LOGISTICS BASE, HATSTON
PHASE 3 WORKS
SHIP LIFT & ADDITIONAL
NORTH SIDE RECLAMATION
Scale 1: 1000

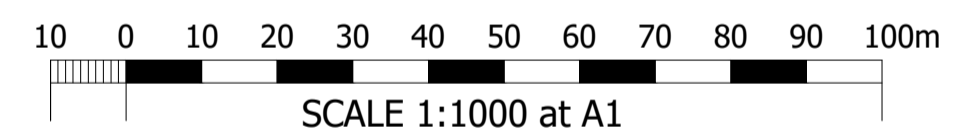

A	06.06.2023	Pier Approach Dredging Removed	JJM	
P1	21.02.2023	Preliminary Issue P1 for comment	JJM	
REV	DATE	REVISION	DRN	CHK

THIS DRAWING IS COPYRIGHT . DO NOT SCALE FROM THIS DRAWING.

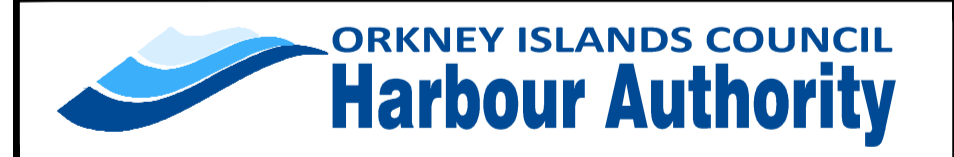

Orkney Logistics Base, Hatston, Orkney
Consenting Process
Phase 3 Works: Ship Lift & Reclamation

Arch Henderson 1919
Civil Engineers
Structural Engineers
Architects
CDM Co-ordinators
Geotechnical services
Environmental services
Stewart Building, Lerwick, Shetland, ZE1 0LL.
Tel : 01595 695512
www.arch-henderson.co.uk - email : lerwick@arch-henderson.co.uk
Aberdeen, Dundee, Glasgow, Lerwick, Inverness, Thurso, Stromness, Southampton, Falkland Islands

DRAWN : JJM	DATE : February 2023	CHECKED : SSJ	APPROVED : APS
SCALE : (A1) As Shown	DRAWING STATUS : Consents		
DRAWING No : 202043/C- 30		REV : A	

Proposed Site for Fuel Tank Farm