

PLAN ON EXISTING SEWER OUTFALL
SCALE 1:500

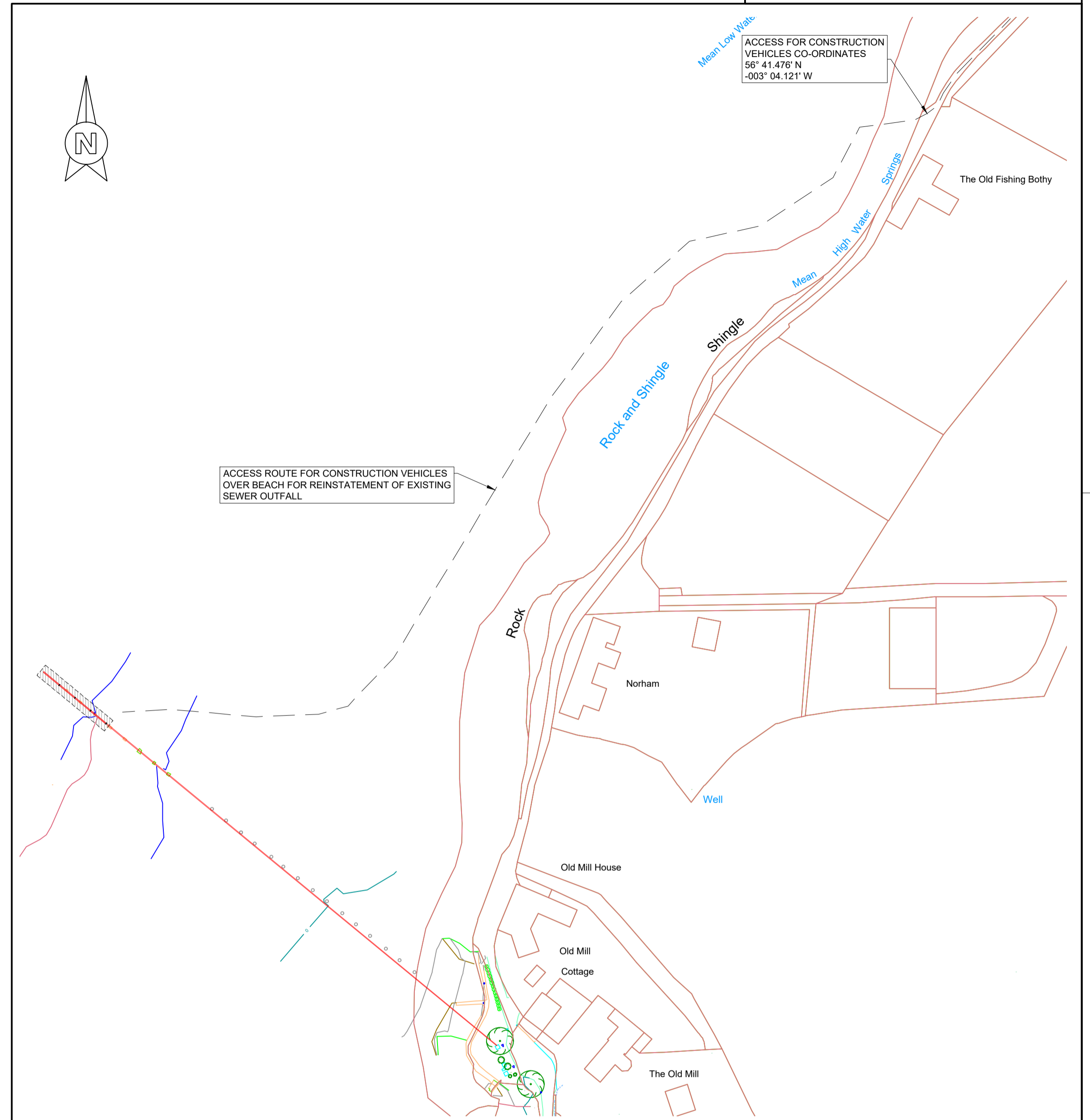

PLAN ON TEMPORARY SITE ACCESS
SCALE 1:1000



LOCATION PLAN
SCALE 1:25,000

- NOTES:-**
1. ALL DIMENSIONS ARE IN MILLIMETRES
 2. ALL LEVELS ARE METRES ABOVE AOD
 3. EXISTING PIPE CONDITION TO BE CHECKED BEFORE EXACT POSITION OF CUT IN EXISTING OUTFALL CONFIRMED
 4. REFER TO DRAWING 5214230000-AGO-ZZ-XX-DR-C-0002 FOR LONGITUDINAL SECTION & DETAILED PLAN
 5. REFER TO DRAWING 5214230000-AGO-ZZ-XX-DR-C-0003 FOR DETAILS

ALLEN GORDON REFERENCES
ALLEN GORDON JOB No. - 603657
ALLEN GORDON CLIENT - MORRISON CONSTRUCTION

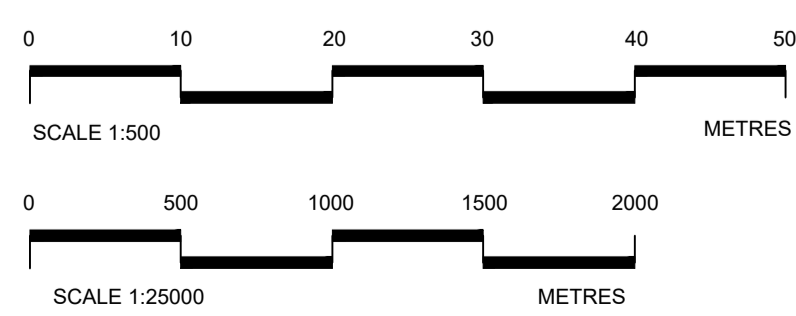

Rev	Description	Drawn	Chk'd	Rev'd	App'd	Date
P02	SITE ACCESS PLAN ADDED	EH	SW	SW	GJD	15/03/23
P01	FIRST ISSUE	EH	SW	SW	GJD	27/02/23

This drawing is the property of Scottish Water and must not be copied or used for any purpose other than that for which it is supplied without the written consent of Scottish Water.

Scottish Water
Trusted to serve Scotland

SCOTTISH WATER
CASTLE HOUSE
6 CASTLE DRIVE
CARNegie CAMPUS
DUNFERMLINE
FIFE KY11 8GG
TEL: 0800 0778778

Morrison Construction

Scale	Status	Submittal
AS SHOWN	S1	FOR APPROVAL

Project Title
BALMERINO OUTFALL REPAIR WORK

Drawing Title
SITE PLAN

Ellipse Equipment No. xx
Ellipse Plant No. xx Autocode No. S21423

Drawing No.
5214230000-AGO-ZZ-XX-DR-C-0001

REV.
P02