

PICTURE 1



PICTURE 2



PICTURE 3

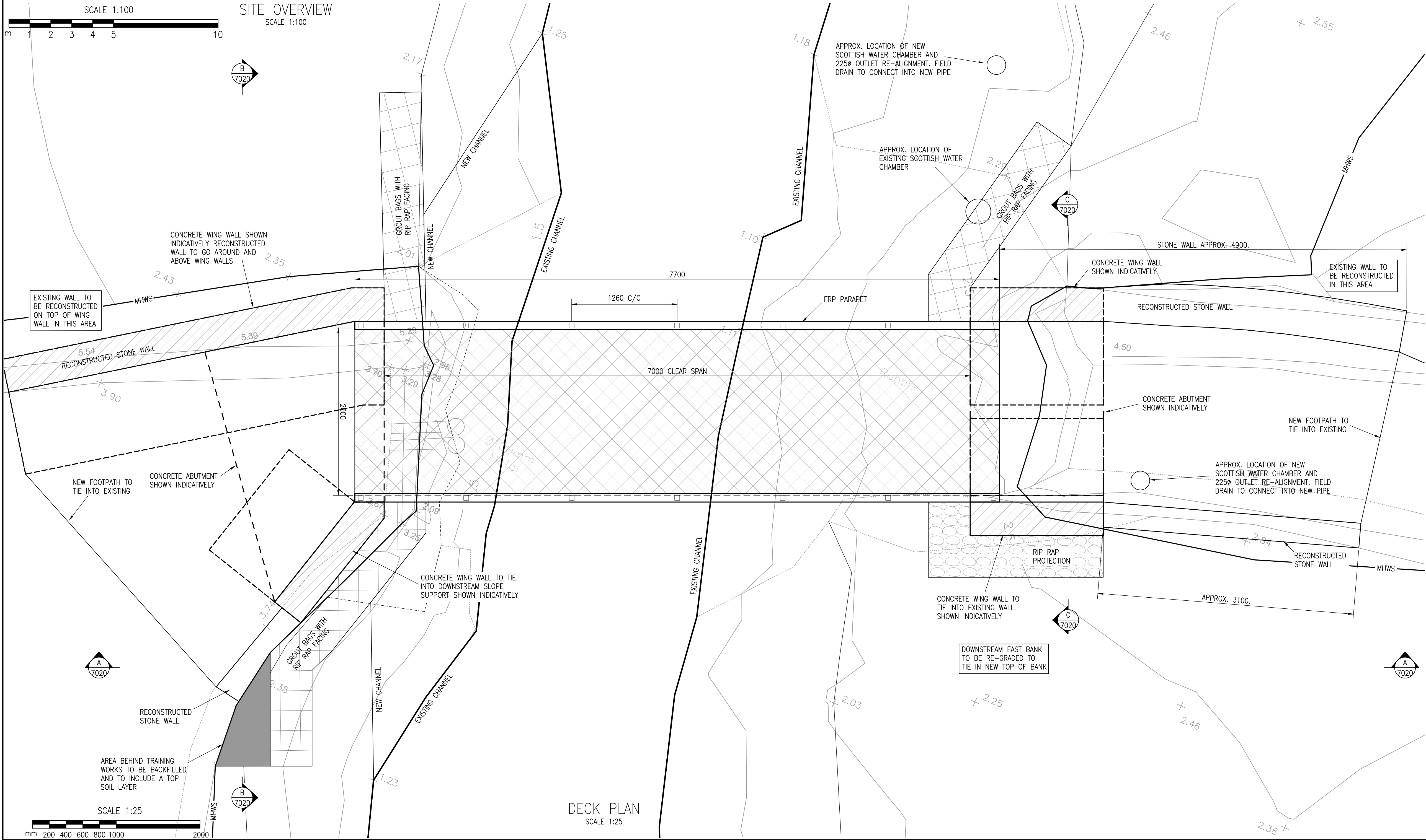

Do not scale from this drawing.		
SAFETY HEALTH AND ENVIRONMENTAL INFORMATION		
IN ADDITION TO THE HAZARD/RISKS NORMALLY ASSOCIATED WITH THE TYPES OF WORK DETAILED ON THIS DRAWING, NOTE THE FOLLOWING RISKS AND INFORMATION.		
RISKS LISTED HERE ARE NOT EXHAUSTIVE. REFER TO DESIGN ASSESSMENT FORM NO.		
CONSTRUCTION		
DEMOLITION		
FOR INFORMATION RELATING TO USE, CLEANING AND MAINTENANCE SEE THE HEALTH AND SAFETY FILE		
IT IS ASSUMED THAT ALL WORKS WILL BE CARRIED OUT BY A COMPETENT CONTRACTOR WORKING, WHERE APPROPRIATE, TO AN APPROVED METHOD STATEMENT.		

- NOTES:
1. ALL DIMENSIONS ARE SHOWN IN MILLIMETERS.
 2. MASS FOUNDATIONS TO BE BEDDED ON BED ROCK.
 3. ABUTMENT DETAIL - INDICATIVE MASS CONCRETE FACED IN RANDOM RUBBLE SANDSTONE TO MATCH EXISTING AESTHETICS IN ACCORDANCE WITH THE LIME CENTRE SPECIFICATIONS. MORTAR SHALL BE IN ACCORDANCE WITH THE LIME CENTRE SPECIFICATION.
 4. MATERIALS - DECK TO BE MADE FROM FIBRE REINFORCED POLYMER (FRP) WITH FRP PARAPETS BOLTED TO FRP DECK WITH STAINLESS STEEL BOLTS.
 5. AREA OF BOUNDARY WALL TO NORTH EAST AND NORTH WEST OF STRUCTURE TO BE CUT BACK TO END OF FOOTBRIDGE. THIS WILL BE FINISHED AND REBUILT AS REQUIRED IN EXISTING MATERIAL.
 6. SLOPE TO DOWNSTREAM WEST AREA TO BE STABILISED AND WING WALL TIED IN TO THIS.
 7. WATERCOURSE PROTECTION SYSTEMS SHALL BE IN PLACE BEFORE ANY WORKS COMMENCE TO PREVENT DEBRIS FROM ENTERING THE WATERCOURSE.
 8. MLWS IS NOT SHOWN AS THIS IS OUT WITH THE HARBOUR AREA AND DOES NOT AFFECT THIS SITE.
 9. OVERPUMPING OF DOUR BURN WILL BE IN PLACE FOR DURATION OF CONSTRUCTION.
 10. PUMPS BEING UTILISED ON SITE MUST MEET REQUIREMENTS OF CURRENT FLOW. TO BE DETERMINED BY THE CONTRACTOR.
 11. RIVER FLOWS / VOLUME ARE NOTED AS:
 - 12.

DAILY MEAN FLOW			FLOOD FLOWS	
Q...	PERCENTAGE OF TIME FLOW IS EXCEEDED	FLOW (L/s)	RETURN PERIOD (YEARS)	PEAK FLOW (m³/s)
Q5	5%	422	1 IN 2	4.9
Q10	10%	282	1 IN 5	6.9
Q20	20%	180	1 IN 10	8.2
Q30	30%	134	1 IN 30	10.5
Q40	40%	107	1 IN 50	11.9
Q50	50%	87	1 IN 75	12.9
Q60	60%	71	1 IN 100	13.7
Q70	70%	56	1 IN 200	15.8
Q80	80%	43	1 IN 500	19.2
Q90	90%	31	1 IN 1000	22.6
Q95	95%	25		
Q99	99%	18		

This plan is based on the Ordnance Survey map with the permission of the controller of Her Majesty's Stationary Office. Crown Copyright. Unauthorised reproduction infringes Crown Copyright and may lead to prosecution or civil proceedings.

16/07/21

MHWS ADDED. NOTES REVISED

Rev.

Date

Description

Client:

FAIRHURST

225 Bath Street
GLASGOW
G2 4EZ

Tel: 0141 204 8800
Fax: 0141 204 8801

GAM

SRB

JC

Drwn.

Chkd.

Appd.

Fife

COUNCIL

Project Title:
ABERDOUR FOOTBRIDGE

Drawing Title:
FOOTBRIDGE LAYOUT

Scale at A1: AS SHOWN		Status: FOR APPROVAL	
Drawn: GAM	Checked: SB	Approved: JC	
Date: 29-07-2021	Date: 29-07-2021	Date: 29-07-2021	
Drawing No.: 142009/1000			Revision: A

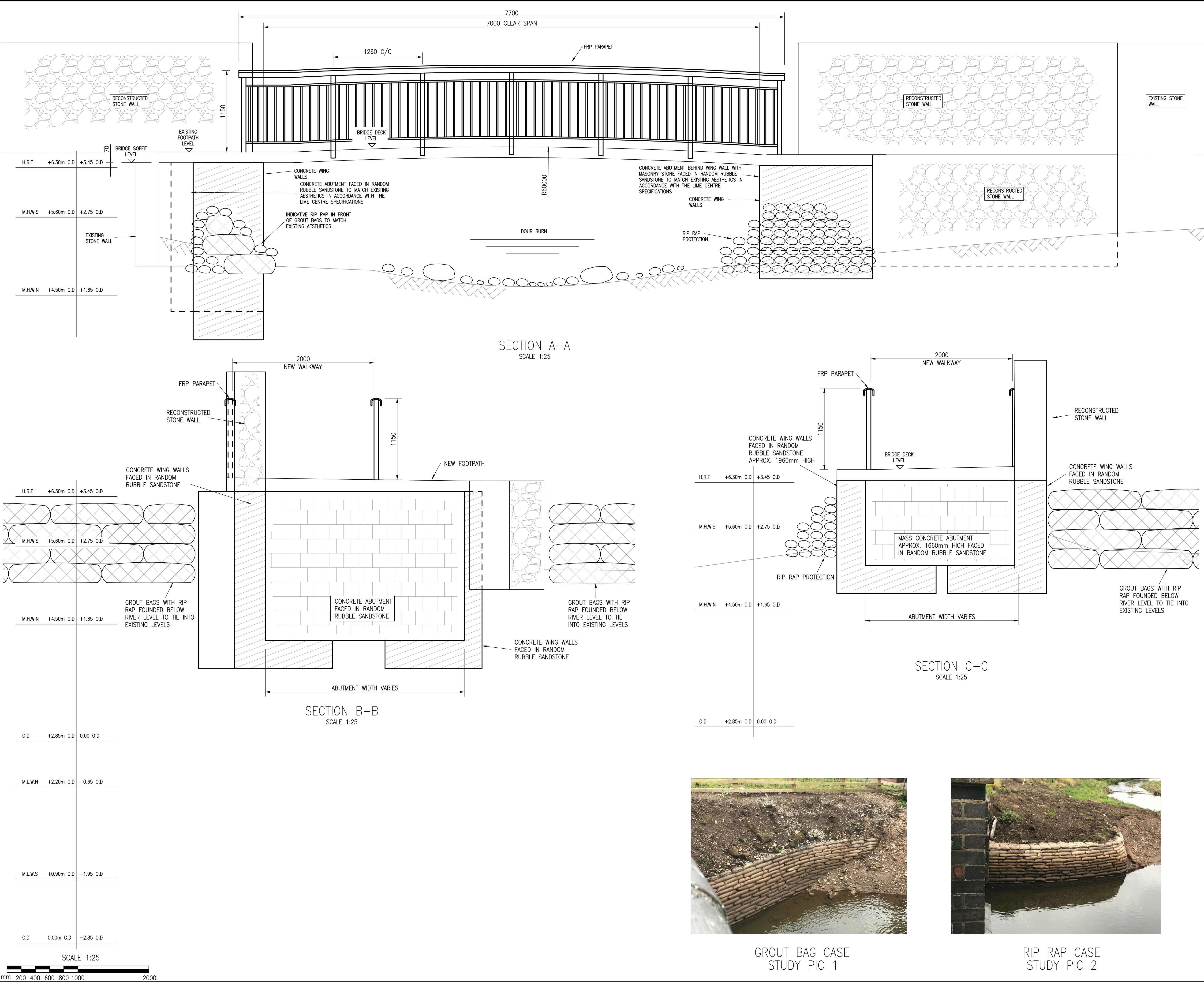

Do not scale from this drawing.

SAFETY HEALTH AND ENVIRONMENTAL INFORMATION

IN ADDITION TO THE HAZARD/RISKS NORMALLY ASSOCIATED WITH THE TYPES OF WORK DETAILED ON THIS DRAWING, NOTE THE FOLLOWING RISKS AND INFORMATION.

RISKS LISTED HERE ARE NOT EXHAUSTIVE. REFER TO DESIGN ASSESSMENT FORM NO.

CONSTRUCTION

DEMOLITION

FOR INFORMATION RELATING TO USE, CLEANING AND MAINTENANCE SEE THE HEALTH AND SAFETY FILE

IT IS ASSUMED THAT ALL WORKS WILL BE CARRIED OUT BY A COMPETENT CONTRACTOR WORKING, WHERE APPROPRIATE, TO AN APPROVED METHOD STATEMENT.

NOTES:

1. ALL DIMENSIONS ARE SHOWN IN MILLIMETERS.
2. MASS FOUNDATIONS TO BE BEDDED ON BED ROCK.
3. ABUTMENT DETAIL - INDICATIVE MASS CONCRETE FACED IN RANDOM RUBBLE SANDSTONE TO MATCH EXISTING AESTHETICS IN ACCORDANCE WITH THE LIME CENTRE SPECIFICATIONS.
4. MORTAR SHALL BE IN ACCORDANCE WITH THE LIME CENTRE SPECIFICATION.
5. MATERIALS - DECK TO BE MADE FROM FIBRE REINFORCED POLYMER (FRP) WITH FRP PARAPETS BOLTED TO FRP DECK WITH STAINLESS STEEL BOLTS.
6. AREA OF BOUNDARY WALL TO NORTH EAST AND NORTH WEST OF STRUCTURE TO BE CUT BACK TO END OF FOOTBRIDGE. THIS WILL BE FINISHED AND REBUILT AS REQUIRED IN EXISTING MATERIAL.
7. SLOPE TO DOWNSTREAM WEST AREA TO BE STABILISED AND WING WALL TIED IN TO THIS.
8. WATERCOURSE PROTECTION SYSTEMS SHALL BE IN PLACE BEFORE ANY WORKS COMMENCE TO PREVENT DEBRIS FROM ENTERING THE WATERCOURSE.
9. MLWS IS NOT SHOWN AS THIS IS OUT WITH THE HARBOUR AREA AND DOES NOT AFFECT THIS SITE.
10. OVERPUMPING OF DOUR BURN WILL BE IN PLACE FOR DURATION OF CONSTRUCTION.
11. PUMPS BEING UTILISED ON SITE MUST MEET REQUIREMENTS OF CURRENT FLOW. TO BE DETERMINED BY THE CONTRACTOR.
12. THE TIDE BAR WAS PRODUCED WITH THE AID OF EXTRACTS FROM ADMIRALTY TIDE TABLES AND USING BURNTISLAND AS THE CLOSEST REFERENCE POINT.

This plan is based on the Ordnance Survey map with the permission of the controller of Her Majesty's Stationary Office. Crown Copyright. Unauthorised reproduction infringes Crown Copyright and may lead to prosecution or civil proceedings.

2	16/10/21	HRT ADDED TO SECTIONS.	GAM	SRB	JC
A	16/10/21	MHWS ADDED. NOTES REVISED.	GAM	SRB	JC
Rev.	Date	Description	Dwn.	Chkd.	Appd.

Client:

FAIRHURST

225 Bath Street
GLASGOW
G2 4GZ

Tel: 0141 204 8800
Fax: 0141 204 8801

Fife
COUNCIL

Project Title:

ABERDOUR FOOTBRIDGE

Drawing Title:

FOOTBRIDGE SECTIONS
SHOWING ARCHED BRIDGE

Scale at A1:	Status:	
AS SHOWN	FOR APPROVAL	
Drawn:	Checked:	Approved:
GAM	SB	JC
Date:	Date:	Date:
29-07-2021	29-07-2021	29-07-2021
Drawing No.:	Revision:	
142009/1010	A	