



Scapa Deep Water Quay Environmental Impact Assessment Report: All Drawings



Note: The above image is indicative and provided for information purposes only

JULY 2023

SCAPA DEEP WATER QUAY EIAR

Volume 2: Contents of Figures

Drawing No. 202042/EIA- 110	Overall Site Layout – All Proposed Phases
Drawing No. 202042/EIA- 300	Site Access Road Layout
Drawing No. 20242/EIA- 400	Phase 1 Overall Layout
Drawing No. 202042/EIA- 401	Phase 1 Detailed Site Entrance Layout
Drawing No. 202042/IA- 500	Phase 2 Overall Layout
Drawing No. 202042/EIA- 600	Dredging – All Options
Figure 1	Landscape Context
Figure 2	Planning Policy Context
Figure 3	Landscape and Coastal Character
Figure 4	Topographical Context
Figure 4.1 Drawing No. 674795-GIS146	Hydrological Overview
Figure 5	ZTV and Representative Viewpoint Locations
Figure 7	Detailed ZTV and Residential Locations
Figure Showing Section Lines 1 2 & 3	

Chart Datum (Scapa Flow)	Ordnance Datum (Newlyn)	Quay Heights and Tide Data Scapa Deep Water Quay
+7.00m	+5.31m	Quay Edge Level
+3.60m	+1.91m	Mean High Water Spring Tides
+1.69m	0.00m	Ordnance Datum (Newlyn)
+0.70m	-0.99m	Mean Low Water Spring Tides
0.00m	-1.69m	Chart Datum (Scapa Flow)
-5.00m	-6.69m	
-10.00m	-11.69m	
-15.00m	-16.69m	
-20.00m	-21.69m	

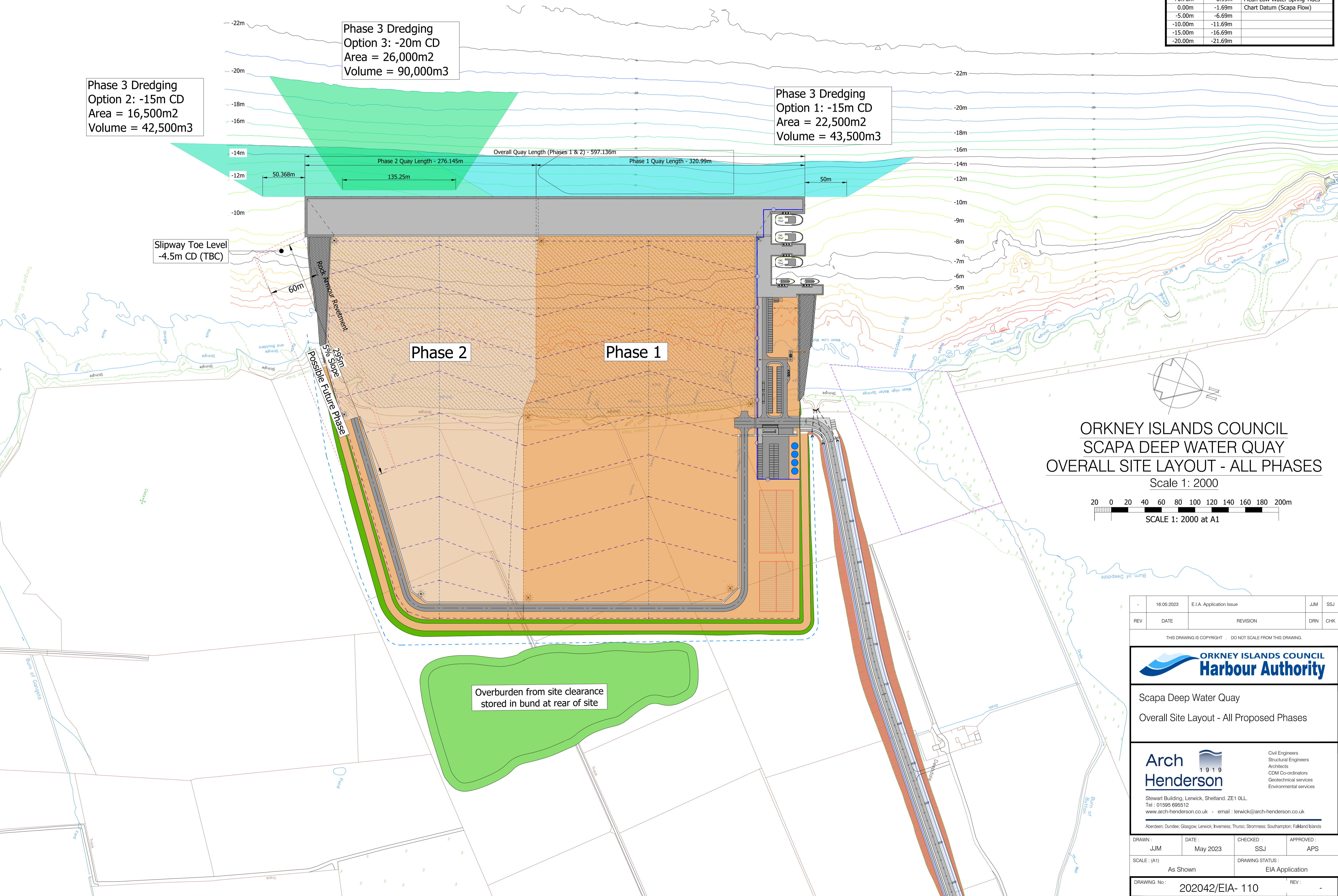

ORKNEY ISLANDS COUNCIL
SCAPA DEEP WATER QUAY
OVERALL SITE LAYOUT - ALL PHASES

Scale 1: 2000
20 0 20 40 60 80 100 120 140 160 180 200m
SCALE 1: 2000 at A1

REV	DATE	REVISION	DRN	CHK
-	16.05.2023	E.I.A. Application Issue	JJM	SSJ

THIS DRAWING IS COPYRIGHT. DO NOT SCALE FROM THIS DRAWING.



Scapa Deep Water Quay
Overall Site Layout - All Proposed Phases

Arch Henderson 1919
Civil Engineers
Structural Engineers
Architects
CDM Co-ordinators
Geotechnical services
Environmental services
Stewart Building, Lerwick, Shetland, ZE1 0LL.
Tel: 01595 695512
www.arch-henderson.co.uk - email: lerwick@arch-henderson.co.uk
Aberdeen, Dundee, Glasgow, Lerwick, Inverness, Thurso, Stromness, Southampton, Falkland Islands

DRAWN	DATE	CHECKED	APPROVED
JJM	May 2023	SSJ	APS

SCALE: (A1) As Shown
DRAWING STATUS: EIA Application

DRAWING No: 202042/EIA- 110
REV: -

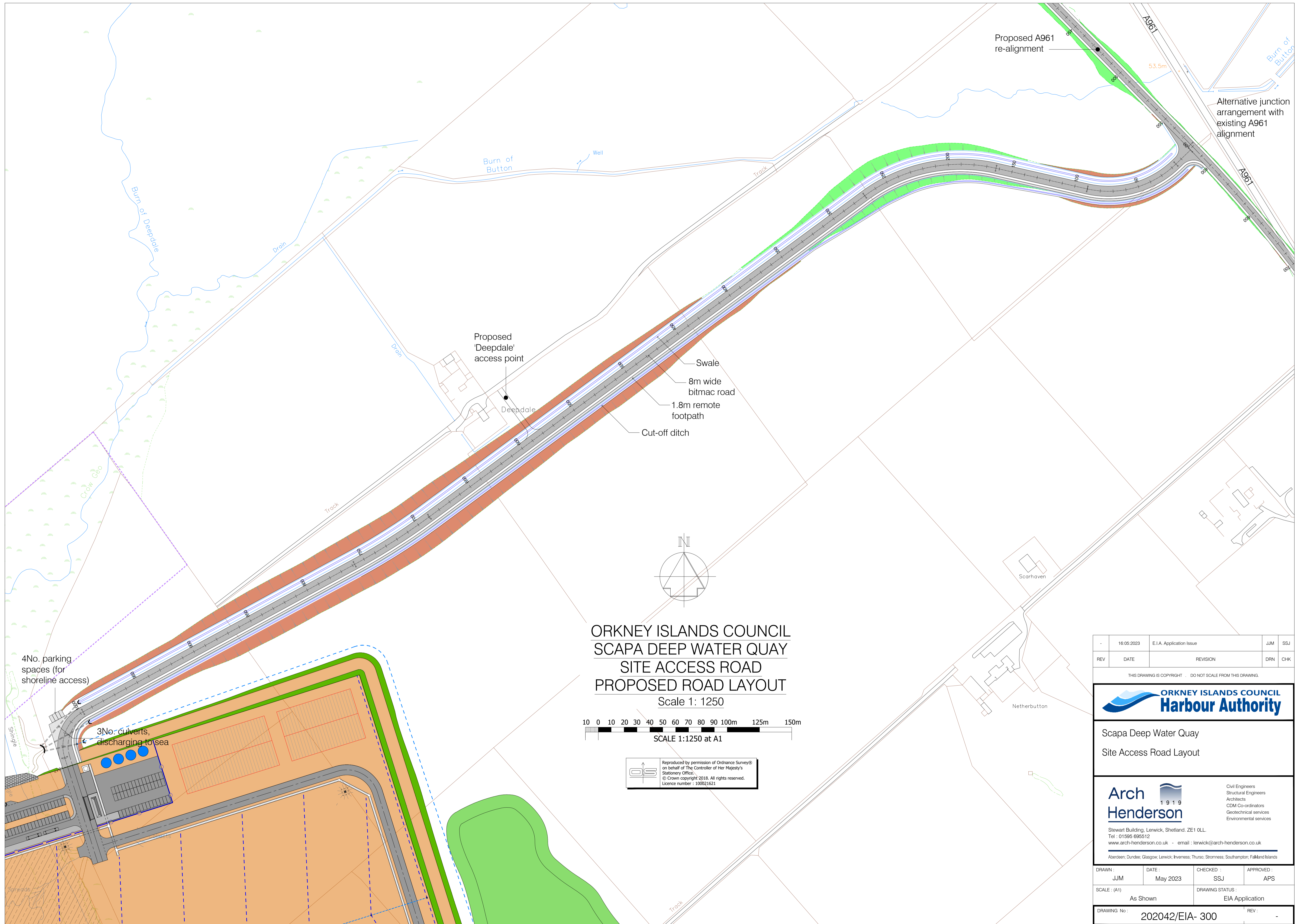

ORKNEY ISLANDS COUNCIL
 SCAPA DEEP WATER QUAY
 SITE ACCESS ROAD
 PROPOSED ROAD LAYOUT
 Scale 1: 1250

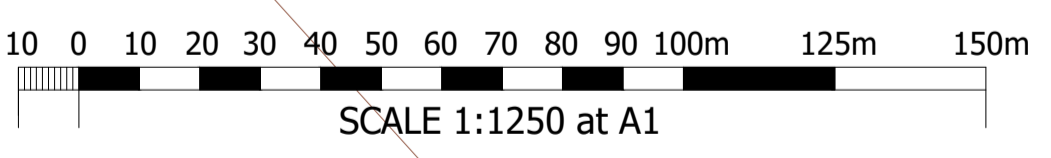

Reproduced by permission of Ordnance Survey
 on behalf of The Controller of Her Majesty's
 Stationery Office.
 © Crown copyright 2018. All rights reserved.
 Licence number - 100021621

REV	DATE	REVISION	DRN	CHK
-	16.05.2023	E.I.A. Application Issue	JJM	SSJ

THIS DRAWING IS COPYRIGHT . DO NOT SCALE FROM THIS DRAWING.



Scapa Deep Water Quay
 Site Access Road Layout

Arch Henderson 1919
 Civil Engineers
 Structural Engineers
 Architects
 CDM Co-ordinators
 Geotechnical services
 Environmental services

Stewart Building, Lerwick, Shetland, ZE1 0LL.
 Tel : 01595 695512
 www.arch-henderson.co.uk - email : lerwick@arch-henderson.co.uk

Aberdeen, Dundee, Glasgow, Lerwick, Inverness, Thurso, Stromness, Southampton, Falkland Islands

DRAWN :	DATE :	CHECKED :	APPROVED :
JJM	May 2023	SSJ	APS

SCALE : (A1)	DRAWING STATUS :
As Shown	EIA Application

DRAWING No : 202042/EIA- 300 REV : -

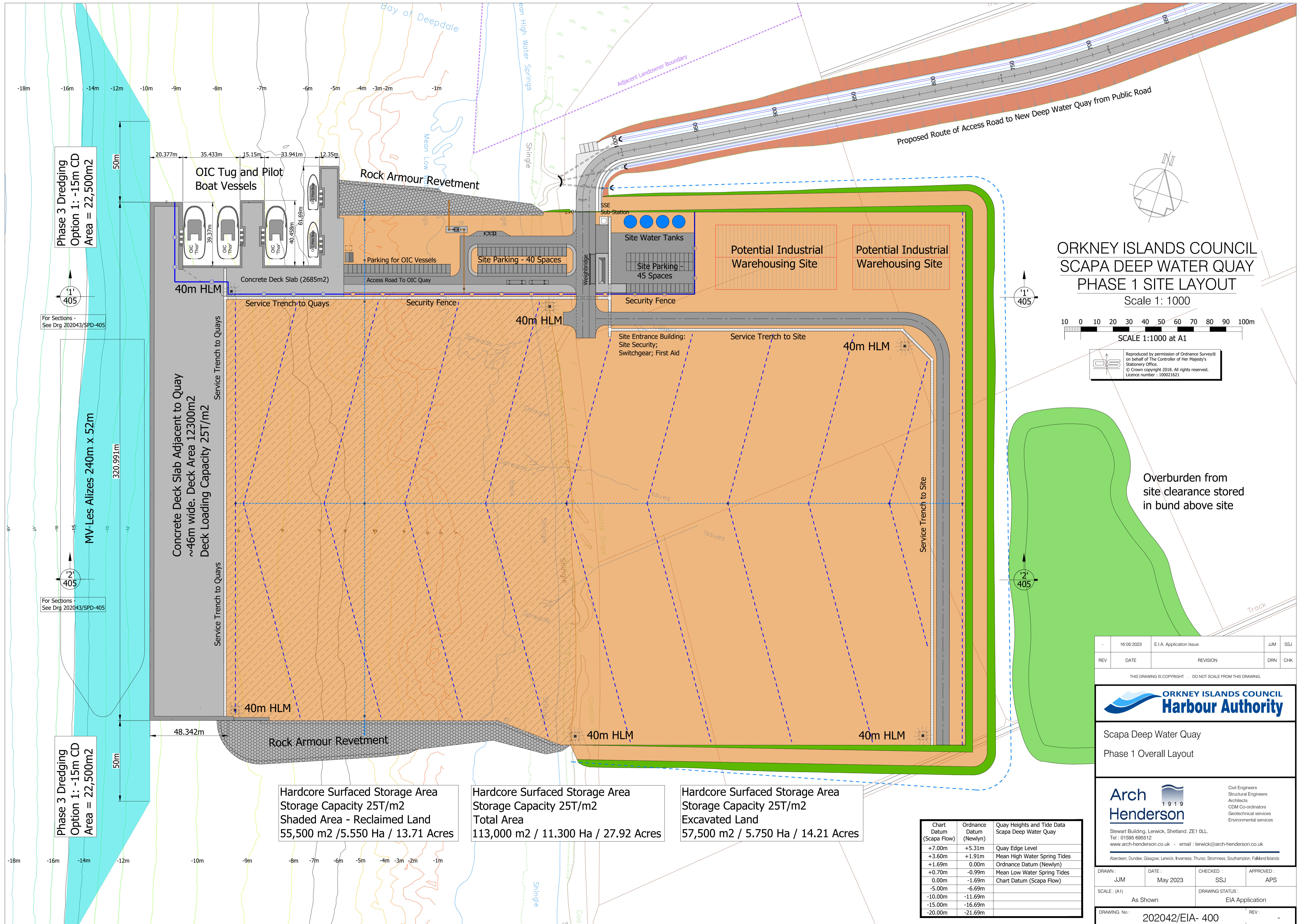

Phase 3 Dredging
Option 1: -15m CD
Area = 22,500m²

MV Les Alizes 240m x 52m
320,991m²

Phase 3 Dredging
Option 1: -15m CD
Area = 22,500m²

OIC Tug and Pilot
Boat Vessels

Rock Armour Revetment

Site Water Tanks

Potential Industrial
Warehousing Site

Potential Industrial
Warehousing Site

Concrete Deck Slab Adjacent to Quay
~46m wide, Deck Area 12300m²
Deck Loading Capacity 25T/m²

Site Parking - 40 Spaces

Site Entrance Building:
Site Security;
Switchgear; First Aid

Overburden from
site clearance stored
in bund above site

Hardcore Surfaced Storage Area
Storage Capacity 25T/m²
Shaded Area - Reclaimed Land
55,500 m² / 5.550 Ha / 13.71 Acres

Hardcore Surfaced Storage Area
Storage Capacity 25T/m²
Total Area
113,000 m² / 11.300 Ha / 27.92 Acres

Hardcore Surfaced Storage Area
Storage Capacity 25T/m²
Excavated Land
57,500 m² / 5.750 Ha / 14.21 Acres

ORKNEY ISLANDS COUNCIL
SCAPA DEEP WATER QUAY
PHASE 1 SITE LAYOUT

Scale 1: 1000

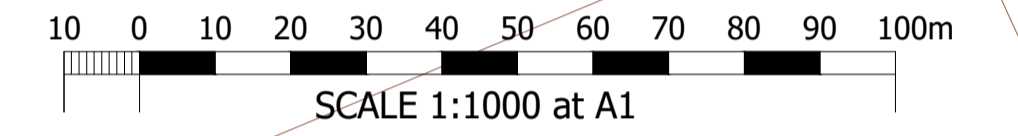

Reproduced by permission of Ordnance Survey®
on behalf of The Controller of Her Majesty's
Stationery Office.
© Crown copyright 2018. All rights reserved.
Licence number : 100021621

REV	DATE	REVISION	DRN	CHK
-	16.05.2023	E.I.A. Application Issue	JJM	SSJ

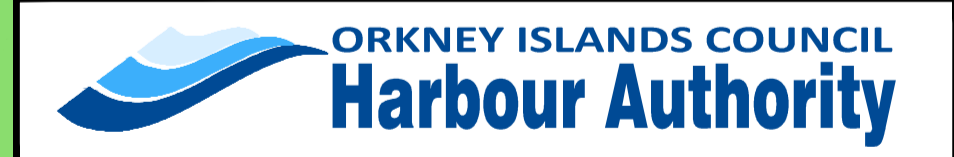

Scapa Deep Water Quay
Phase 1 Overall Layout



Stewart Building, Lerwick, Shetland, ZE1 0LL.
Tel : 01595 695512
www.arch-henderson.co.uk - email : lerwick@arch-henderson.co.uk

DRAWN:	DATE:	CHECKED:	APPROVED:
JJM	May 2023	SSJ	APS

SCALE: (A1) As Shown DRAWING STATUS: EIA Application

DRAWING No: 202042/EIA- 400 REV: -

Chart Datum (Scapa Flow)	Ordnance Datum (Newlyn)	Quay Heights and Tide Data Scapa Deep Water Quay
+7.00m	+5.31m	Quay Edge Level
+3.60m	+1.91m	Mean High Water Spring Tides
+1.69m	0.00m	Ordnance Datum (Newlyn)
+0.70m	-0.99m	Mean Low Water Spring Tides
0.00m	-1.69m	Chart Datum (Scapa Flow)
-5.00m	-6.69m	
-10.00m	-11.69m	
-15.00m	-16.69m	
-20.00m	-21.69m	

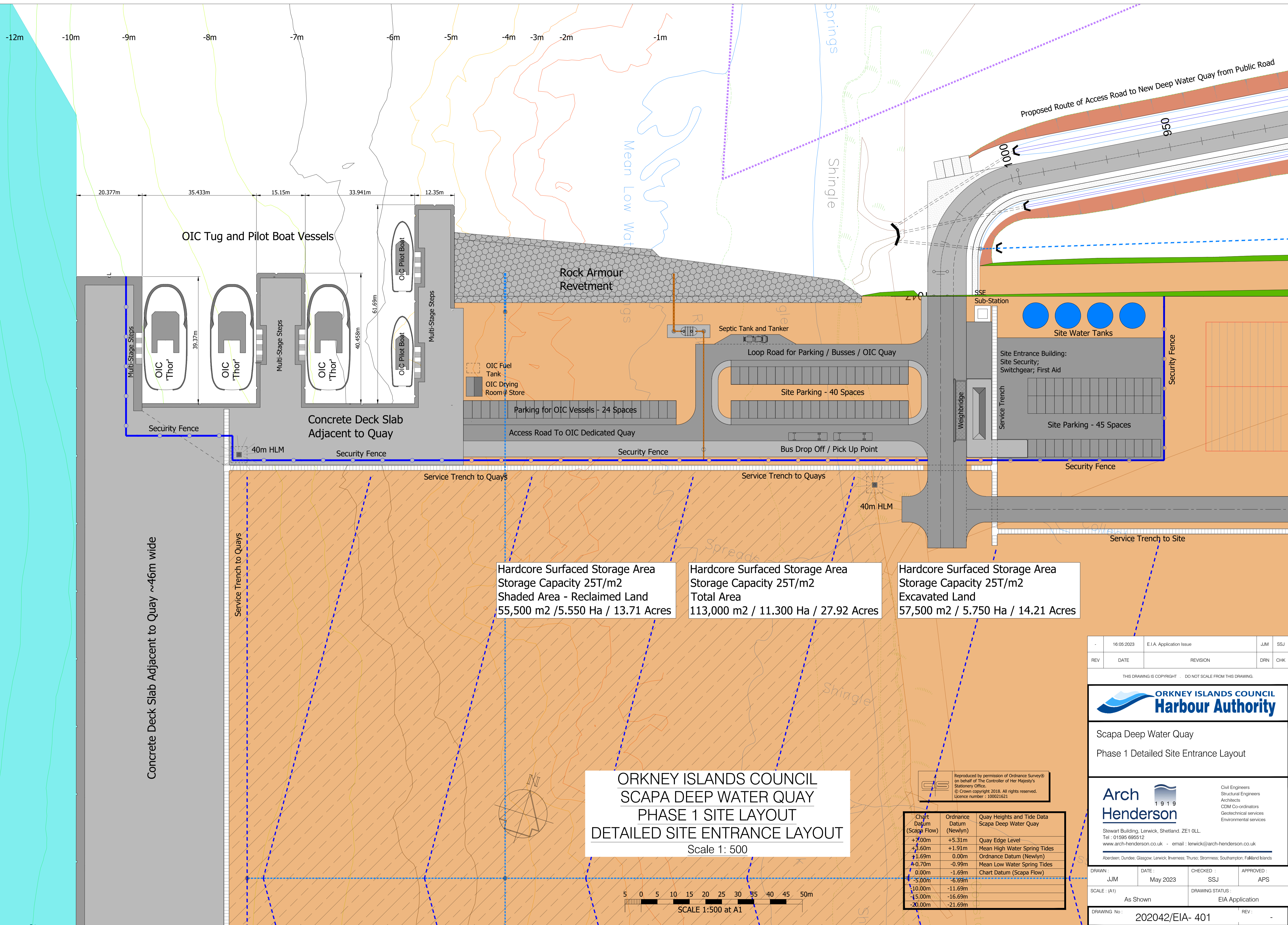

OIC Tug and Pilot Boat Vessels

Rock Armour Revetment

Septic Tank and Tanker

Loop Road for Parking / Busses / OIC Quay

Site Parking - 40 Spaces

Site Water Tanks

Site Entrance Building:
Site Security;
Switchgear; First Aid

Site Parking - 45 Spaces

Concrete Deck Slab Adjacent to Quay ~46m wide

Hardcore Surfaced Storage Area
Storage Capacity 25T/m2
Shaded Area - Reclaimed Land
55,500 m2 / 5.550 Ha / 13.71 Acres

Hardcore Surfaced Storage Area
Storage Capacity 25T/m2
Total Area
113,000 m2 / 11.300 Ha / 27.92 Acres

Hardcore Surfaced Storage Area
Storage Capacity 25T/m2
Excavated Land
57,500 m2 / 5.750 Ha / 14.21 Acres

ORKNEY ISLANDS COUNCIL
SCAPA DEEP WATER QUAY
PHASE 1 SITE LAYOUT
DETAILED SITE ENTRANCE LAYOUT
Scale 1: 500

Reproduced by permission of Ordnance Survey® on behalf of The Controller of Her Majesty's Stationery Office.
© Crown copyright 2018. All rights reserved.
Licence number : 100021621

Chart Datum (Scapa Flow)	Ordnance Datum (Newlyn)	Quay Heights and Tide Data Scapa Deep Water Quay
+7.00m	+5.31m	Quay Edge Level
+3.60m	+1.91m	Mean High Water Spring Tides
+1.69m	0.00m	Ordnance Datum (Newlyn)
-0.70m	-0.99m	Mean Low Water Spring Tides
0.00m	-1.69m	Chart Datum (Scapa Flow)
-5.00m	-6.69m	
-10.00m	-11.69m	
-15.00m	-16.69m	
-20.00m	-21.69m	

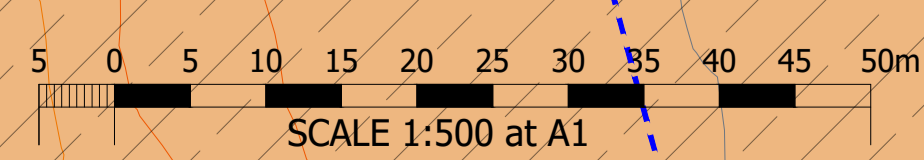

REV	DATE	REVISION	DRN	CHK
-	16.05.2023	E.I.A. Application Issue	JJM	SSJ



Scapa Deep Water Quay
Phase 1 Detailed Site Entrance Layout

Arch Henderson 1919

Civil Engineers
Structural Engineers
Architects
CDM Co-ordinators
Geotechnical services
Environmental services

Stewart Building, Lerwick, Shetland, ZE1 0LL.
Tel : 01595 695512
www.arch-henderson.co.uk - email : lerwick@arch-henderson.co.uk

Aberdeen, Dundee, Glasgow, Lerwick, Inverness, Thurso, Stromness, Southampton, Falkland Islands

DRAWN	DATE	CHECKED	APPROVED
JJM	May 2023	SSJ	APS

SCALE: (A1)
As Shown

DRAWING STATUS:
EIA Application

DRAWING No: 202042/EIA- 401

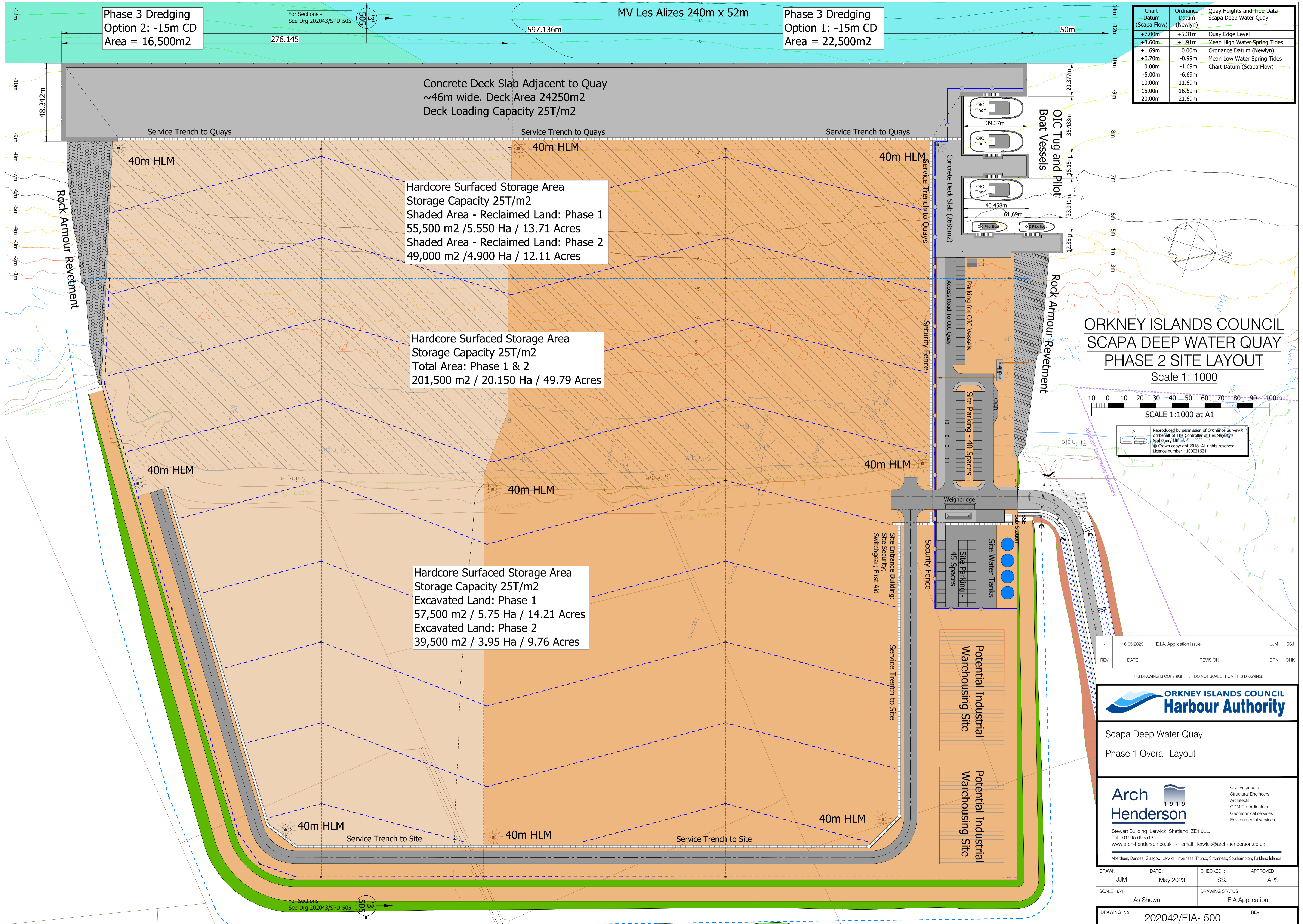

Phase 3 Dredging
Option 2: -15m CD
Area = 16,500m²

For Sections -
See Drg 202043/SPD-505

MV Les Alizes 240m x 52m

Phase 3 Dredging
Option 1: -15m CD
Area = 22,500m²

Chart Datum (Scapa Flow)	Ordnance Datum (Newlyn)	Quay Heights and Tide Data - Scapa Deep Water Quay
+7.00m	+5.31m	Quay Edge Level
+3.60m	+1.91m	Mean High Water Spring Tides
+1.69m	0.00m	Ordnance Datum (Newlyn)
+0.70m	-0.99m	Mean Low Water Spring Tides
0.00m	-1.69m	Chart Datum (Scapa Flow)
-5.00m	-6.69m	
-10.00m	-11.69m	
-15.00m	-16.69m	
-20.00m	-21.69m	

Concrete Deck Slab Adjacent to Quay
~46m wide. Deck Area 24250m²
Deck Loading Capacity 25T/m²

Hardcore Surfaced Storage Area
Storage Capacity 25T/m²
Shaded Area - Reclaimed Land: Phase 1
55,500 m² / 5.550 Ha / 13.71 Acres
Shaded Area - Reclaimed Land: Phase 2
49,000 m² / 4.900 Ha / 12.11 Acres

Hardcore Surfaced Storage Area
Storage Capacity 25T/m²
Total Area: Phase 1 & 2
201,500 m² / 20.150 Ha / 49.79 Acres

Hardcore Surfaced Storage Area
Storage Capacity 25T/m²
Excavated Land: Phase 1
57,500 m² / 5.75 Ha / 14.21 Acres
Excavated Land: Phase 2
39,500 m² / 3.95 Ha / 9.76 Acres

ORKNEY ISLANDS COUNCIL
SCAPA DEEP WATER QUAY
PHASE 2 SITE LAYOUT
Scale 1: 1000

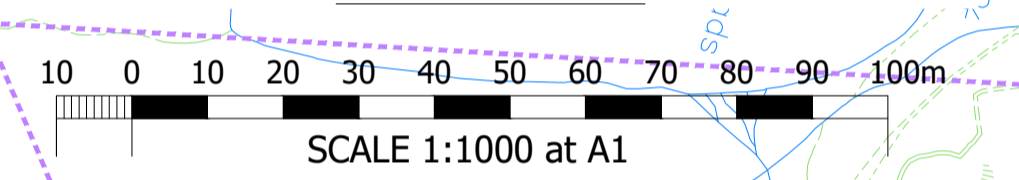

Reproduced by permission of Ordnance Survey on behalf of The Controller of Her Majesty's Stationery Office.
© Crown copyright 2018. All rights reserved.
Licence number: 100021621

REV	DATE	REVISION	DRN	CHK
-	16.05.2023	E.I.A. Application Issue	JJM	SSJ

THIS DRAWING IS COPYRIGHT. DO NOT SCALE FROM THIS DRAWING.



Scapa Deep Water Quay
Phase 1 Overall Layout

Arch Henderson 1919
Civil Engineers
Structural Engineers
Architects
CDM Co-ordinators
Geotechnical services
Environmental services
Stewart Building, Lerwick, Shetland, ZE1 0LL
Tel: 01595 695512
www.arch-henderson.co.uk - email: lerwick@arch-henderson.co.uk
Aberdeen, Dundee, Glasgow, Lerwick, Inverness, Thurso, Stromness, Southampton, Falkland Islands

DRAWN	DATE	CHECKED	APPROVED
JJM	May 2023	SSJ	APS

SCALE: (A1) As Shown DRAWING STATUS: EIA Application

DRAWING No: 202042/EIA- 500 REV: -

Chart Datum (Scapa Flow)	Ordnance Datum (Newlyn)	Quay Heights and Tide Data Scapa Deep Water Quay
+7.00m	+5.31m	Quay Edge Level
+3.60m	+1.91m	Mean High Water Spring Tides
+1.69m	0.00m	Ordnance Datum (Newlyn)
+0.70m	-0.99m	Mean Low Water Spring Tides
0.00m	-1.69m	Chart Datum (Scapa Flow)
-5.00m	-6.69m	
-10.00m	-11.69m	
-15.00m	-16.69m	
-20.00m	-21.69m	

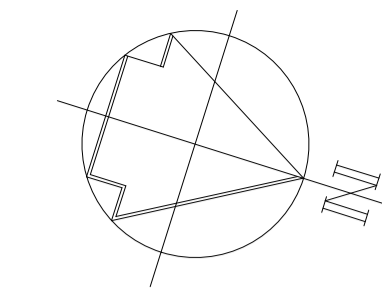

ORKNEY ISLANDS COUNCIL
SCAPA DEEP WATER QUAY
DREDGING LAYOUT - ALL OPTIONS

Scale 1: 1250

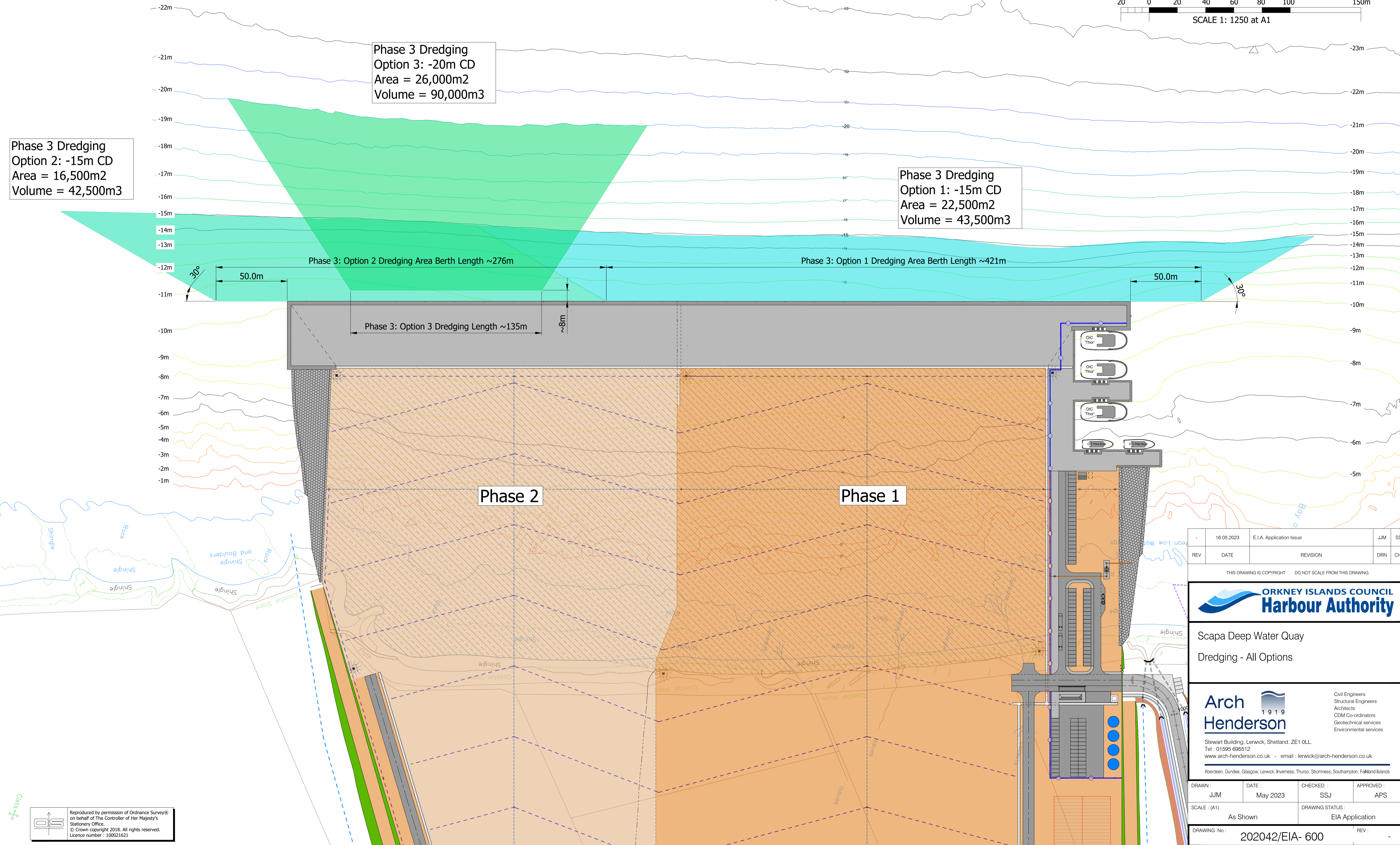
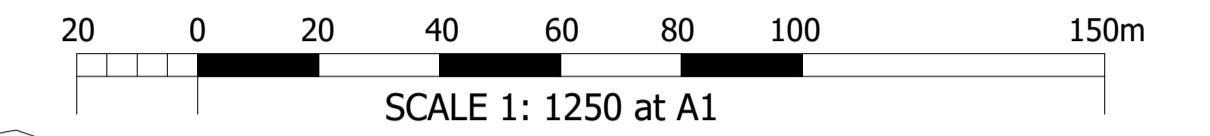

Phase 3 Dredging
Option 3: -20m CD
Area = 26,000m²
Volume = 90,000m³

Phase 3 Dredging
Option 2: -15m CD
Area = 16,500m²
Volume = 42,500m³

Phase 3 Dredging
Option 1: -15m CD
Area = 22,500m²
Volume = 43,500m³

Phase 3: Option 2 Dredging Area Berth Length ~276m

Phase 3: Option 1 Dredging Area Berth Length ~421m

Phase 3: Option 3 Dredging Length ~135m

Phase 2

Phase 1

REV	DATE	REVISION	DRN	CHK
-	16.05.2023	E.I.A. Application Issue	JJM	SSJ

THIS DRAWING IS COPYRIGHT. DO NOT SCALE FROM THIS DRAWING.



Scapa Deep Water Quay
Dredging - All Options

Arch Henderson 1919

Civil Engineers
Structural Engineers
Architects
CDM Co-ordinators
Geotechnical services
Environmental services

Stewart Building, Lerwick, Shetland, ZE1 0LL.
Tel: 01595 695512
www.arch-henderson.co.uk - email: lerwick@arch-henderson.co.uk

Aberdeen, Dundee, Glasgow, Lerwick, Inverness, Thurso, Stromness, Southampton, Falkland Islands

DRAWN: JJM	DATE: May 2023	CHECKED: SSJ	APPROVED: APS
SCALE: (A1)	As Shown	DRAWING STATUS: EIA Application	
DRAWING No: 202042/EIA- 600		REV: -	

Reproduced by permission of Ordnance Survey on behalf of The Controller of Her Majesty's Stationery Office.
© Crown copyright 2018. All rights reserved.
Licence number: 100021621

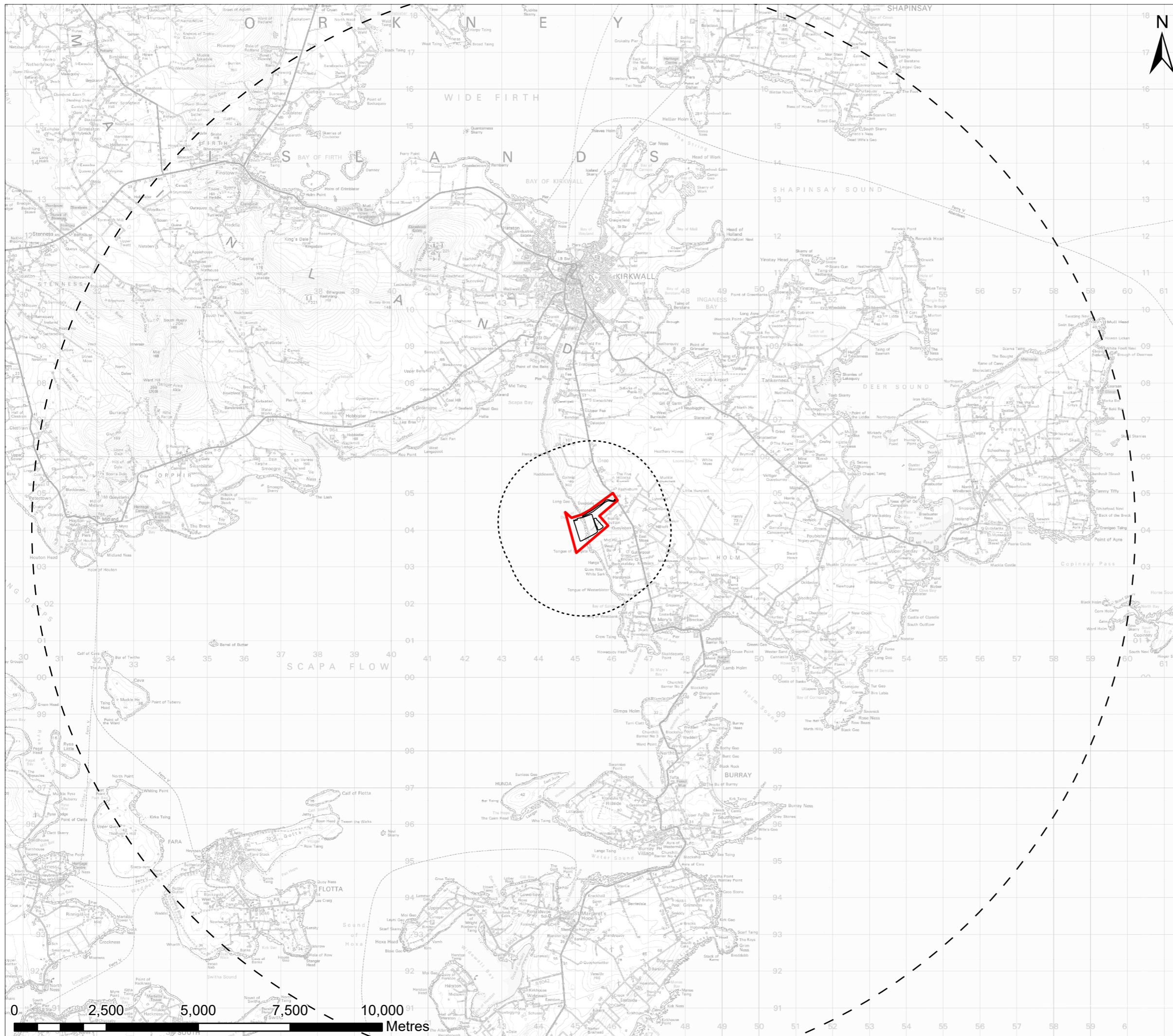

Legend

- Site boundary
- Extent of proposed quay and access road
- 2km radius residential study area
- 15km radius study area

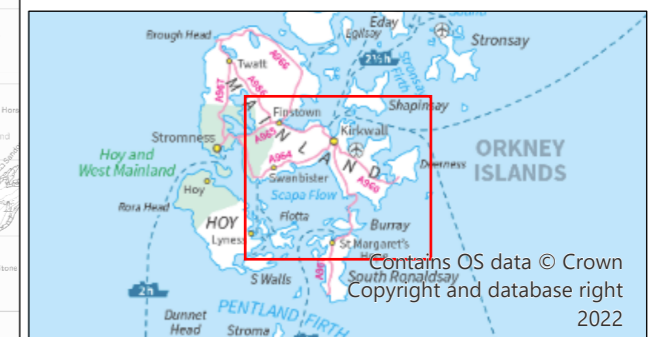

Rev	13.04.2023	FIRST ISSUE	RM	PB	BM
Rev	Date	Amendment Details	Dr'n	Chk'	App'

Sweco UK Limited
 2nd Floor Quay 2, 139 Fountainbridge
 Edinburgh, EH3 9QG
 Tel: +44 (0)131 550 6300
 www.sweco.co.uk



Client
ORKNEY ISLANDS COUNCIL HARBOUR AUTHORITY

Project Title
SCAPA DEEP WATER QUAY

Drawing Title
FIGURE 1 - LANDSCAPE CONTEXT

Sheet Size	A3	Scale	1:100,000	Sweco Ref	65208075	Revision	P01
------------	----	-------	-----------	-----------	----------	----------	-----

This drawing should not be relied on or used in circumstances other than those for which it was originally prepared and for which Sweco UK Limited was commissioned. Sweco UK Limited accepts no responsibility for this drawing to any party other than the person by whom it was commissioned. Any party which breaches the provisions of this disclaimer shall indemnify Sweco UK Limited for all loss or damage arising therefrom. COPYRIGHT © Sweco 2022

